

Key

- Original 19th century construction
- Early/mid 20th century construction
- Late 20th / early 21st century construction

NOTES:

Do not scale off this drawing.

All Trade Contractors to be responsible for taking & checking their own site dimensions. Any errors or omissions to be reported to Forge Architects and Surveyors Ltd immediately, prior to work being carried out.

All site dimensions shown are based upon the measured survey of the property carried out by independent surveyors. The accuracy of this information is not the responsibility of Forge Architects and Surveyors Ltd

Forge Architects & Surveyors Ltd also accept no responsibility for the accuracy of any Structural and Servicing information shown on this drawing. This information is shown for guidance purposes only, and where applicable - is based on information provided by the consulting Structural Engineers, consulting M&E Engineers, client representatives, and/or specialist subcontractors respectively.

Reference should always be made to Engineers & Subcontractors current drawings & specifications. This drawing and design is the copyright of Forge Architects and Surveyors Ltd and is not to be used for any purpose without their consent.

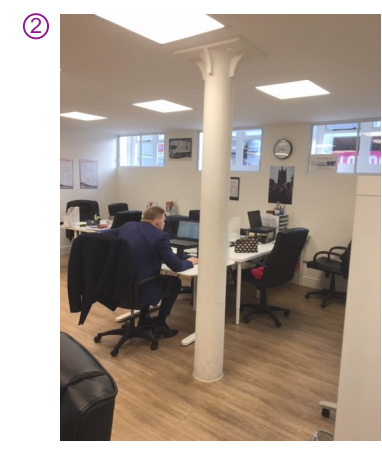
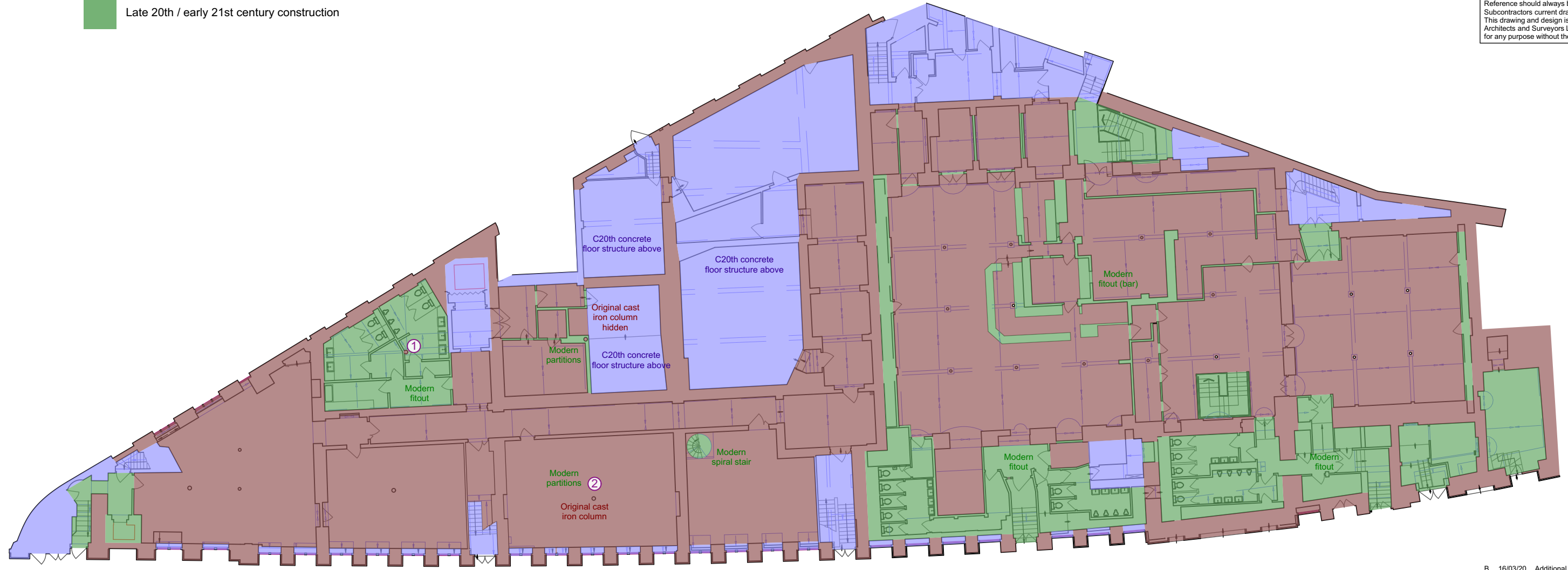

B 16/03/20 Additional information
A 06/03/20 Additional information

FORGEARCHITECTS	
6-8 Cole Street London SE1 4YH	
0207 378 7782 :T forge@forgearchitects.co.uk :E www.forgearchitects.co.uk :W	
Project: The Hop Exchange Infill	
Client: The Peer Group	
Drawing: Historical Development Plan Lower Ground Floor	
Drawing Number:	Rev:
1403_HD_02_B	
Date: Feb 2020	Scale: 1:250@A3

**HISTORICAL DEVELOPMENT PLAN
LOWER GROUND FLOOR**