



**Davies**



# Your Vision, Our Mission.

## Family run design business with 20+ years' experience.

From quirky, kooky and cool, to sophisticated luxury, we've been there and designed that. We designed Facebook's first London offices and we've designed the offices of Disney, KPMG and Adobe, too. All the while ensuring the spaces reflected the client's culture and values. But it's not just about the brands we've worked with — it's about who we are and what we stand for. We are a family run business and we treat our clients like our tribe. We believe in community, communication and inclusion through design. We also believe in optimising each space we touch; both aesthetically and functionally.

# Meet the team.

Our core team is based in Croydon in our own designed showroom. Our team includes of industry experts, a rich mix of creative individuals and an extended team of contractors and suppliers across construction, furniture and fittings.



“

**You, as our highly valued client, are at the heart of our business. Fit-outs are specifically tailored to your expectations, ensuring that we get it right at the first attempt; handing over a completed project on time and problem free.**

”

Our team members have backgrounds in architecture, furniture, interiors and graphic design, law, business and engineering, project managers, construction professionals, sales personnel and administrators. A unique blend of people who are ideally placed to support you with requirements of your project, providing innovative solutions, creativity and enjoying what they do.



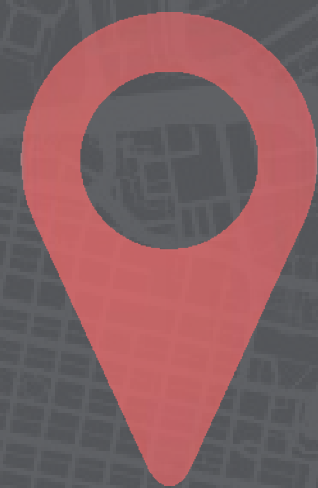

# Aims of the project.

This presentation contains a new office fit-out refurbishment proposal created by MDC Group, for Davies Group exclusively. The main aims of the projects are:

- To enhance staff productivity and work satisfaction through developing their workspace to suit their needs, as well as ensuring it is a safe place to work in the current climate.
- To improve potential clients experience with the business, by creating spaces exclusively designed to meet their needs, as well as use interior design as a tool to impress potential clients and reflect the business.



RWF House is located only minutes away from Glasgow Central train station, and approx. 5 minutes walking distance from Glasgow Queen Street Station.



RWF House can also be easily accessed via A77 road link which is directly connected to M74 and M8.

RWF House is located in the heart of Glasgow, surrounded by various bars and restaurants as well as landmarks, such as Glasgow's Gallery of Modern Art, the Lighthouse, Egyptian Halls, Glasgow Police Museum and St Andrew's in the Square.



# Proposed GA layout.

## Legend:

58 x workstations (desks 1400mm x 800mm),  
1 x fully enclosed Legal Solutions area (16pp),  
1 x boardroom (12pp),  
2 x meeting rooms (6pp and 4pp),  
1 x 1 to 1 (2pp),  
2 x quiet/focus rooms (1pp),  
1 x tea point and breakout area,  
2 x print points and cutting + 1 x binding areas,  
1 x open plan project area (4pp).

# GA Layout

2nd Floor

LEGEND:

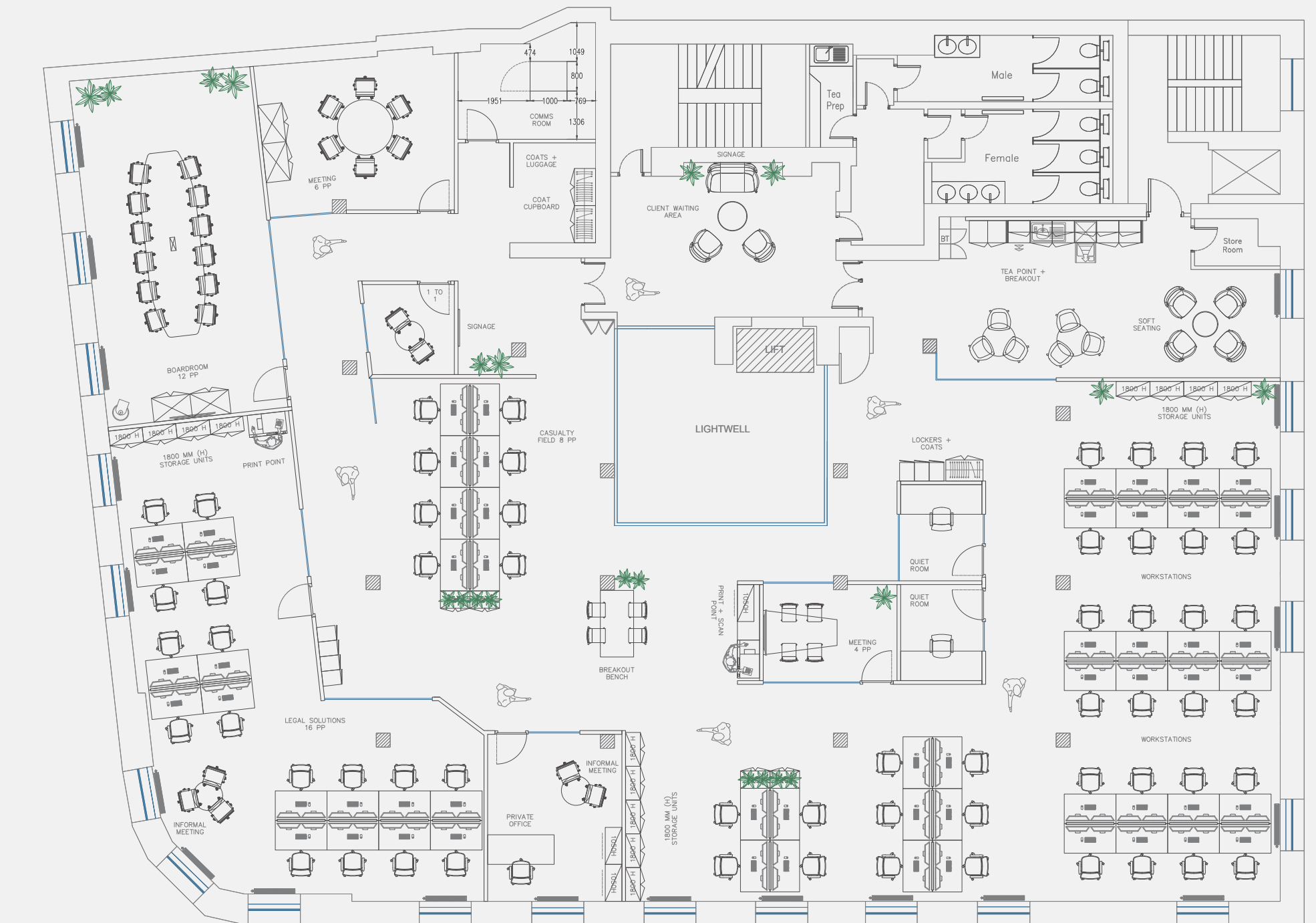
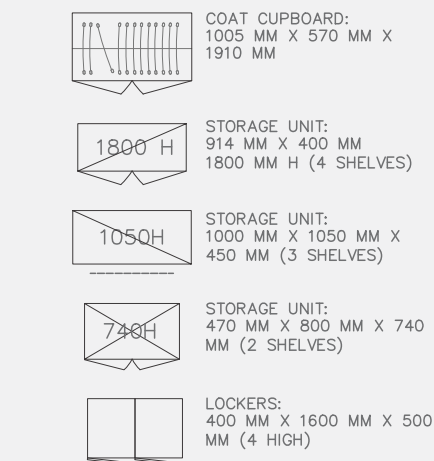

NOT TO SCALE

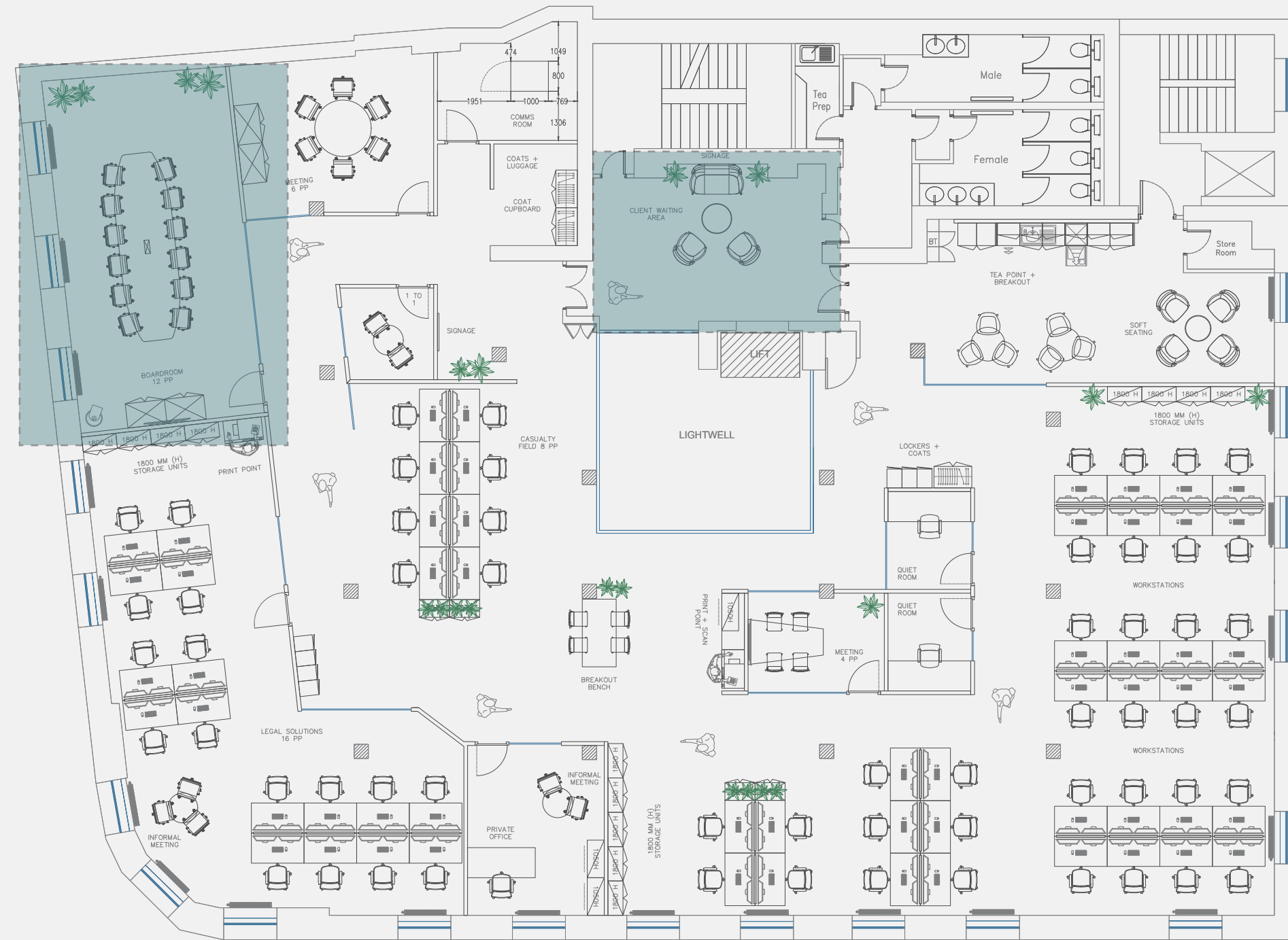

## Lobby Area.

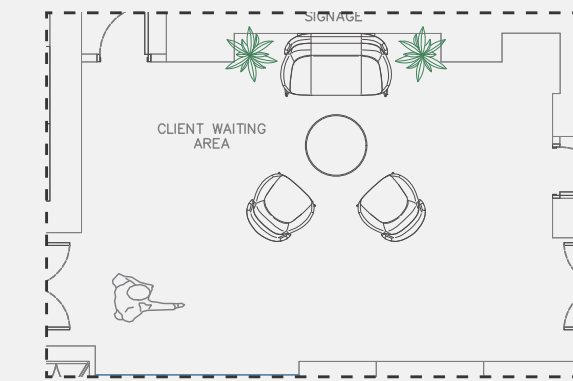

lobby area is proposed to be furnished re-using clients existing furniture, please note: **furniture dimensions are unknown and are TBC on site**

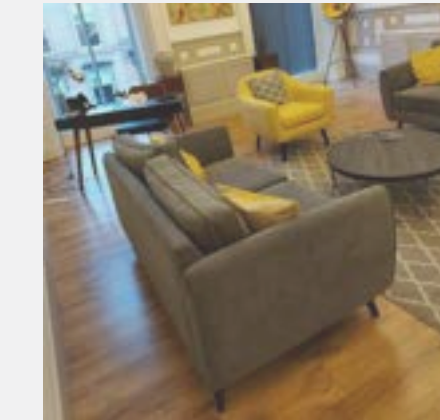

two seater sofa upholstered in grey fabric, with black stained wooden leg frame

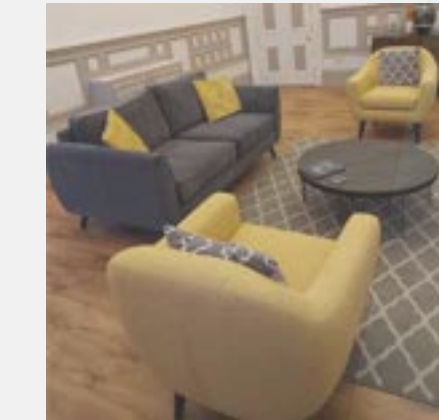
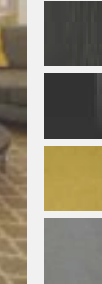

2 x single armchairs upholstered in yellow fabric and black coffee table



1850 mm wide 'Davies' signage for the lobby area and 1600 mm wide 'Davies' signage for the main entrance area, individual aluminium white powder coated non-illuminated chunky letters on 20 mm locators



## Boardroom.



5000 mm x 1500/1300 mm x 740 mm boat shape meeting boardroom table



laminate table top in black finish, 10 mm edge in oak finish and black frame

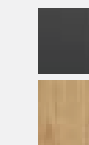

power module (2 x UK power sockets, 1 x USB and x1 HDMI connection port) in matt black



occasional chair with arms, with black frame, in black faux leather

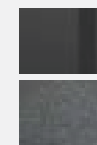

2100 mm x 650 mm x 800 mm credenza unit in MFC in oak finish, with black handles

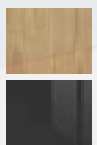

high back in boardroom only



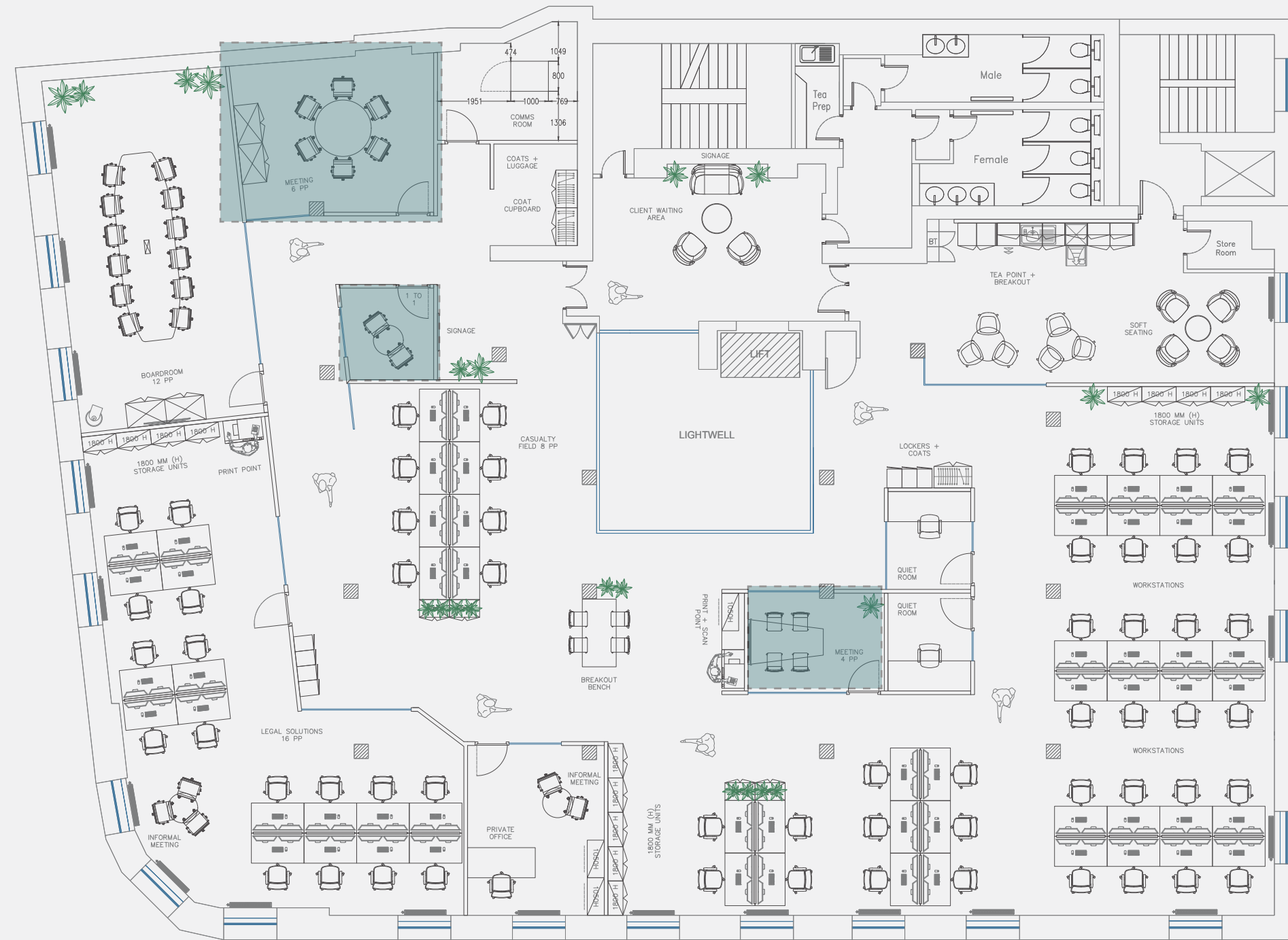

## Meeting Rooms.



1200 mm x 800 mm x 2000 mm poseur height tapered meeting table with laminate top and oak edge

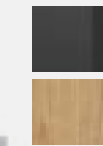

high back stools with fully upholstered seat and back, and frame in natural oak finish



## Meeting Rooms.



dia 1500 mm x 740 mm circular meeting table with laminate table top, oak edge and circular base

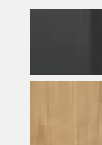

dia 800 mm x 740 mm circular meeting tables with laminate table top, oak edge and circular base

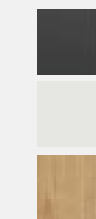

occasional chair with arms, with black frame, in black faux leather

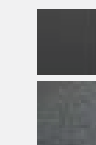

2100 mm x 650 mm x 800 mm credenza unit in MFC in oak finish, with black handles

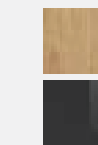

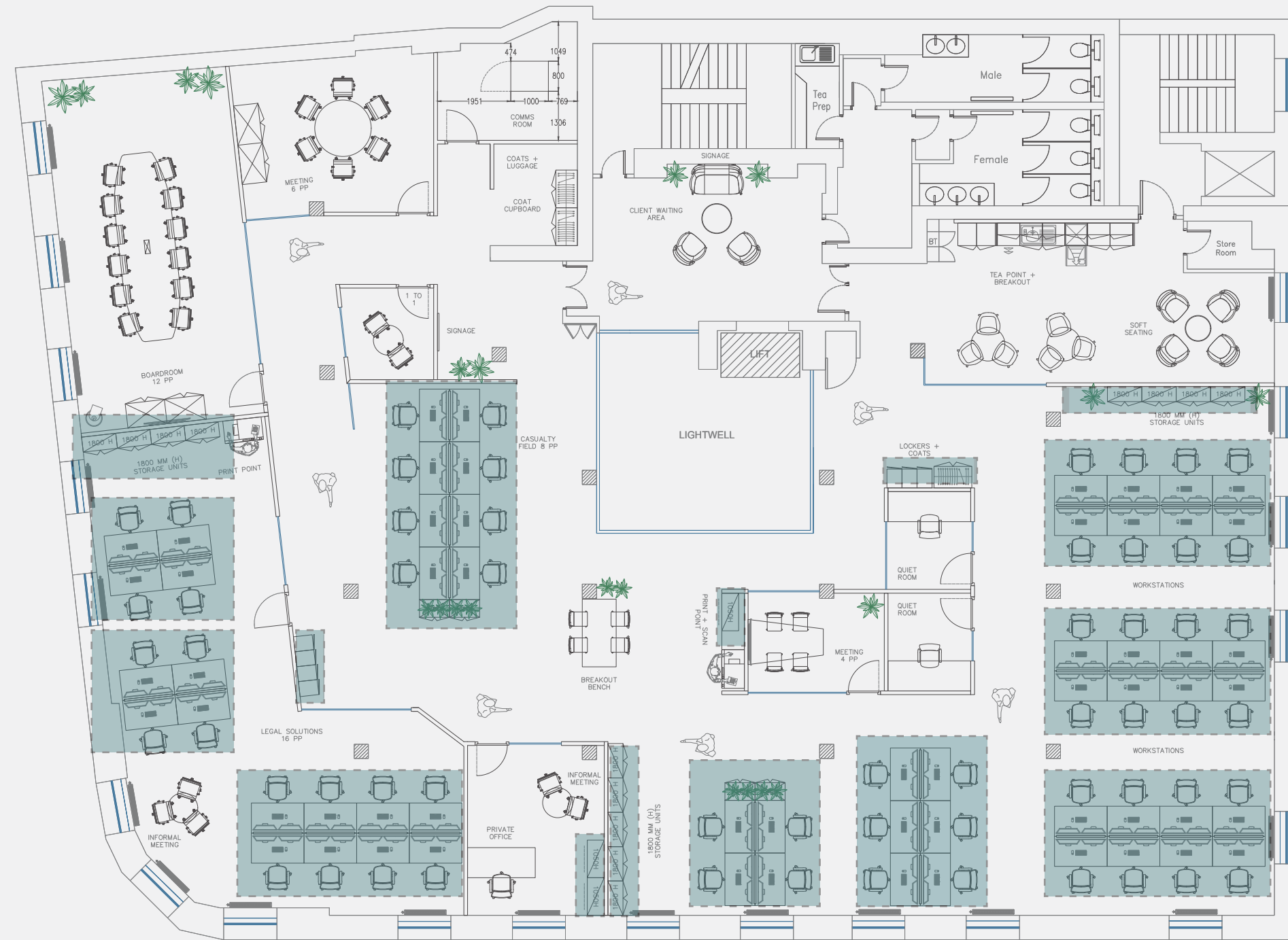

## Open Plan.



high back task chair with arms, upholstered seat and black mesh



1400 mm x 800 mm single, two, six and eight-person work benches with white top and anthracite frame



Vertical cable spine in anthracite



1386 mm x 355 mm x 8 mm formed feld 3D division screens in charcoal fabric finish



6 way extension lead in black and white finish



desktop double power socket in grey finish (1 between 2)

## Storage.



1000 mm x 450 mm x 1050 mm tambour storage unit in light grey finish



1600 mm x 400 mm x 500 mm lockers with manual combination locks in black



914 mm x 400 mm x 1800 mm tall storage units in white



1005 mm x 570 mm x 1910 mm tall coat cupboard in white



800 x 470 x 740 mm end of desk two door storage units in white



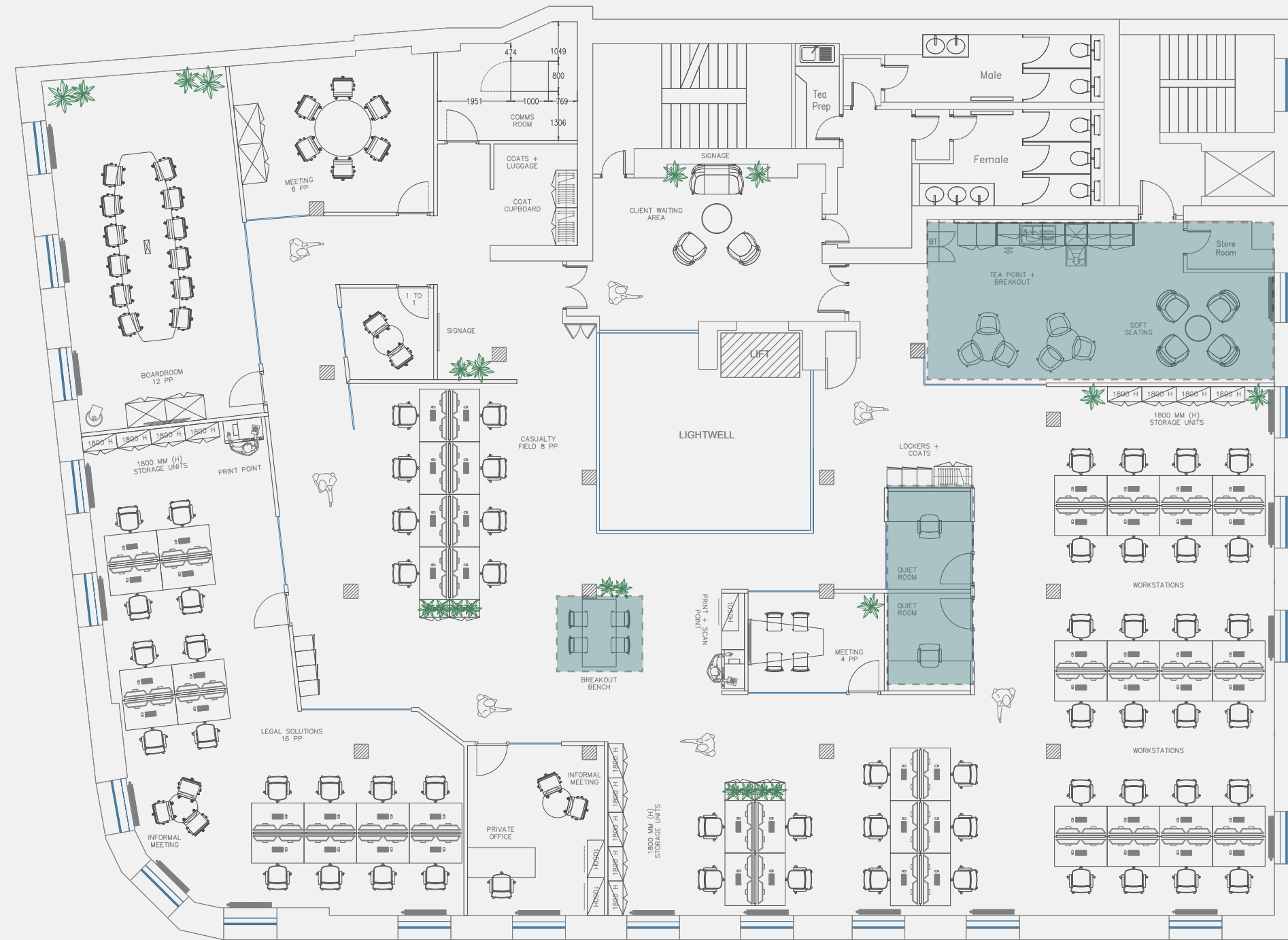

## Tea Point.



dia 900 mm standard height  
circular dining table with black  
circular base and swerve table  
top in black finish

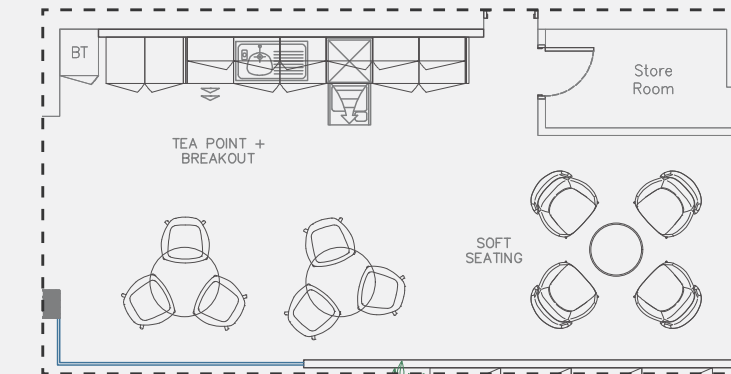

tea point area is proposed to be furnished  
re-using clients existing furniture, please  
note: **furniture dimensions are unknown**  
and are TBC on site



6 x chairs with non-upholstered seat and back  
in dark turquoise and natural oak frame



4 x armchairs upholstered in grey  
fabric, with oak legs and 1 x coffee  
table with white top and oak legs

## Project Area.



1800 mm x 900 mm x 1050 mm  
rectangular poseur height table with  
cutline edge top in anthracite finish and  
black frame finish



high back stools with fully  
upholstered seat and back, and  
frame in natural oak finish



high back task chair with  
arms, upholstered seat  
and black mesh