

PROPOSED GARAGE at REAR of 18 PARK PLACE WEST

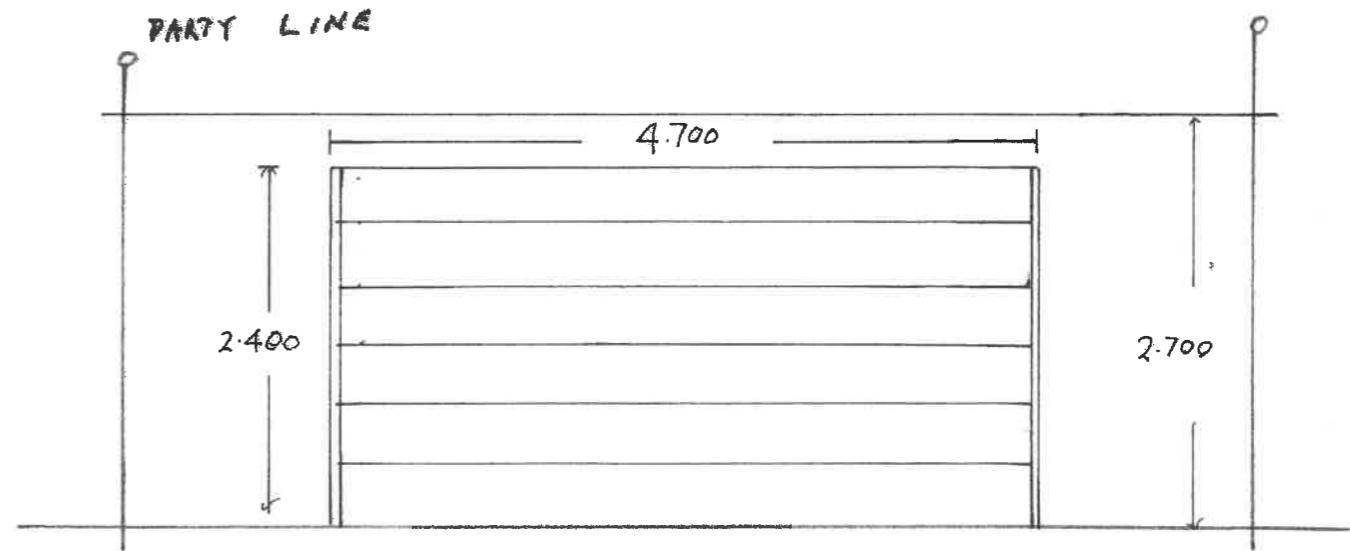

18 Park Place West

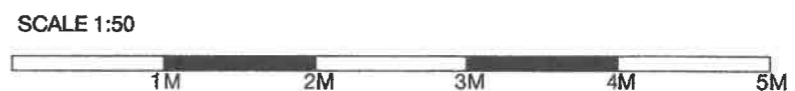
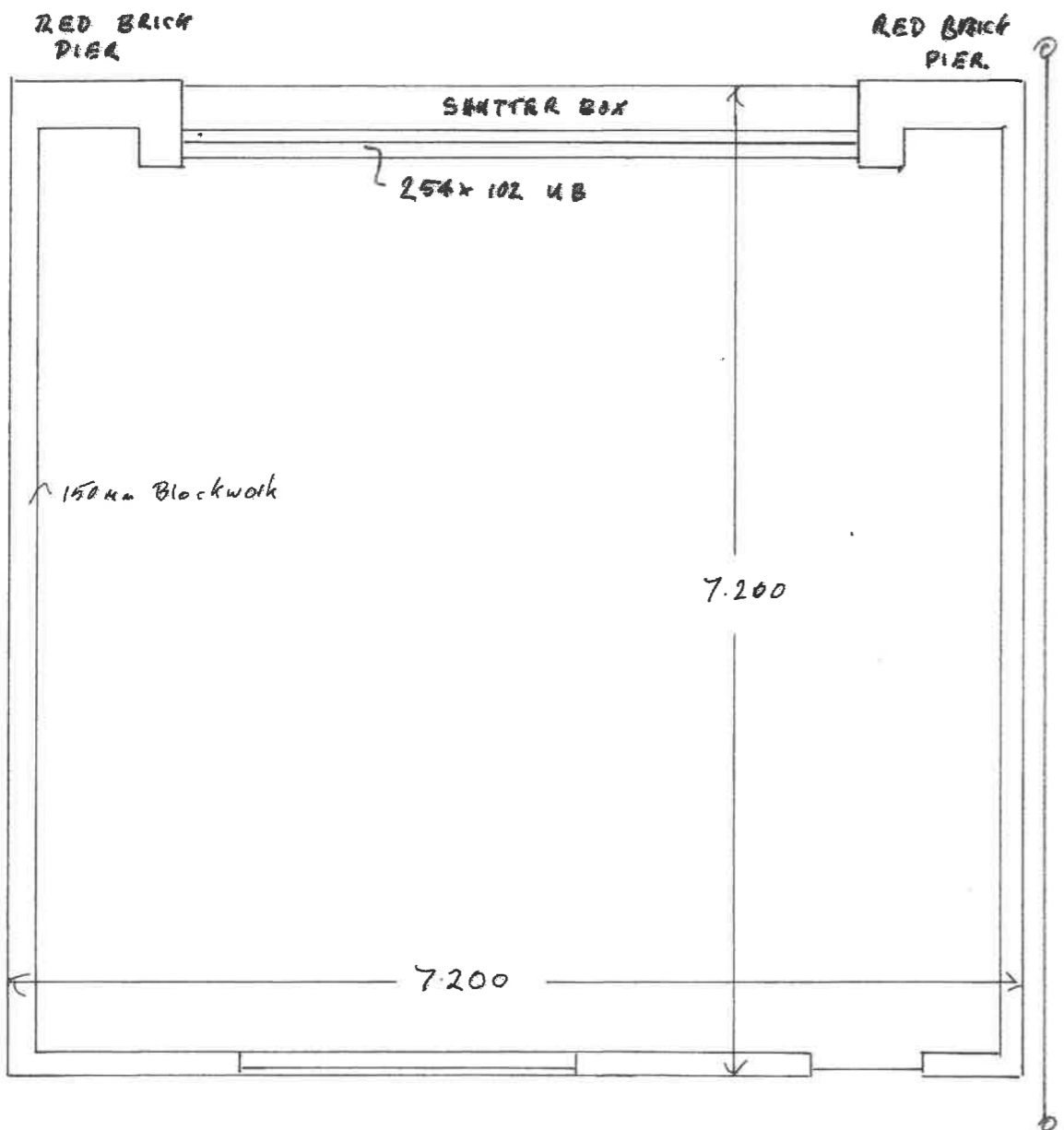
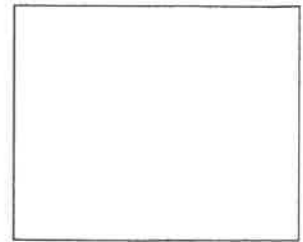

N



OS MasterMap 1250/2500/10000
scale
Wednesday, July 18, 2018, ID:
BLJT-00728233
www.planningapplicationmaps.co.uk

1:200 scale print at A3, Centre:
439838 E, 556208 N

©Crown Copyright Ordnance Survey.
Licence no. 100051661

