

Site Address: Beech House York Rd Green Hammerton YO268BN
Tree Surveyor: John Evans
Date of Assessment: 07/06/2021
Assessment Method: Visual assessment, undertaken from ground level only.
Weather Conditions: Bright warm, and sunny with good visibility.
Site Description: The site is a Active nursing home.
Tree Population: The trees onsite comprise of a mixture of broadleaf and conifer species growing next to hard non adopted access roads.
Legislative Protection: Information on the York City Councils website appears to show that there is no legislative protection on the site.
Soil Type: Soil Type: Information of the National Soils Resources Institute, which refers to the soils on site being 'Naturally wet very acid sandy and loamy soils'

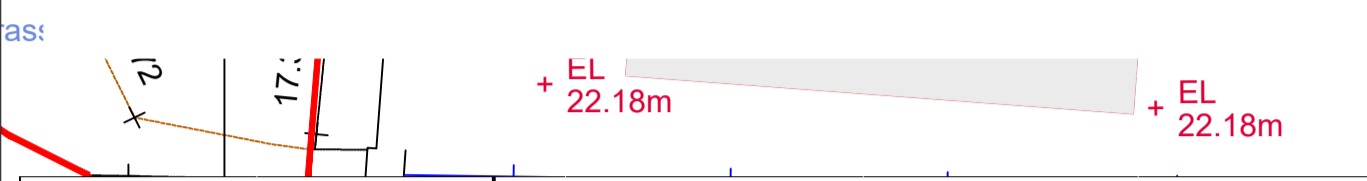
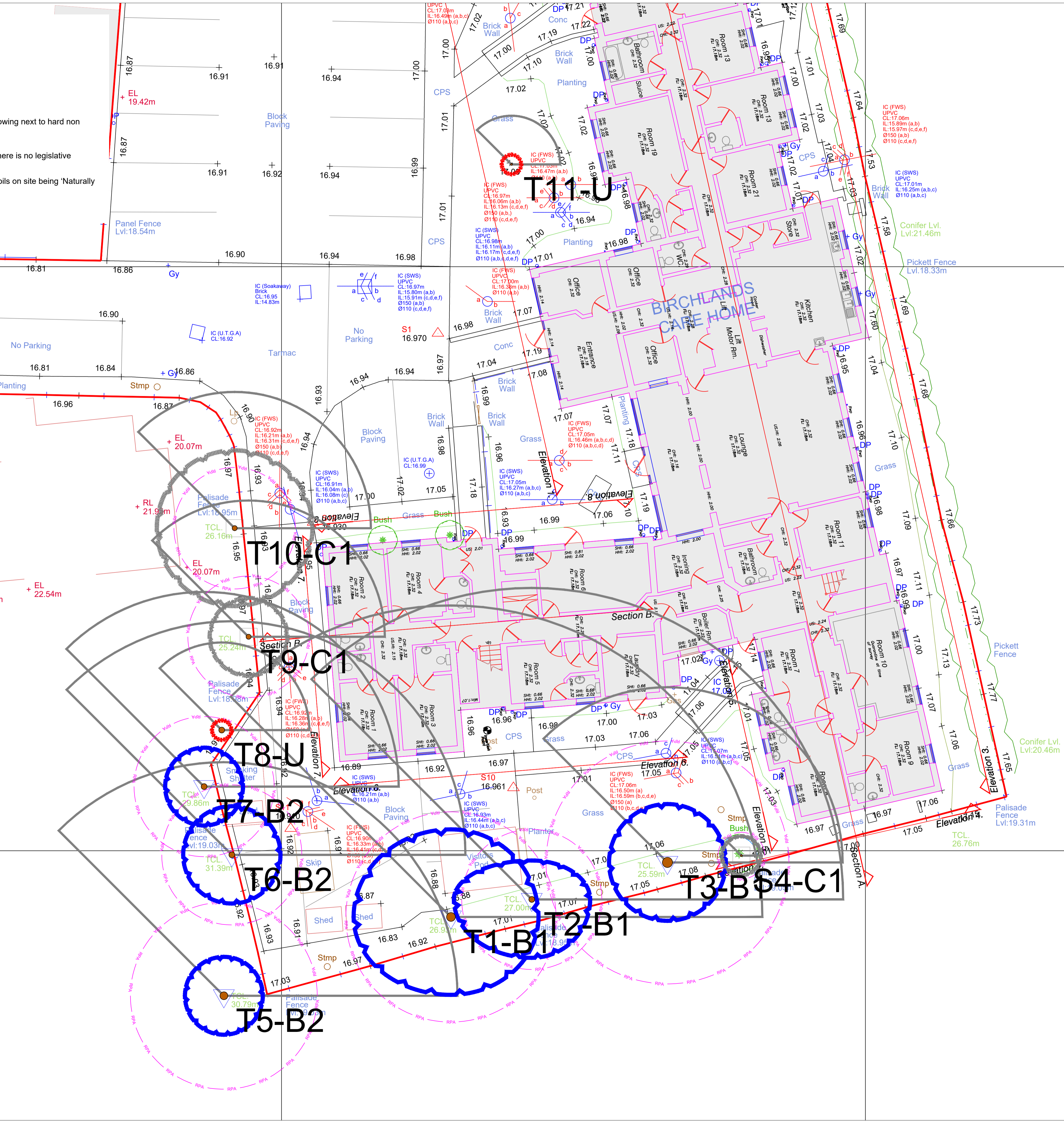
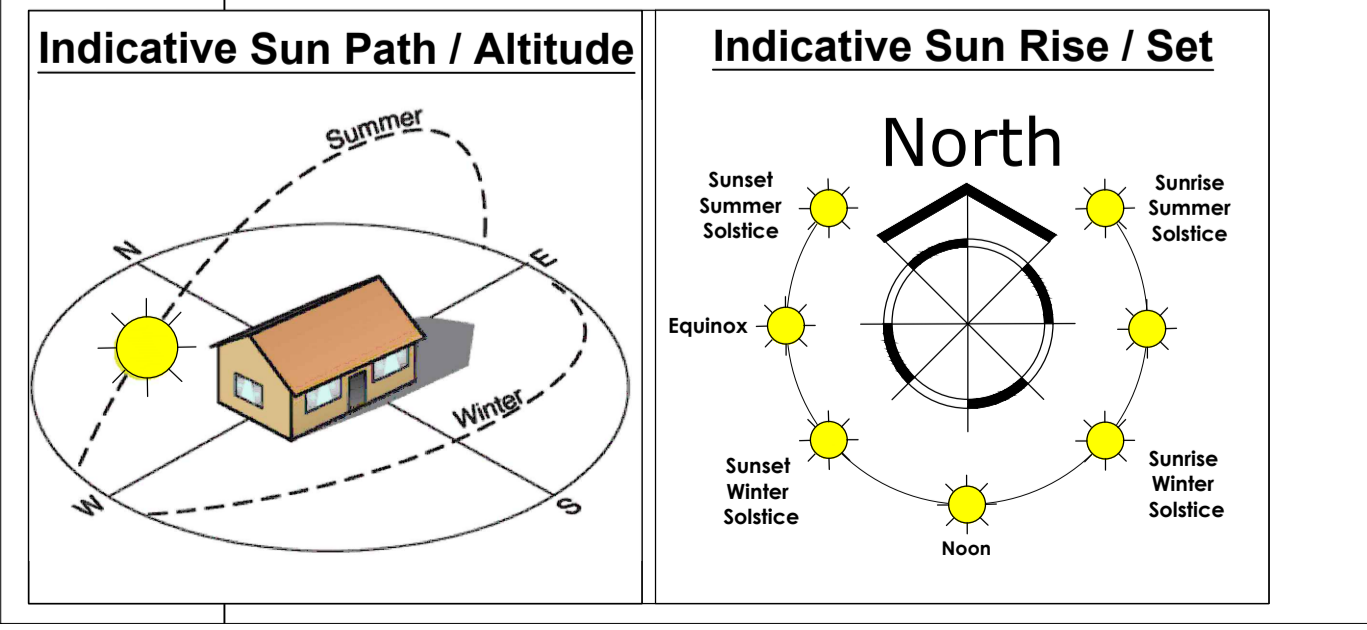
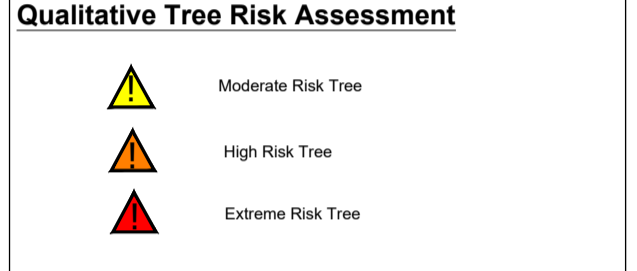
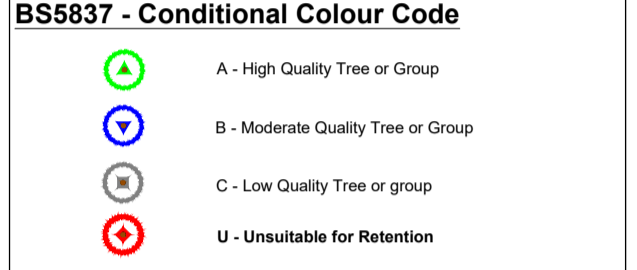
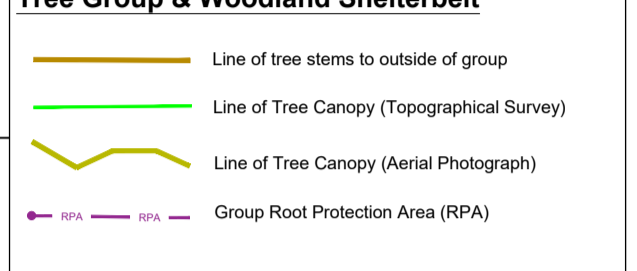
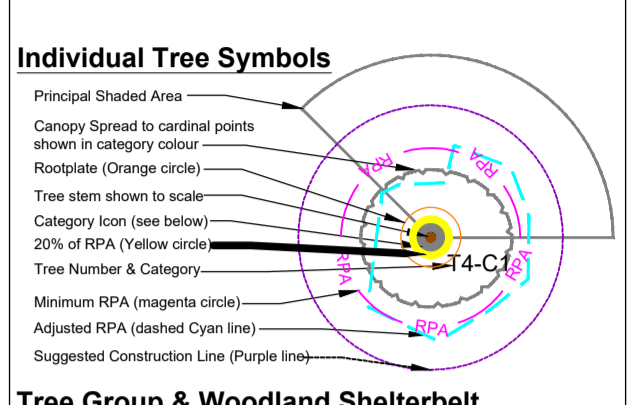
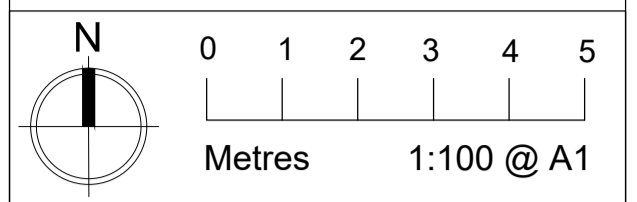

Table 1 - BS5837:2012 Cascade chart for tree quality assessment		
Category and definition	Criteria (including subcategories where appropriate)	Identification on plan
Trees unsuitable for retention (see Note)		
Category U Those in such a condition that they cannot realistically be retained as living trees in the context of the current land use for longer than 10 years	Trees that have a serious, irredeemable, structural defect, such that their early loss is expected due to collapse, including those that will become unsuitable after removal of other category U trees (e.g. where, for whatever reason, the loss of companion shelter cannot be mitigated by pruning) Trees that are dead or are showing signs of significant, irremediable, and irreversible overall decline Trees infected with pathogens of significance to the health and/or safety of other trees nearby, or very low quality trees suppressing adjacent trees of better quality. NOTE: Category U trees can have existing or potential conservation value, which it might be desirable to preserve, see 4.5.7.	Red on Plan
Trees to be considered for retention		
Category A Trees of high quality with an estimated remaining life expectancy of at least 40 years	Trees that are particularly good examples of their species, especially if rare or unusual, or that are of particular importance to the local landscape or other components of groups or formal or semi-formal arboreal features (e.g. the 'crown jewels' of a park)	Green on Plan
Category B Trees of moderate quality with an estimated remaining life expectancy of at least 20 years	Trees that might be included in category A, but are downgraded because of impaired condition (e.g. presence of significant though removable defects, including unsympathetic past management and storm damage), such that they are unlikely to be suitable for retention for beyond 40 years; or trees lacking the special quality necessary to merit the	Blue on Plan
Category C Trees of low quality with an estimated remaining life expectancy of at least 10 years, or young trees with a stem diameter below 150 mm	Unremarkable trees of very limited merit or such impaired condition that they do not qualify in higher categories Trees present in groups or woodlands, but without this conferring on them significantly greater collective landscape value, and/or trees offering low or only temporary/transient landscape benefits Trees with no material conservation or other cultural value	Grey on Plan

BS5837 Tree Survey
The following survey has been prepared from a visual assessment taken from ground level without any detailed investigation. Observations are based upon the body language of the trees and any visual indicators present at the time of inspection. This survey should be regarded as a preliminary overview, ongoing inspections will be required. Trees can be managed, but they cannot be controlled, and to be near a tree to accept some degree of risk. In most situations the health, condition and safety of trees should be checked on a cyclic basis, alternating between early and late seasons to ensure a full picture of tree health is established. Inspections should only be carried out by a suitably qualified arborist.
Mathematical abbreviations: > Greater than, < Less than.
Measurements / Estimates: All dimensions are estimates unless otherwise indicated. Measurements taken with a tape or clinometer are indicated with a 'V'. Less reliable estimated dimensions are indicated with a '7'.
Tree number: Numbered Tag attached to each stem usually on the inside face of the stem at roughly 2.5 metres. Where the number is followed by a C this denotes that the tag refers to a compartment or group.
Est Pos: Estimated Position of tree - a tree included on the survey which has been added to the Topographical Information / Plan.
Name: Tree species are detailed by their common names.
Age: I record the age as an estimate of the tree likely span for guidance only i.e:
Y Young - Recently established/started tree.
EM Early Mature - An established tree in the first third of its likely expected life span
SM Semi Mature - Fully established and growing with high vigour
M Mature - The middle one third of its likely expected life span
OM Over Mature - The later one third of expected life span
V Veteran - An aged example of the species, typically conservation value
S Senescent - Beyond its expected life span, historical interest.
Height: estimate height to the nearest metre to the mean height.
Height to underside: estimate height to the nearest half metre to the mean underside of the canopy.
First significant branch: I estimate height & orientation of large branches below the underside of the canopy.
Diameter: These figures relate to a measurement of the stem at 1.5m above ground level recorded in millimetres, measured with a rounded down diameter tape. Figures prefixed with MS denote trees or shrubs with multiple stems.
No. Stems: I record the number of significant stems that compose the tree.
Canopy (N.S.E.W.): estimate the distance of the canopy radius to the nearest metre to provide a mean distance of separation between the stem and the outer canopy.
Vitality: is a personal assessment of the tree's growth rate in the current season, in comparison to other trees within the locality, region and an indicator of the tree likely response to site change.
Safe Life: is a personal assessment of the trees likely expected remaining safe life span in years, assuming the site management continues as it is at present or the tree is protected from significant environmental change. Trees can reverse even serious decline and the expected safe life can be significantly improved following changes / improvements to site management and following remedial works.
Management Options: Comments detailing remedial works required improving immediate safety or improve the management of the tree.
The Risk Assessment: The International Society of Arboriculture (ISA) Tree Risk Assessment Qualification (TRAQ) takes a qualitative rather than quantitative approach to risk assessment. It uses metrics to compare the likelihood of failure of a tree or tree part, the likelihood that it will impact the target and the potential consequences of failure. Unless stated otherwise the risk assessment assumes the risk offered over the next year.
Minimum RPA: Root Protection Area: Minimum distance in metres of position of protective fencing in with section 4.6 BS5837:2012. In order to avoid damage to the roots or rooting environment of retained trees, an area equivalent to a circle with a radius 12 times the stem diameter.
Root Protection Area (Radius) (M): RPA given in metres from the centre of the stem.
Root Protection Area (Area) (M²): The ideal total area for the RPA given in metres squared.



© Barnes & Associates Ltd. This plan should be viewed in COLOUR, please do not scale from this drawing, all dimensions should be checked on site, any errors or divergences should be brought to the attention of Barnes and Associates Ltd. All right described in Chapter IV of the Copyright, Design & Patents Act 1988 have been generally asserted and copyright of this plan remains with Barnes Associates Ltd until all fees are paid in full.



Notes:
Plan is based upon the supplied topographical Survey Plan. Copies of this plan are available in CAD Formats .dwg & .dxf upon request.

Revision Description	
A - Preliminary Issue	

Client: RD Architecture
Project: Birchlands Nursing Home
Title: Tree Survey & Constraints

Drawing No.	Status
BA10762TS	P
Scale:	Revision:
1:100 @ A1	A
Date:	15/06/2021
Drawn By:	MM SB IB

BARNES associates
SURVEY MANAGE IMPROVE
Unit 1 Foundry Yard, New Row
Boroughbridge YO51 9AX
T 01423 322 371
E info@barnesassociates.co.uk
W barnesassociates.co.uk
Company Number 10438116
Registered in England and Wales