

DPC

Provide horizontal strip polymer (hyload) damp proof course to both internal and external skins minimum 150mm above external ground level. New DPC to be made continuous with existing DPC's and with floor DPM. Vertical DPC to be installed at all reveals where cavity is closed.

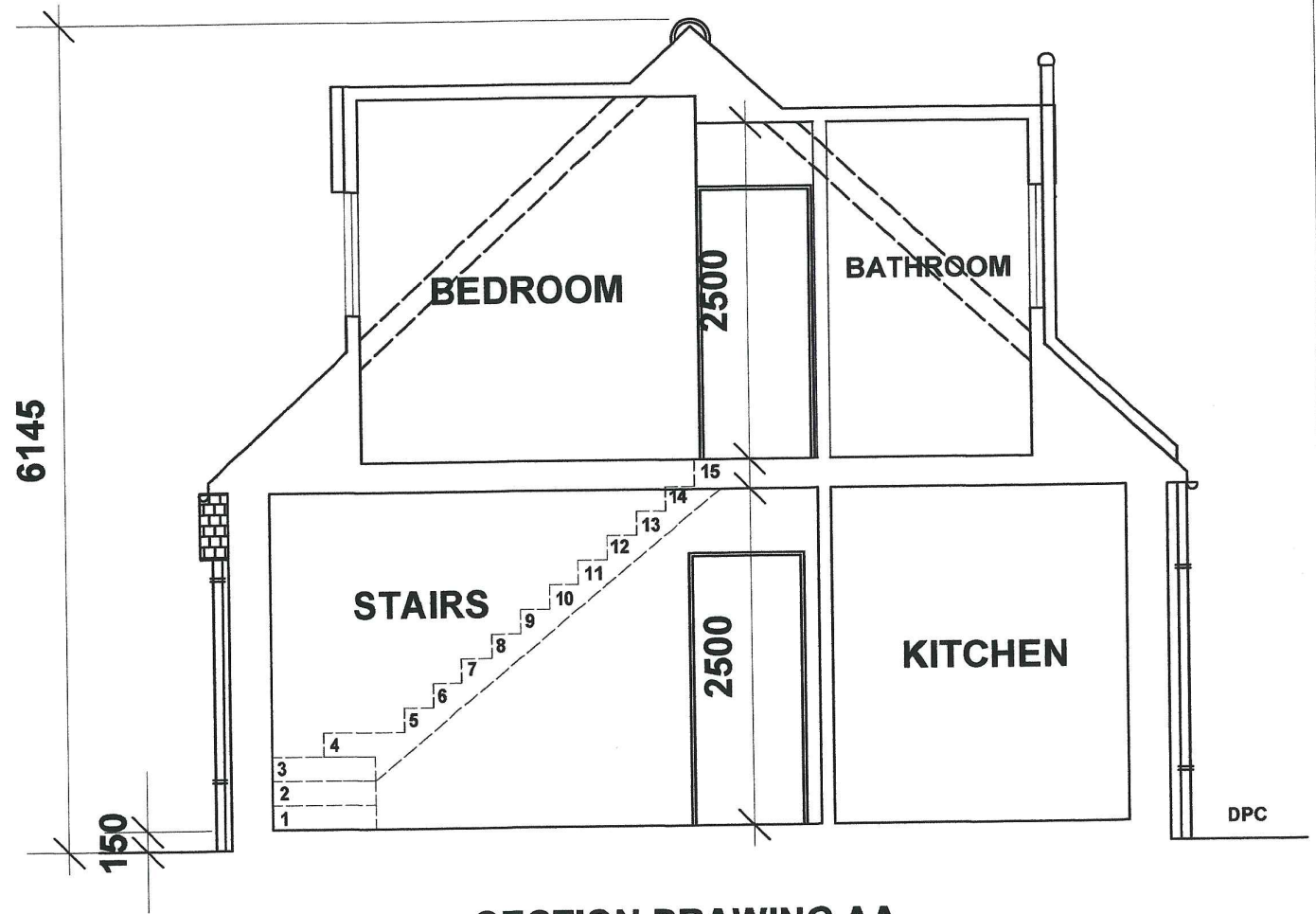

SECTION DRAWING AA

REV	DESCRIPTION	BY	DATE

Drawn By:
PLOT ANGELS
 LODGE LANE, BEXLEY, KENT DA5 1DJ

PROPERTY ADDRESS:
 172 THE DRIVE
 BEXLEY
 DA5 3BX

CLIENT NAME :
 MR MACLEAY

PROPOSED SECTION
 DRAWING

PLANNING	DRAWING NO: 06	SCALE: 1:50
DATE: 21ST AUGUST 2019		A4 SIZE