

General Notes:  
 1. PLEASE DO NOT SCALE FROM DRAWINGS.  
 2. Figured dimensions are in millimeters, levels in metres and are to be checked on site prior to all contractors commencing their works.  
 3. Areas are in metres. Any areas indicated are approximate and indicative only.  
 4. Any discrepancies to be reported to the Architect in writing prior to any works being carried out.  
 5. Drawing only to be used for the purpose specified.

Revision	Date	By	Chkd
- Issued for Planning	15/07/21		

**TYE ARCHITECTS**  
 poplar house limbersey lane  
 maulden bedfordshire mk45 2ea  
 t: +44(0)1525 406677 e: info@tyearchitects.com  
 w: www.tyearchitects.com

Project: **Holmside, Barnet Road, EN5 3JZ**  
 Title: **Existing Site Plan** Dwg No: **2050\_001**  
 Purpose: **PLANNING** Scale: **1:500@A3** Revision: **-**  
©Confidential copyright Tye Architects under berne & universal copyright convention. Information contained within this drawing is the sole copyright of Tye Architects and is not to be reproduced without their express permission. This document must not be copied without written permission and the contents must not be imparted to a third party nor be used for any unauthorised purpose.

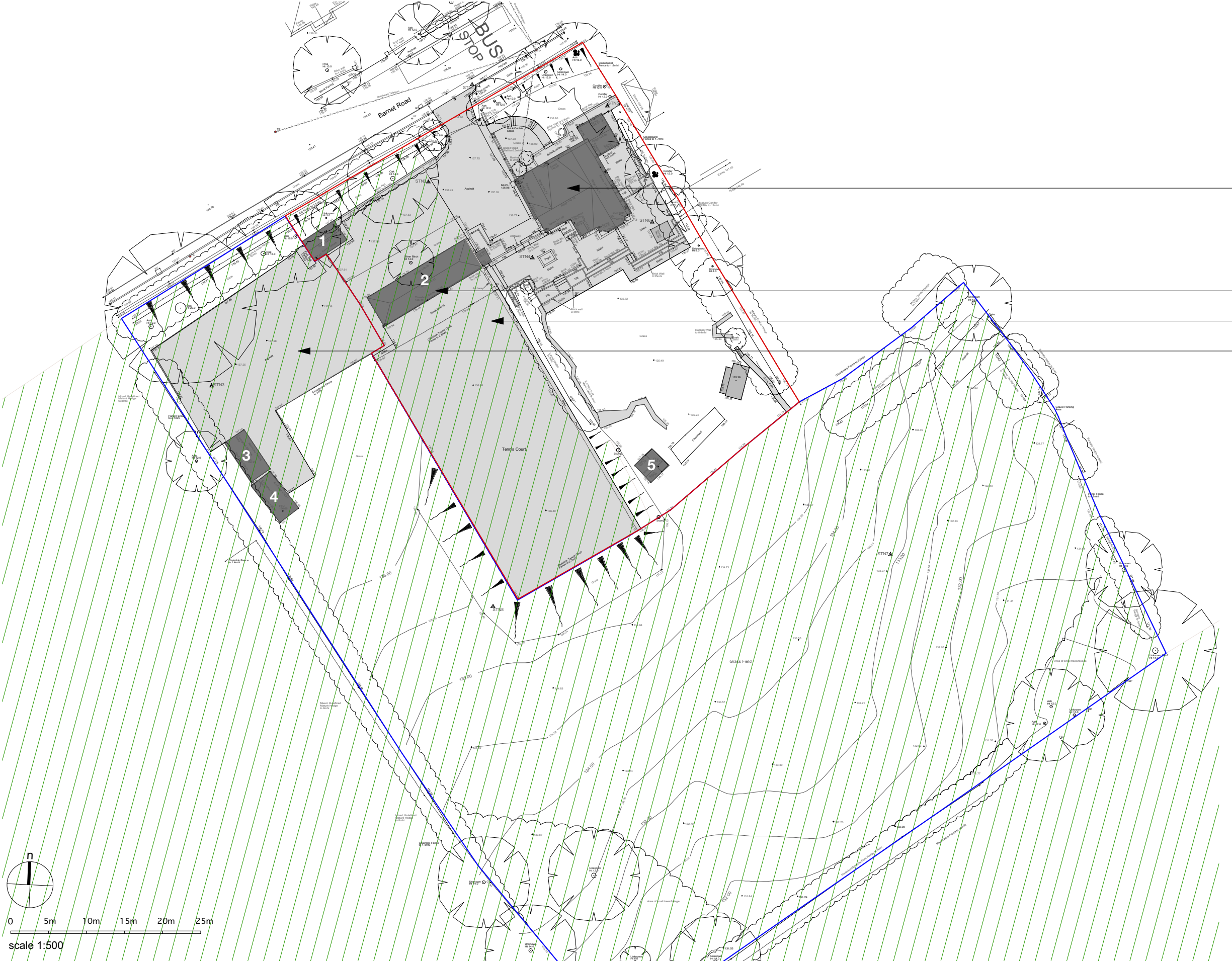

Existing dwelling to be demolished

Existing outbuildings (1-5) to be demolished

Existing tennis court to be removed

Hardstanding to be removed - please refer to accompanying landscaping plan for proposed external works

**Existing Areas and Volumes**

Existing House  
 Gross External Area Total 245m<sup>2</sup>  
 Ground Floor 130m<sup>2</sup>  
 First Floor 115m<sup>2</sup>

Outbuildings  
 Gross External Area Total 133m<sup>2</sup>  
 1 15m<sup>2</sup>  
 2 70m<sup>2</sup>  
 3 19m<sup>2</sup>  
 4 19m<sup>2</sup>  
 5 10m<sup>2</sup>

Green Belt  
 Existing outbuildings within Green Belt (1-4)  
 Total Gross External Area: 123m<sup>2</sup>  
 Total Volume: 358m<sup>3</sup>

Total Area of Hard standing within the Green Belt to be removed: 1386m<sup>2</sup>

**Key:**  
 Site Boundary —  
 Site Ownership Boundary —  
 Green Belt (as described on Barnet Council planning documents)