

Proposed Site Section A-A

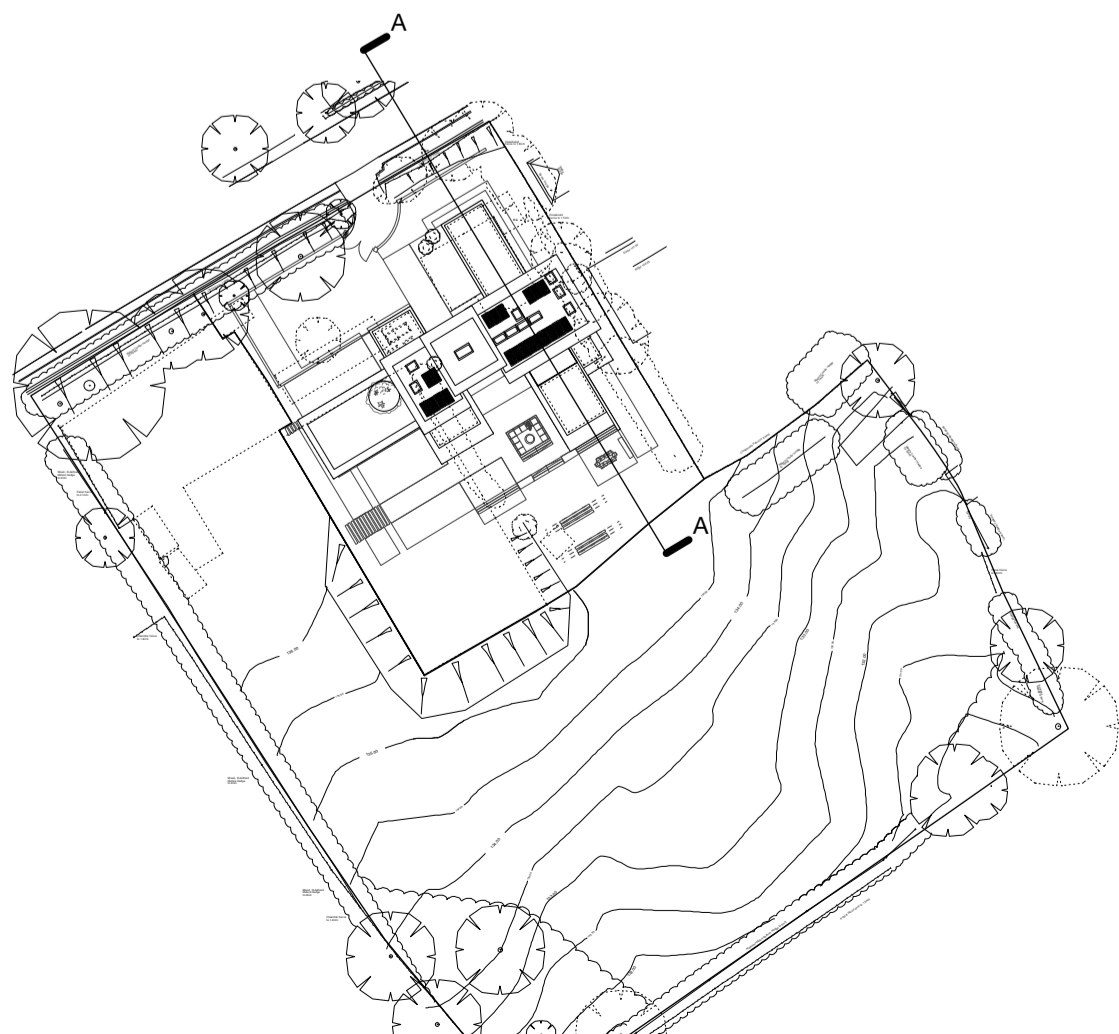
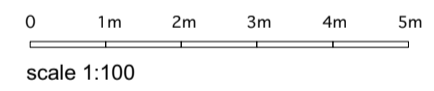

Key Plan NTS

Revision	Date	By	Chkd
- Issued for Planning	15/7/21		

- General Notes:
- PLEASE DO NOT SCALE FROM DRAWINGS.
  - Figured dimensions are in millimeters, levels in metres and are to be checked on site prior to all contractors commencing their works.
  - Areas are in metres. Any areas indicated are approximate and indicative only.
  - Any discrepancies to be reported to the Architect in writing prior to any works being carried out.
  - Drawing only to be used for the purpose specified.

Specific Notes  
 NOTE: Landscape indicative only, please refer to accompanying proposals prepared by Studio31

**TYE ARCHITECTS**  
 poplar house limbersey lane maulden bedfordshire mk45 2ea  
 t: +44(0)1525 406677 e: info@tyearchitects.com  
 w: www.tyearchitects.com

Project: Holmside, Barnet Road, EN5 3JZ  
 Title: **Proposed Site Section**  
 Purpose: PLANNING Dwg No: **2050\_400**  
 Scale: 1:100 @ A1 Revision: -

© Confidential copyright Tye Architects under license & universal copyright convention. Information contained within this drawing is the sole copyright of Tye Architects and is not to be reproduced without their express permission. This document must not be copied without written permission and the contents must not be applied to a third party nor be used for any unauthorised purpose.