

Drawing Number:
21/04/BAR/
BWK/ 02

Size
A3

Revisions:

Notes:

Preliminary Plans
Subject to L.A.
Approval

Drawn By:
JP

Date:

Scale:

Mr P & Mrs R Barton
Extension & alterations to
Thurne
Heresfield
GL10 3EE

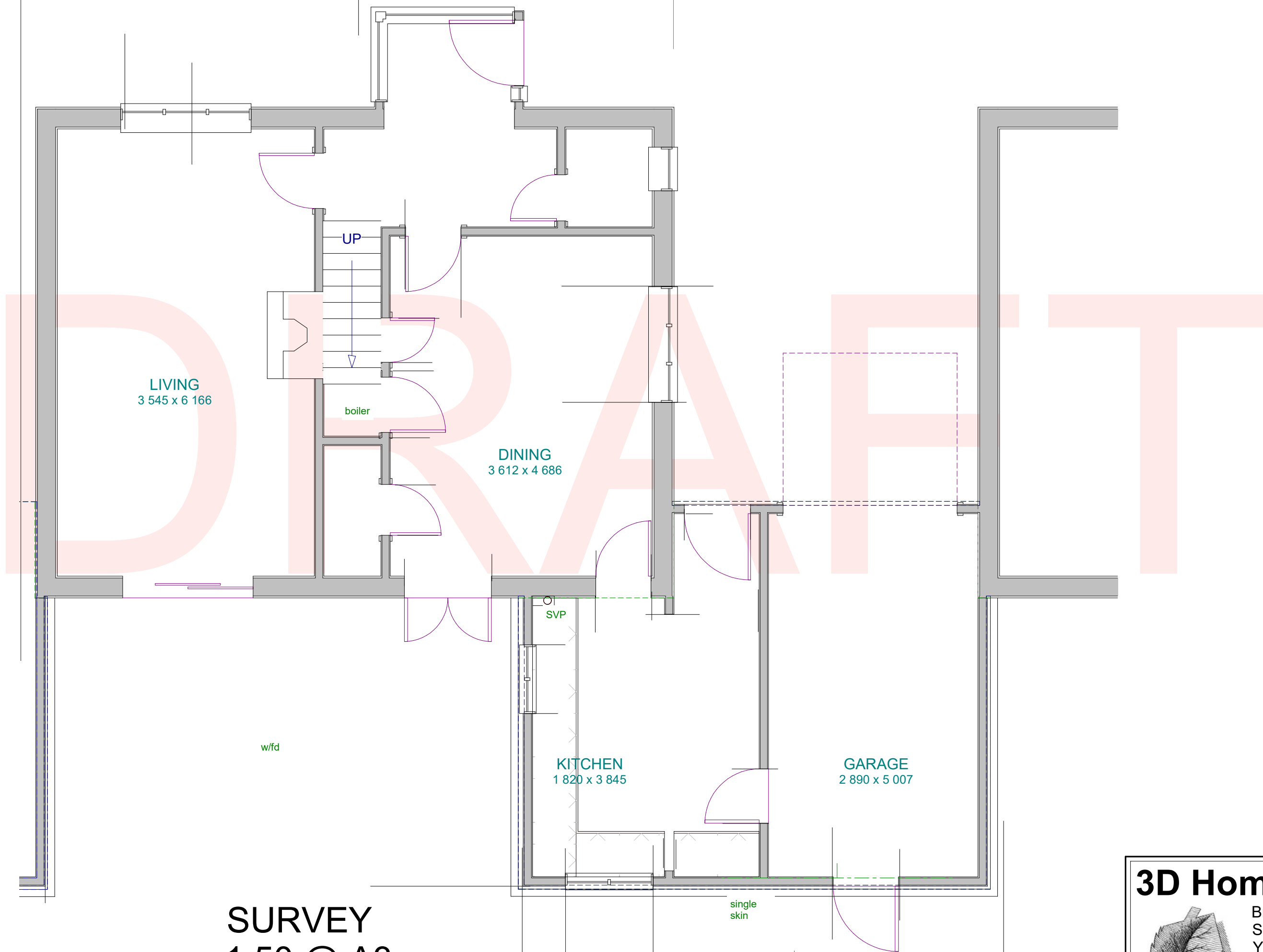

LIVING
3 545 x 6 166

DINING
3 612 x 4 686

KITCHEN
1 820 x 3 845

GARAGE
2 890 x 5 007

SURVEY
1:50 @ A3

3D Home Design



Brook Croft
Sampford Spiney
Yelverton PL20 7QX

01822 854795
3d.home@talktalk.net