

Landscaping Key

- 1.8m high close boarded fence
- 1.0m high close boarded fence
- G 1.8m high close boarded gate
- [B] Bin Store area
- [C] Covered Cycle Storage
- Trees**
- A Betula Pendula Silver Birch
- B Sorbus Whitebeam
- C Robinia False Acacia
- Large Shrubs** Planted at 1 per sq.m
- K Viburnum Viburnum
- L Photinia Red Robin
- M Cotoneaster Dammeri Cotoneaster
- Small Shrubs** Planted at 3 per sq.m
- R Hebe Autumn Glory Hebe
- S Senecio Laxifolia Senecio
- Ground Cover** Planted at 5 per sq.m
- In groups of single species
- V Euonymus Fortunei Radicans Euonymus
- W Cotoneaster Dammeri Cotoneaster
- W Lavandula Lavender
- Hedge Planting**
- [Symbol] Privet Ligustrum
- [Symbol] Turfing
- Surfacing**
- Drive/Parking Area Permeable Rustic finish
- Block Pavings
- House paths and patio Buff finished riven slabs

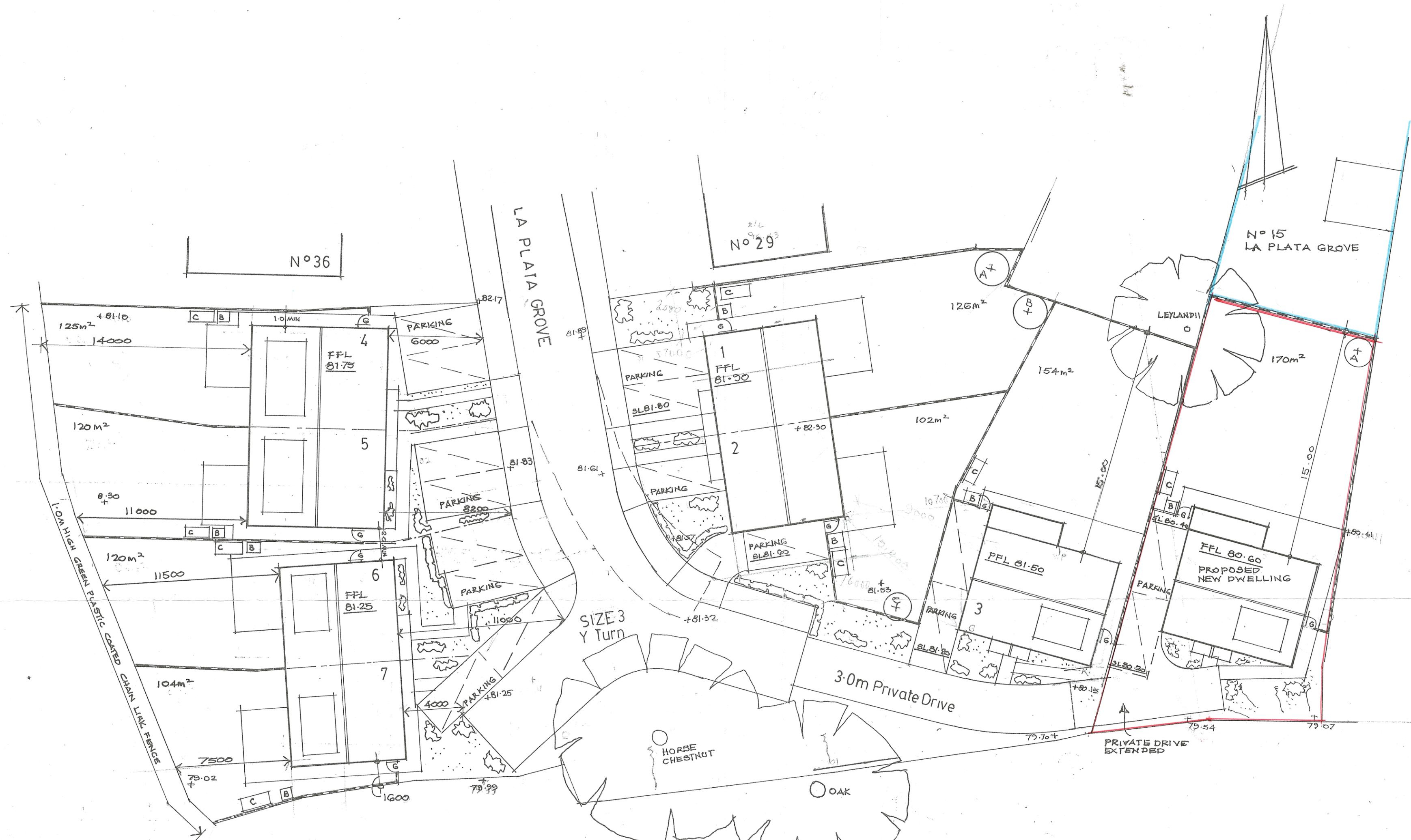

General:
 All trees and shrub planting and turfing is to be carried out in accordance with B.S. 3936 and 4428. Landscaping scheme/planting program timetabled for implemented during the first planting season (Mid-November to Mid-March) after substantial completion of the building works.
 Any imported soil and screened topsoil should be free from any rubble, subsoil and stones bigger than 50mm. Topsoiled areas are to be cultivated by hand or machine prior to planting, no compaction by machine. Topsoil planting minimum depths to be 450mm for shrub/tree beds, 150mm for turfed areas.
 The approved landscaping scheme on completion will need to be confirmed with the local authority that all work has been carried out to their approval.

Tree Planting:
 Trees planting- extra heavy standards planted in 800mm cubed tree pit 450-750mm deep standards to be planted in 650mm min squared tree pit 400mm deep. These planted centrally with a 1M squared 50mm min. deep dark wood chip mulch bed. Tree pits to be backfilled with clean irrigation/aeration system units fitted to fully surround the root ball.
 Tree support comprising of a stake one-third the height of the clear stem, 300mm min. depth below ground level, with a buckle tie toward the head of the stake.
 Trees larger than standard size should be double staked and double tied.

Maintenance:
 Water in the first two years, hedging are to receive 1 gal per shrub, trees 10 gals, every other week for the period May-September.
 Carry out weeding around trees 6 times per year for 2 years. Re-apply mulch annually in March or April with dressing of bone meal and fish blood mix.
 Any trees or shrubs which within a period of 5 years from the completion of the building works die, other than by frost, drought or vandalism. Shall be replaced.

+ 81.89 EXISTING SITE LEVELS
 + 81.68 PROPOSED LEVELS

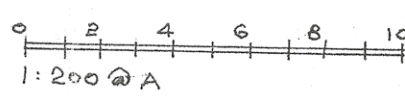

E: PROPOSED NEW DWELLING R/O 15 LA PLATA GROVE ADDED JUNE 2021
 D: SITE DIMS ADDED PLOTS 4-7 ADDED APRIL 2021
 C: PLOTS 4-7 ADDED MAR 2021
 B: PLOT 4 ADDED
 REV A: PAIR SEMI DET. HOUSES ADDED OCT 2020

Site Layout Plan	
PROPOSED RESIDENTIAL DEVELOPMENT LAND AT LA PLATA GROVE BRENTWOOD ESSEX CM14 4LA	
For: La Plata Grove Ltd.	
Scale: 1:200	Drg. No 4519:01
Nigel Cooper	Tel: 07754151283