

Location Plan

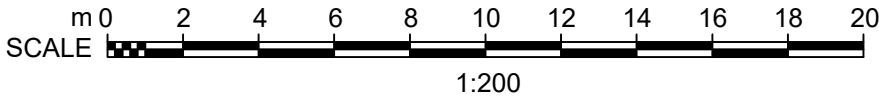

AGNEW STREET

7.0m

7.0m

6.7m

3

1

Brook House

3 to 5

1 to 2

Club

26

25

1 to 3

Hastings Court

Council
Offices

1

8

Drawn By: JHS	Date: May 2016
Checked By: JMF	Date:

Drawing Scales:
1:200 @ A1 / 1:400 @ A3

Drawing Status:
PLANNING

This drawing is to be read in conjunction with all engineers and specialists drawings along with all relevant specifications.

All permissions & approvals are to be obtained prior to commencement of any works on site.

All gridlines, dimensions, building lines, etc. are to be checked carefully on site prior to the commencement of any works.

All workmanship and materials shall comply with current Building Regulations, British Standards, Codes of Practice and N.H.B.C. requirements.

All materials shall be fixed, applied or mixed in accordance with manufacturer's instructions or specifications and all materials shall be suitable for their purpose.

Dimensions are not to be scaled from this drawing.

Any discrepancies between the information given by engineers and other specialists must be brought to the attention of the designer prior to the commencement of any works.

Where it is required that inspection be made by the local authority this shall be arranged by the contractor to suit their programme.

The contractor shall comply with the health and safety requirements as set out by the CDM Regulations, The Health and Safety Executive.

Prior to commencing work the contractor shall carry out an internal and external condition survey of the existing building and shall take into account everything necessary for the proper execution of the works, to the satisfaction of the 'Inspector' whether indicated on the drawing or not.

Rev.	Date	Description

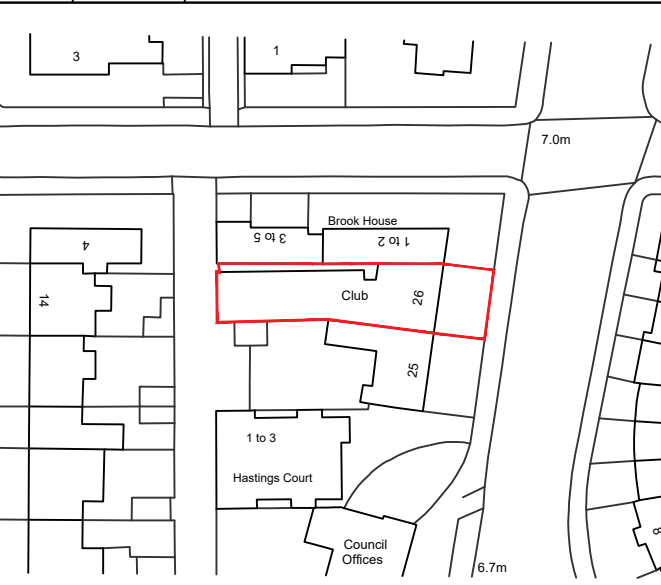

Location Plan 1:1250 @ A1 / 1:2500 @ A3

Project Description:
Conversion of existing building into single dwelling with extension to rear and new Coachhouse. Existing brick construction at rear (kitchen) to be demolished.

Project Address:
26 Hastings Place
Lytham
FY8 5LZ

Client:
Mr Turnbull

firth
ARCHITECTS

Firth Architects
Old Bank Studio
43 Woodlands Road
Ansdell
Lytham
Lancashire FY8 1DA
info@firthorchitects.com
www.firthorchitects.com
01253 734036

RIBA

arb
Architects Registration Board
Registered as an architect under the Architects Act 1967

Drawing Title:
Location Plan

Drawing Number: HAS / 1 / 000	Revision
---	-----------------