

SITE LOCATION

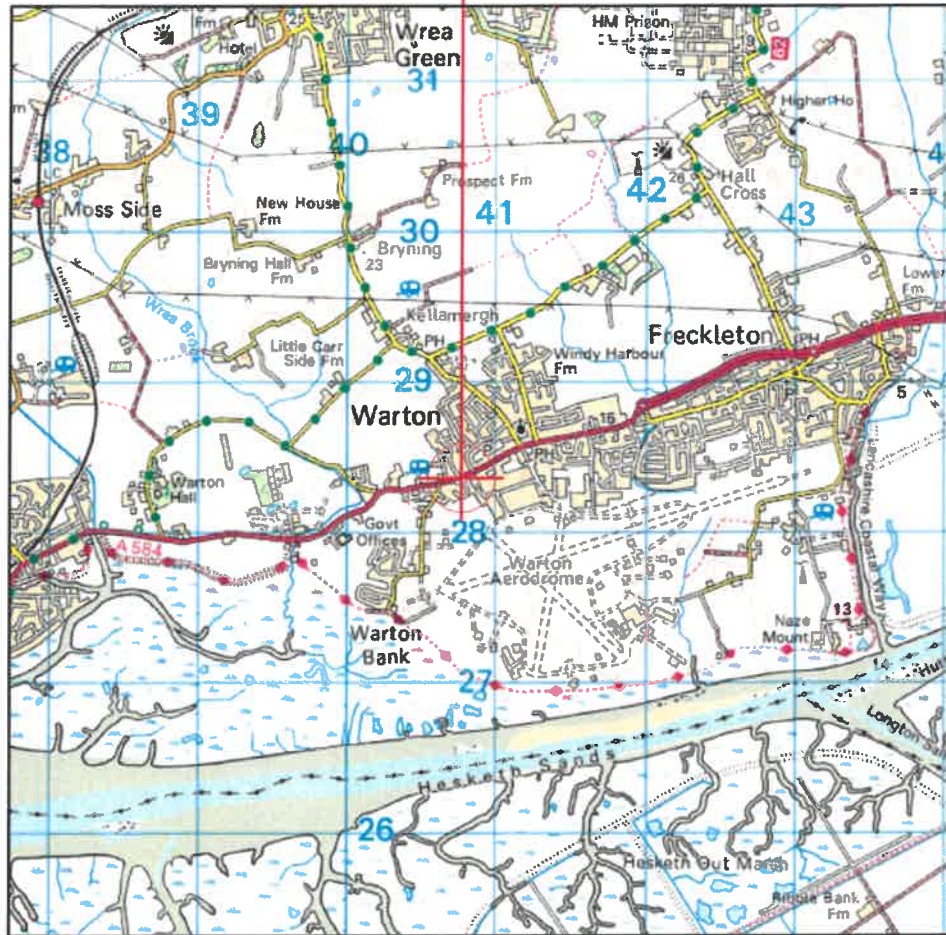

Reproduced by permission of Ordnance Survey on behalf of the Controller of Her Majesty's Stationery Office
All rights reserved. © Crown Copyright licence no. 100022432

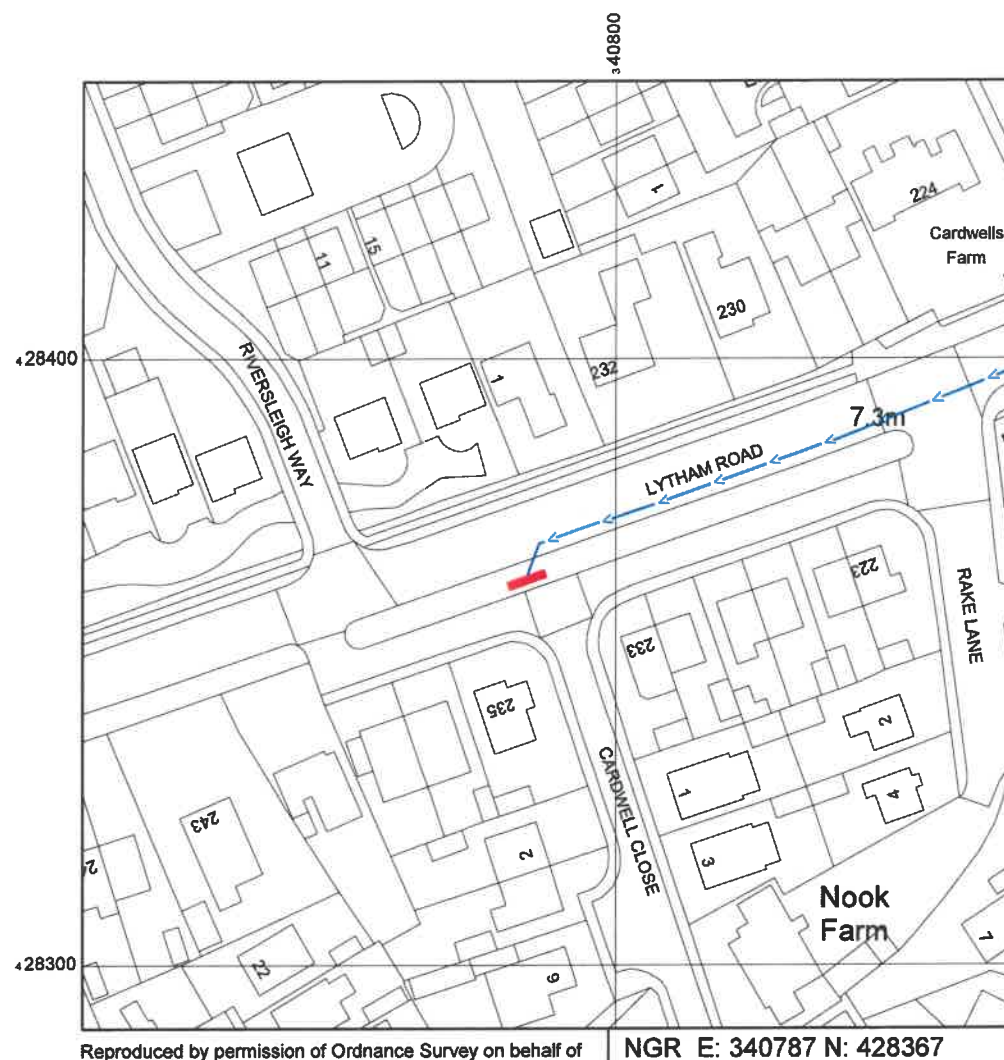

Reproduced by permission of Ordnance Survey on behalf of the Controller of Her Majesty's Stationery Office
All rights reserved. © Crown Copyright licence no. 100062043

NOTES:

1. ALL DIMENSIONS IN MM UNLESS OTHERWISE NOTED.

DIRECTIONS TO SITE:
Head north-east on M6. At junction 31A, exit towards Longridge. At the roundabout, take the 3rd exit onto Longsands Ln/B6242. At the roundabout, take the 2nd exit onto Anderions Way/B6242. At the roundabout, take the 1st exit onto Eastway/B6241. Turn left onto Sir Tom Finney Way/B6241. Turn right onto Blackpool Rd/A5085. Turn left onto Preston New Rd/A584. At the roundabout, take the 3rd exit onto A584. At the roundabout, take the 2nd exit onto Lytham Rd/A584. Follow Lytham Rd and site location is on the left hand side.

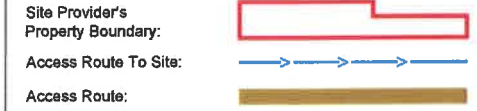

Master	MBNL EE	Project	Purpose of Issue	Issue
M001	MBNL	5G UNILATERAL	Planning	A
Date:	05/07/2021	Revision / Upgrade Description		
Drawn:	CDN	First Issue - Site nomination dated: TBC		
Checked:	DH			
Approved:	SD			

CK Hutchison Networks (UK) Limited
Great Brighams Mead,
Vastern Road, Reading,
Berkshire, England,
RG1 8DJ

Design Consultant & Principal Contractor:



WHP Telecoms
Unit 1 Maple Park,
Low Fields Avenue, Leeds
LS12 6HH
Tel: 01133023550
e-mail: info@whptelecoms.com

Site Name:
LYTHAM ROAD STREETWORKS

Site ID:
FYD15019

Address:
**LYTHAM ROAD, BRYNING-WITH-WARTON,
WARTON, FYLDE, LANCASHIRE,
NORTH WEST ENGLAND, ENGLAND,
PR4 1AS**

Title:
002 SITE LOCATION PLAN

Project:
5G UNILATERAL

Purpose of Issue:
PLANNING

EE Cell ID:	MBNL Cell ID:	Cell ID:
N/A	N/A	N/A

Master Drawing No:	Issue:
FYD15019_M001	A

SITE AREA PLAN

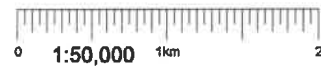

SITE PHOTOGRAPH

SITE LOCATION PLAN

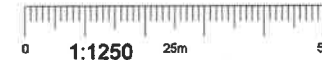

GOOGLE MAPS QR CODE

GOOGLE MAPS - <https://goo.gl/maps/cEM8zeKBmNA5ur8o9>

GOOGLE STREETVIEW - <https://goo.gl/maps/BZPu9tKqjXdBo1197>

100mm
50mm
10mm