

1 Proposed Site Plan
1 : 100

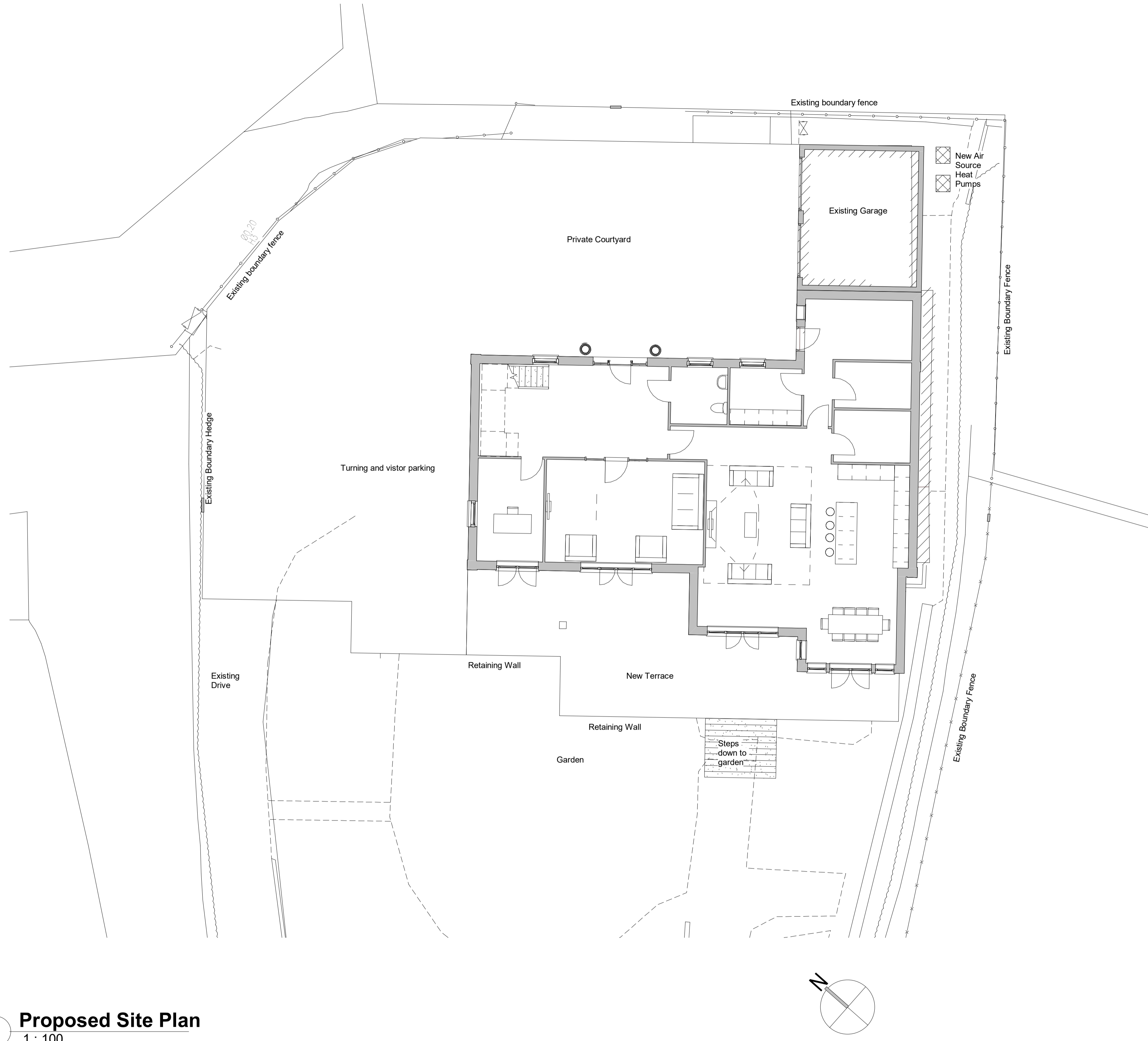

Job Reference:	590	Drawing Reference:	P104	Revision:	-	Drawing:	Proposed Site plan
Scale:	1 : 100	Sheet Size:	A1	Date:	19/06/21	Project:	6 Chantry Walk
				Drawn By:	GU	Client:	Mr & Mrs Lawrie
				Project Status:	PLA		
				Issue Date:			
				Rev	First Issue	Description	

Do not scale from this drawing. All dimensions to be checked and verified on site. Reproduction or use in any form without the written permission of Gary Underwood Associates Limited is prohibited. © 2024 Gary Underwood Associates Limited.