

**KEY**

- EXISTING UU SEWER
- .-.- IC ON NEW FOUL SEWER
- .-.- IC ON NEW SURFACE WATER SEWER
- RE --- RODDING EYE
- G --- ROAD GULLY

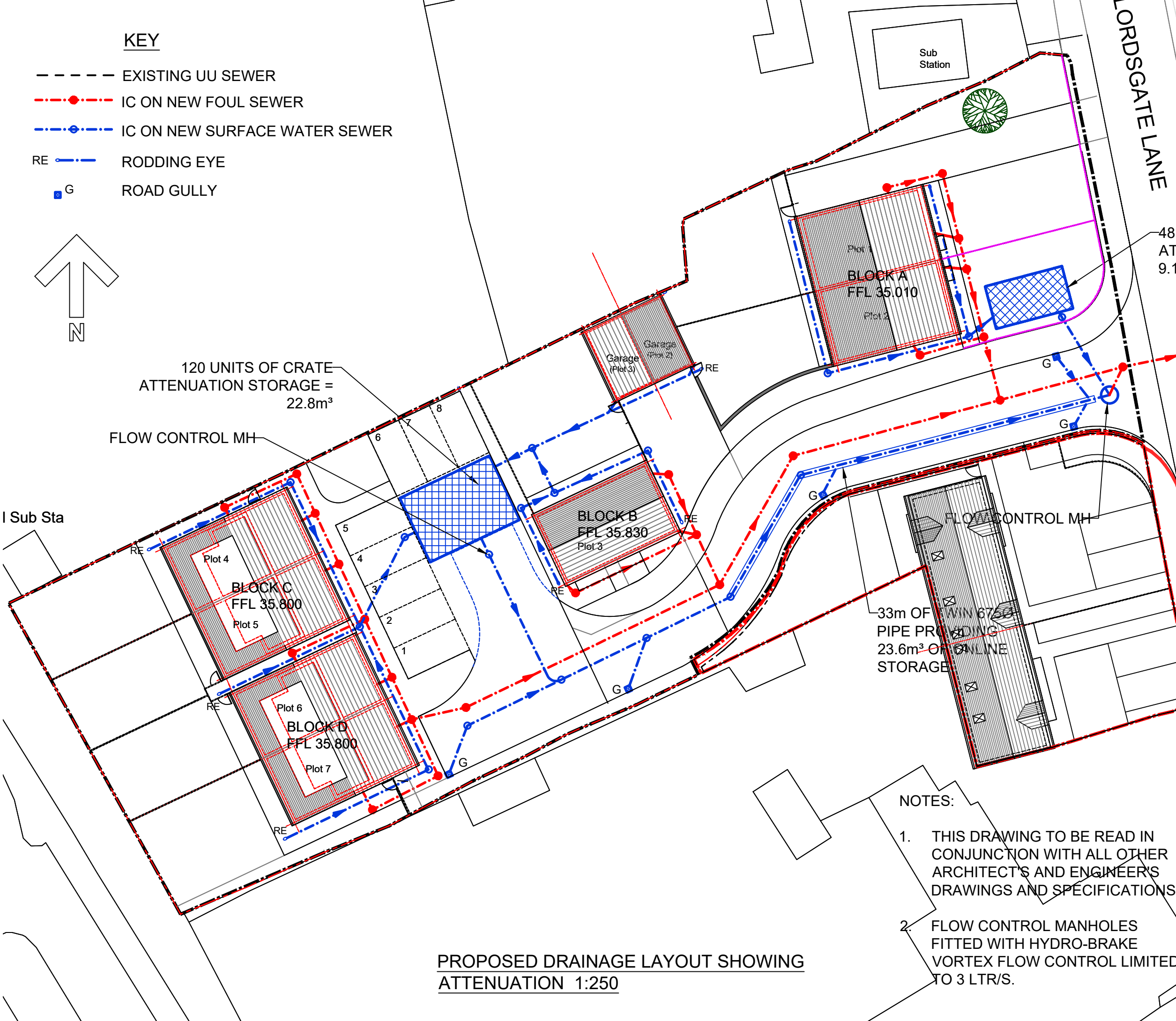
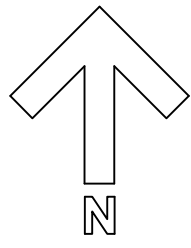

120 UNITS OF CRATE ATTENUATION STORAGE = 22.8m<sup>3</sup>

48 UNITS OF CRATE ATTENUATION STORAGE = 9.1m<sup>3</sup>

33m OF 110mm 675mm PIPE PROVIDING 23.6m<sup>3</sup> OF ONLINE STORAGE

A	STORAGE VOLUMES ADJUSTED	30.06.21	TDA	DR
Rev:	Description:	Date:	By:	Chkd:

**INTERIM**  
CONSULTANCY SOLUTIONS

Church House  
1 Hanover Street, Liverpool L1 3DN  
t: 07909 870466  
e: info@interimcs.co.uk

Status: **PLANNING**

Project: **NEW HOUSES AT LORDSGATE LANE BURSCOUGH L40 05A**

Drg Title: **PROPOSED DRAINAGE PLAN**

Scale:	Size:	First Issue:	Drawn:	Checked:
1:250	A3	Oct 2020	AP	DR
Drg No: <b>682/STRL 100</b>				Rev: <b>A</b>

- NOTES:**
- THIS DRAWING TO BE READ IN CONJUNCTION WITH ALL OTHER ARCHITECT'S AND ENGINEER'S DRAWINGS AND SPECIFICATIONS.
  - FLOW CONTROL MANHOLES FITTED WITH HYDRO-BRAKE VORTEX FLOW CONTROL LIMITED TO 3 LTR/S.

**PROPOSED DRAINAGE LAYOUT SHOWING ATTENUATION 1:250**