



Demolitions Legend

1 : 50

-  existing building elements and structure to be demolished indicated blue dashed line. Unless otherwise stated all demolitions material to be disposed offsite
-  Shaded area indicates extent of floor finishes to be stripped out and removed. Areas of existing sub floor to be made good where required for new finishes. Existing skirting boards to be left intact.
-  Hatched area indicates extent ceiling to be removed.
-  Existing screed/slab depth removed to form new screeded floor to falls for 'Changing Place' shower drain.

NOTE:
Structural Engineer to review all wall and column demolitions and confirm details including any temporary propping requirements. Make good to all existing affected areas when demolishing

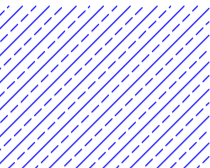
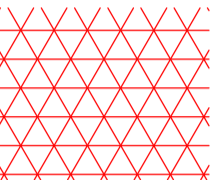
DO NOT SCALE FROM THIS DRAWING
EXCEPT FOR PLANNING PURPOSES ONLY
Copyright reserved

This drawing is issued for the sole & exclusive use of the named recipient. Distribution to any third party is on the strict understanding that no liability is accepted by YMD Boon Ltd for any discrepancies, errors or omissions that may be present & no guarantee is offered as to the accuracy of information shown. All dimensions to be checked on site & any discrepancies found shall be brought to the attention of YMD Boon Ltd prior to commencement of any building works.

THIS DRAWING IS TO BE READ IN COLOUR PRINT

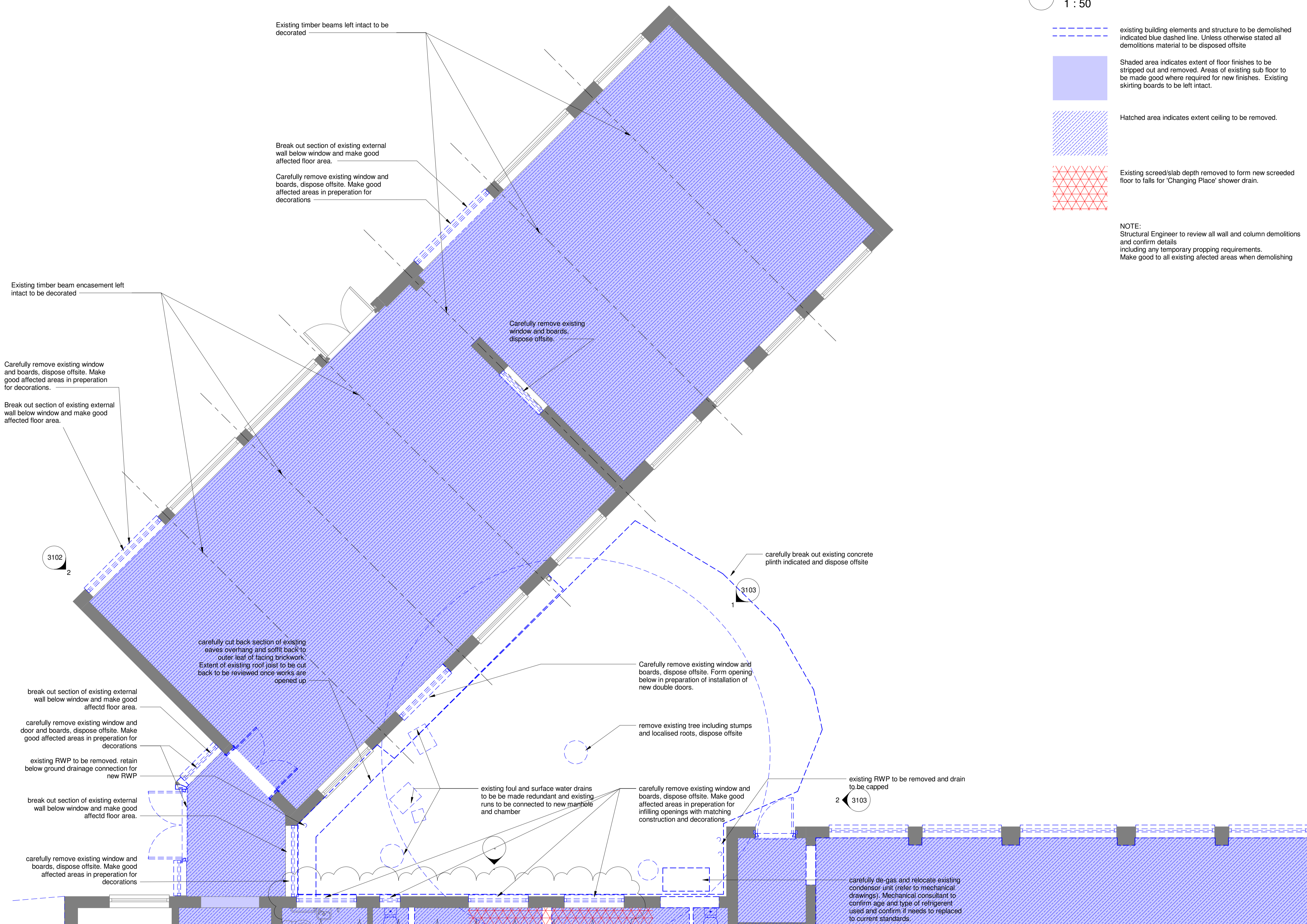

P3	Some existing ceilings and floor finishes now retained. Windows to be removed.	14.04.21	SD	SS
P2	Tender Issue	04.03.2021	SD	DY
P1	Preliminary tender issue	01.03.2021	SD	SS
Revision		Date	Drawn	Chk'd

TENDER ISSUE



6b Anson House, Compass Point Business Park
Market Harborough, LE16 9HW
Tel: 01858 464 482 Fax: 01858 467 604
12 Pride Point Drive, Pride Park, Derby, DE24 8BX
Tel: 01332 293 404 Email: enquiries@ymdboon.co.uk

Client
Cambridgeshire County Council

Project
Roger Ascham Library Depot Register Office Conversion

Scale 1 : 50	@A1	Date 01/09/20	Drawn SD
Drawing Title Existing Ground Floor Plan - Sheet 2 of 2	Checked SS	Drawing Number J4523-YMD-01-02-DR-A-2012	Revision P3