

**Appendix 10 Scaled Elevation (P5)**

**1 Tregonhayne Court, Tregonhayne, Tregony, Truro, TR2 5SE**

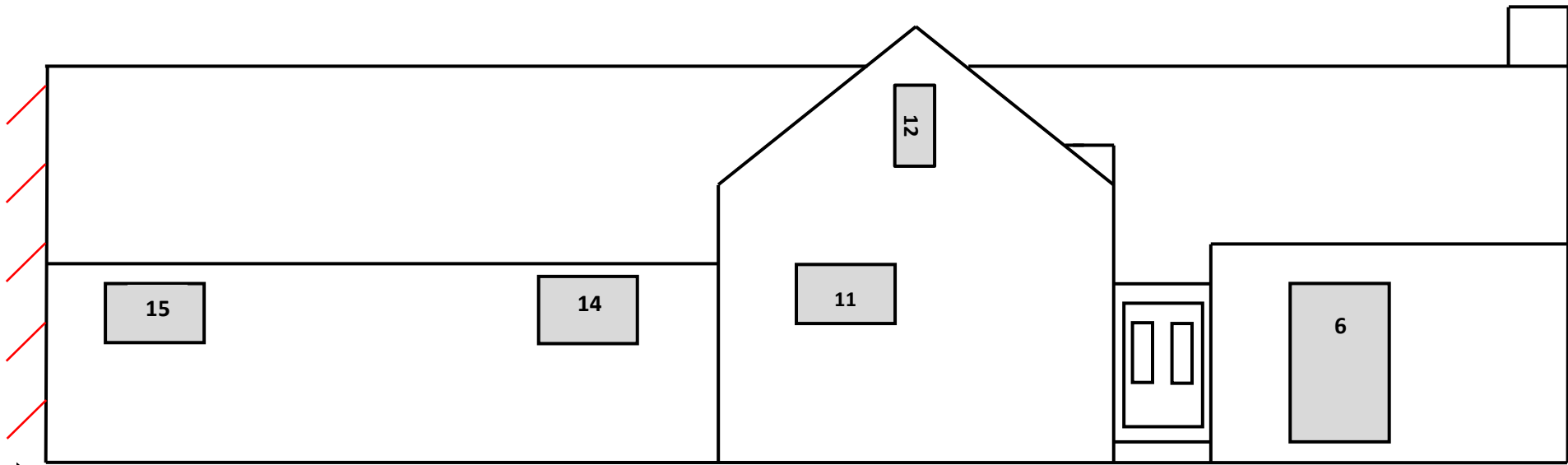
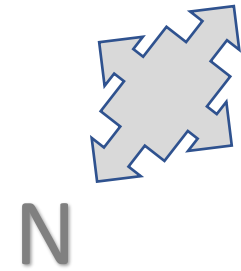

Existing and Proposed North Elevation 1:100

Adjoining Property  
2 Tregonhayne Court

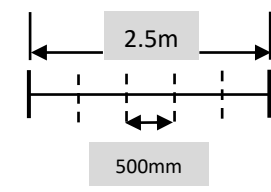

Note: The numbered windows correspond with the Levick & Jenkin Ltd quote (see Appendix 3)