

# SS&C – Increase of Car Parking spaces

Application No 18-00644 – FULL\_120718 - Phase plan

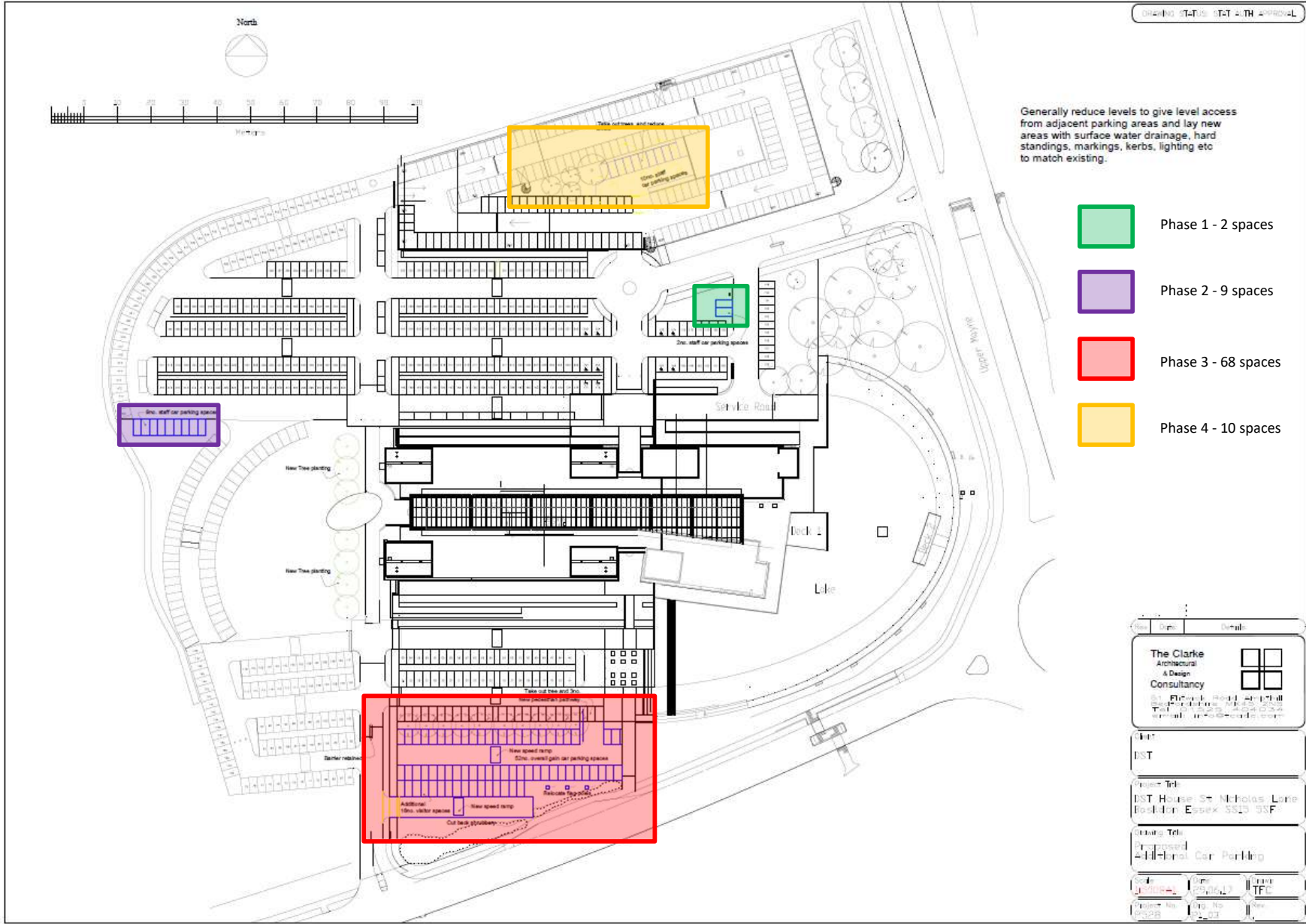

# Phase plan for planned works



# Phase 1 - Commencement

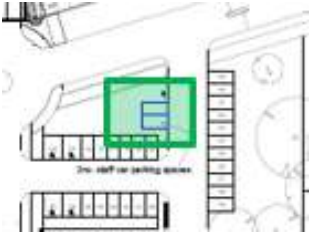

Phase 1 - 2 spaces

Commencement Date: Saturday 10<sup>th</sup> July 2021

Contractor: CBRE (Subcontracted)

Site overview pre works starting



Site overview post works starting



# Phase 1 – Contractor instruction



Date: 09/07/2021      Web Ref: 1008216  
Company: UK LFM      Customer: SS&C  
Contract No: CA002135 DST      Site: DST House  
CBRE      Contact: Mark Driscoll  
Contact: Jordan Ware      Telephone:  
Telephone:      Mobile:  
Mobile:      Email: mark.driscoll@uk.dstsystems.com  
Email: Jordan.Ware@cbre.com      Category: N/A  
Quote Type: Contract Extra      PO Number: 12100-0000006254  
Rating: [Not Set]

## RE: Phase one of the Basildon Car Park Expansion

Dear Mark Driscoll

Further to our recent survey of your requirements, we are pleased to forward our proposal for the works detailed below.

Description	Cost
Labour	£315.04
Sub-Contractor	£1,339.20
<b>Total (exc vat)</b>	<b>£1,654.24</b>
<b>Insurance 0 %</b>	<b>£0.00</b>
<b>Total (exc vat)</b>	<b>£1,654.24</b>

In relation to the car park extensions at the Basildon site and the agreement that this will be carried out in phases I am happy to present our costs for phase one of the project.  
Phase one  
This quote allows for two operatives to attend on Sat 10TH July, barrier off areas of works, (barriers to stay on site) x2 trades and plant to dig back the turf and bushes to leave exposed soil, all waste to be left neatly in a corner and site to be left tidy. Photos to be issued on completion of works.

Gaybank £1240.00  
CBRE 8% £99.20  
CBRE Labour £315.04

Total  
£1654.24

## Payment Terms

Our price is based on our Standard Terms and Conditions for Minor Works with all works being carried out during 'normal working hours' unless otherwise stated. Our quote is open to acceptance for a period of thirty days, thereafter subject to review. We trust the above is to your satisfaction; however should you require any further information please do not hesitate to contact us. Assuring you of our best attention at all times.  
Yours sincerely

Jordan Ware

- Initial work order issued by CBRE for the initial phase one operations to include preparations for removal of turf levels and planting to achieve sufficient levels for preparation of the surface for the spaces to be provisioned.
- Further quotations are being submitted for the remainder of these phase 1 works to facilitate the parking spaces to be available for employees.
- Phase 2, 3 & 4 will be commenced as demand for spaces increases post COVID return to office protocol
- Separate quotations will be provided for all phases of the works. SS&C reserve the right to conduct phased works in accelerated form if required



SMART PEOPLE  
SUPERB TECHNOLOGY

Mark Driscoll – [mark.driscoll@uk.sscinc.com](mailto:mark.driscoll@uk.sscinc.com)

#### Disclaimer

This material is intended for information purposes only, and is not to be relied upon as a forecast, research or tax, accounting, regulatory or investment advice.

This material does not constitute a recommendation, endorsement, referral or offer to sell or solicitation of an offer to buy or adopt an investment or other strategy. Readers should refer to their legal or financial advisers for review of the information contained herein. The enclosed material may contain sensitive, proprietary and confidential information. Please use every effort to safeguard the confidentiality of such material. SS&C does not warrant the accuracy nor completeness of this material. SS&C shall under no circumstances be liable for any damages arising out of or in connection with the reliance on the information contained herein. Readers should make their own assessment in light of the laws and regulations applicable to it. This material is not for redistribution.

SS&C Financial Services International Limited and SS&C Financial Services Europe Limited are trading as SS&C Global Investor and Distribution Solutions

Our trademarks and service marks and those of third party entities used in this material are the property of SS&C and their respective owners.

© 2021 SS&C