

©Crown copyright 2021  
 All rights reserved  
 VGH Licence Number 100045381

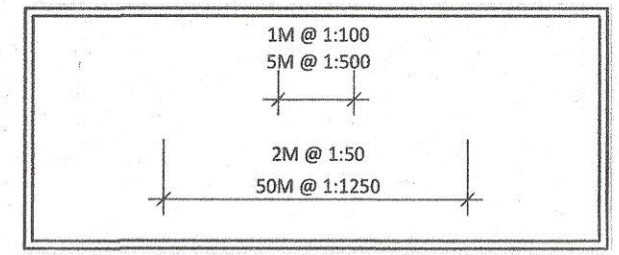

EXISTING (Block Plan) 1:500

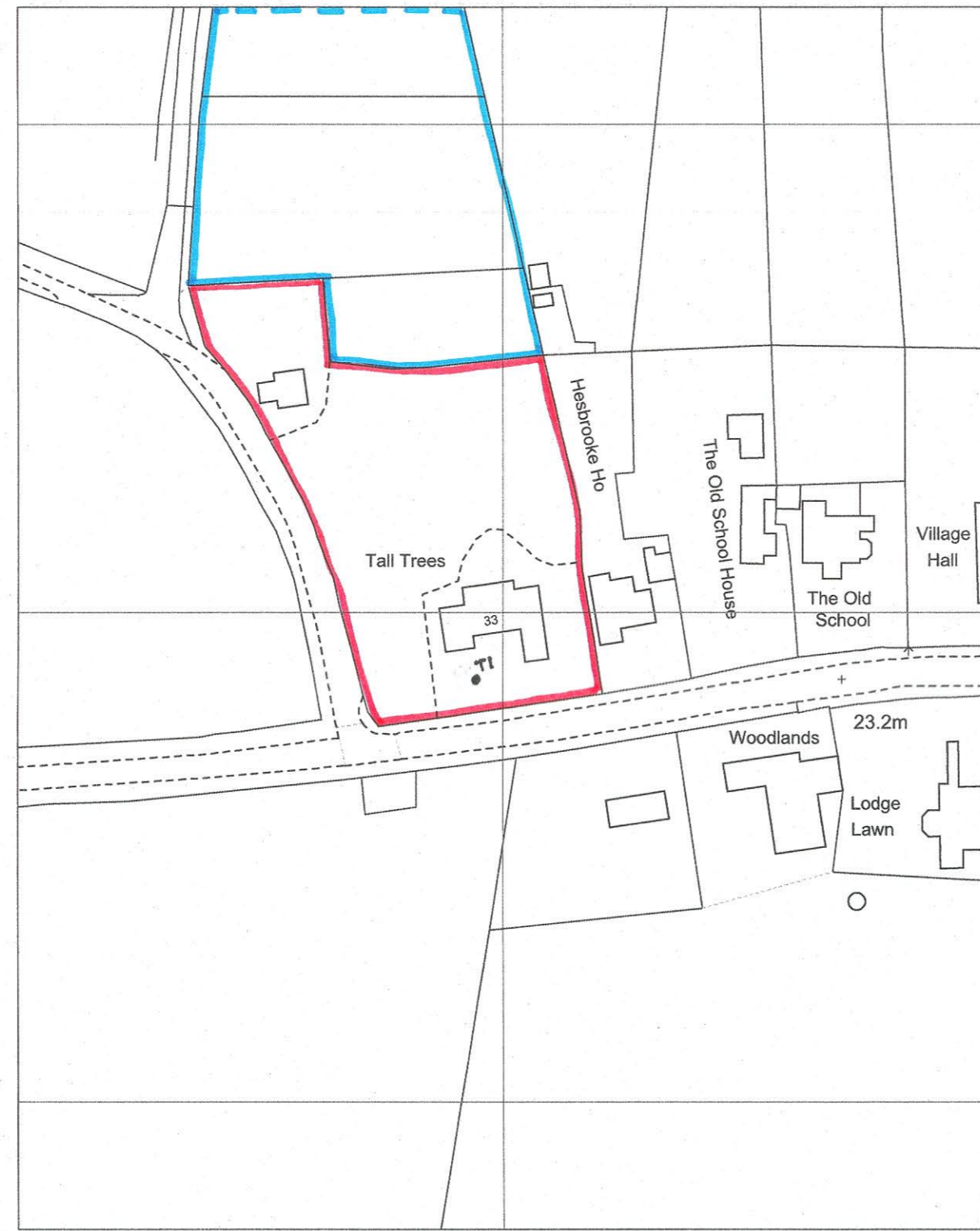
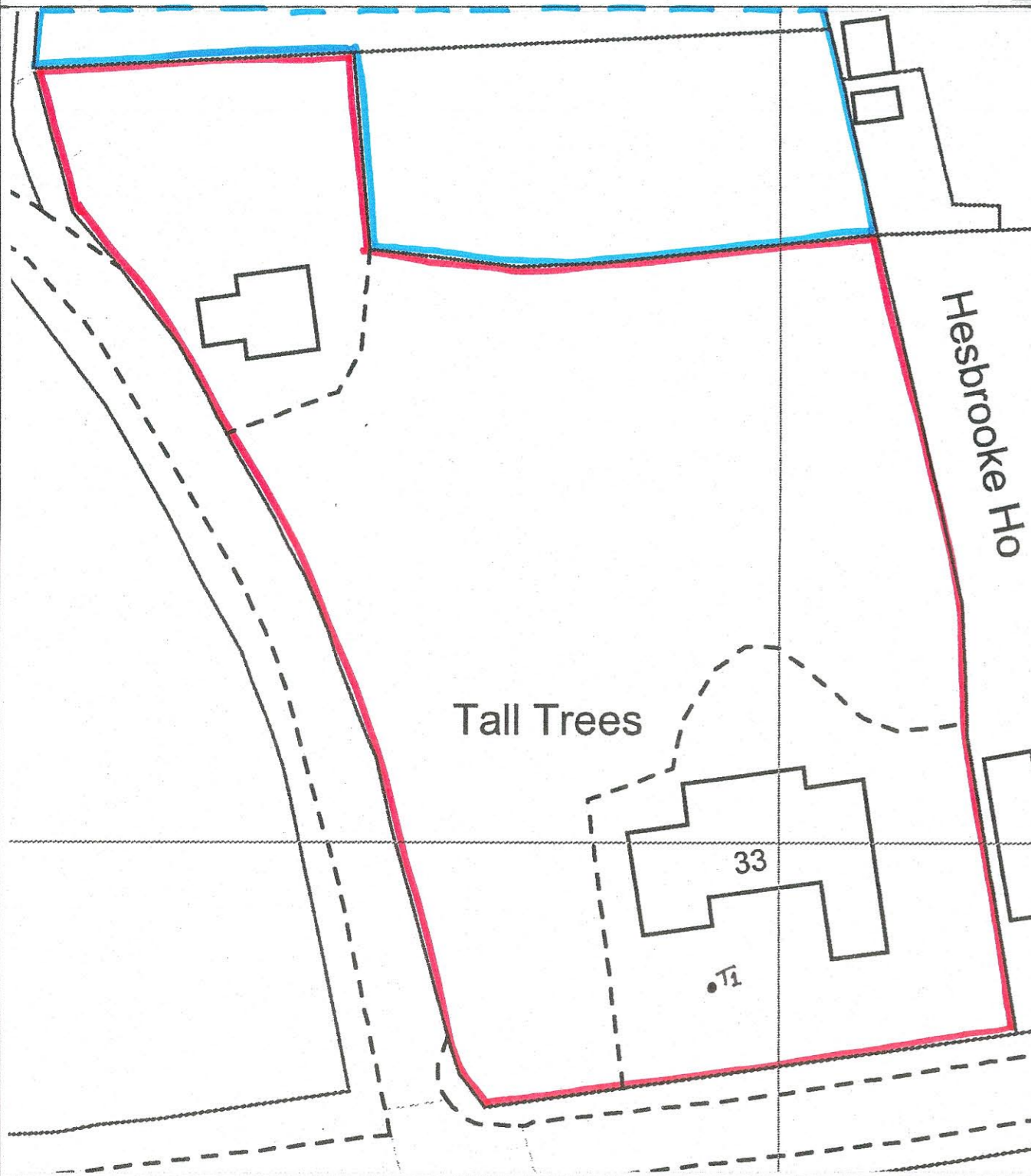

Proposed (Block Plan) @ 1:500

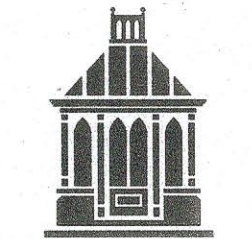
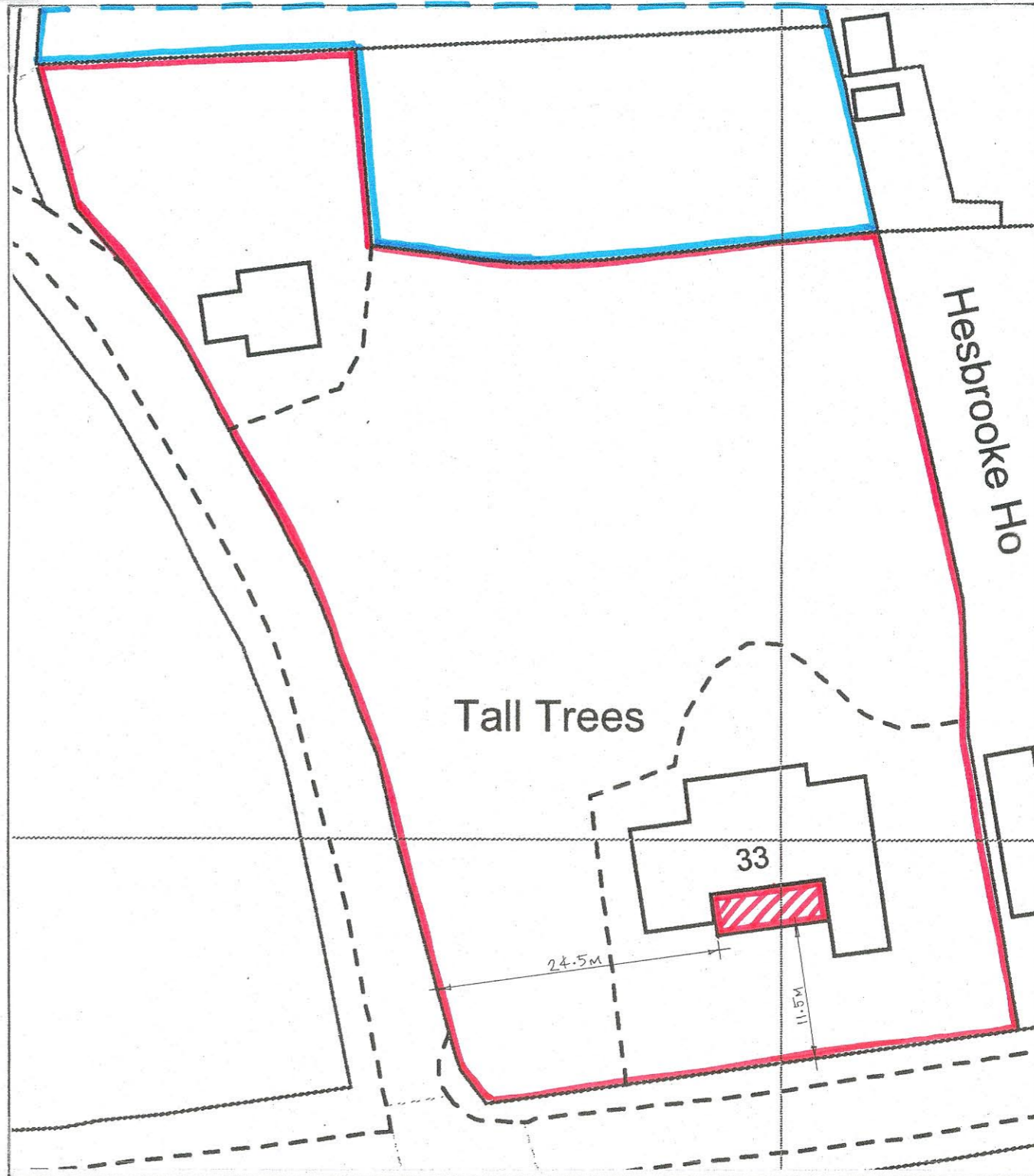

**VALE**  
 GARDEN  
 HOUSES  
 LTD

LONDONTHORPE ROAD  
 GRANTHAM  
 LINCOLNSHIRE, NG31 9SJ  
 TEL: 01476 564483 FAX: 01476 578555

NOTE:  
 BASEWORKS ARE TO BE SET OUT ONLY TO FOUNDATION DRAWINGS. CONTRACTORS AND ERECTORS MUST VERIFY ALL DIMENSIONS ON SITE BEFORE WORK COMMENCES.

THIS DRAWING, ITS DESIGN AND APPLICATION TO SITE, AND ITS COMPONENTS REMAINS THE PROPERTY OF VALE GARDEN HOUSES LTD. AND MAY NOT BE REPRODUCED IN ANY WAY WITHOUT PRIOR CONSENT

Rev	Date:	Details:

Client:  
 Mr. J. STIMPSON

Address:  
 "The Alices"  
 33 MAIN STREET,  
 FORTHEWAY  
 NORWICH, NORFOLK  
 NR8 5HZ

Scale: AS INDICATED Date: 5th July '21

Drawn By: Checked By:

Drawing:  
 Layout / Block Plans

Drawing No.  
 A20 13290 / P.