

- KEY**
- 25 Surface Water Lagoon
 - 26 Footpath
 - 27 Fire Water Tanks
 - 28 Waste Transfer Building with Roof Solar Panels
 - 29 CNG Filling Station
 - 30 HP Compressor
 - 31 Grid Entry Unit
 - 32 Propane Storage
 - 33 Emergency Flare
 - 34 Fire Water Tank / Emergency Leachate Storage
 - 35 Biofilter
 - 36 AD Building
 - 37 Dried Digestate Storage Area
 - 38 Digester
 - 39 Digester
 - 40 CHP and Stack
 - 41 Biogas Storage
 - 42 Biomethane Storage
 - 43 BUG
 - 44 Gas Boiler
 - 45 x2 Emergency Flares
 - 46 Healthcare Waste ERF and Stack
 - 47 Pellet Fertiliser Production Facility Building
 - 48 ETP
 - 49 Biomass Building with Roof Solar Panels
 - 50 x2 Stacks
 - 51 Existing Parking
 - 52 Proposed Parking

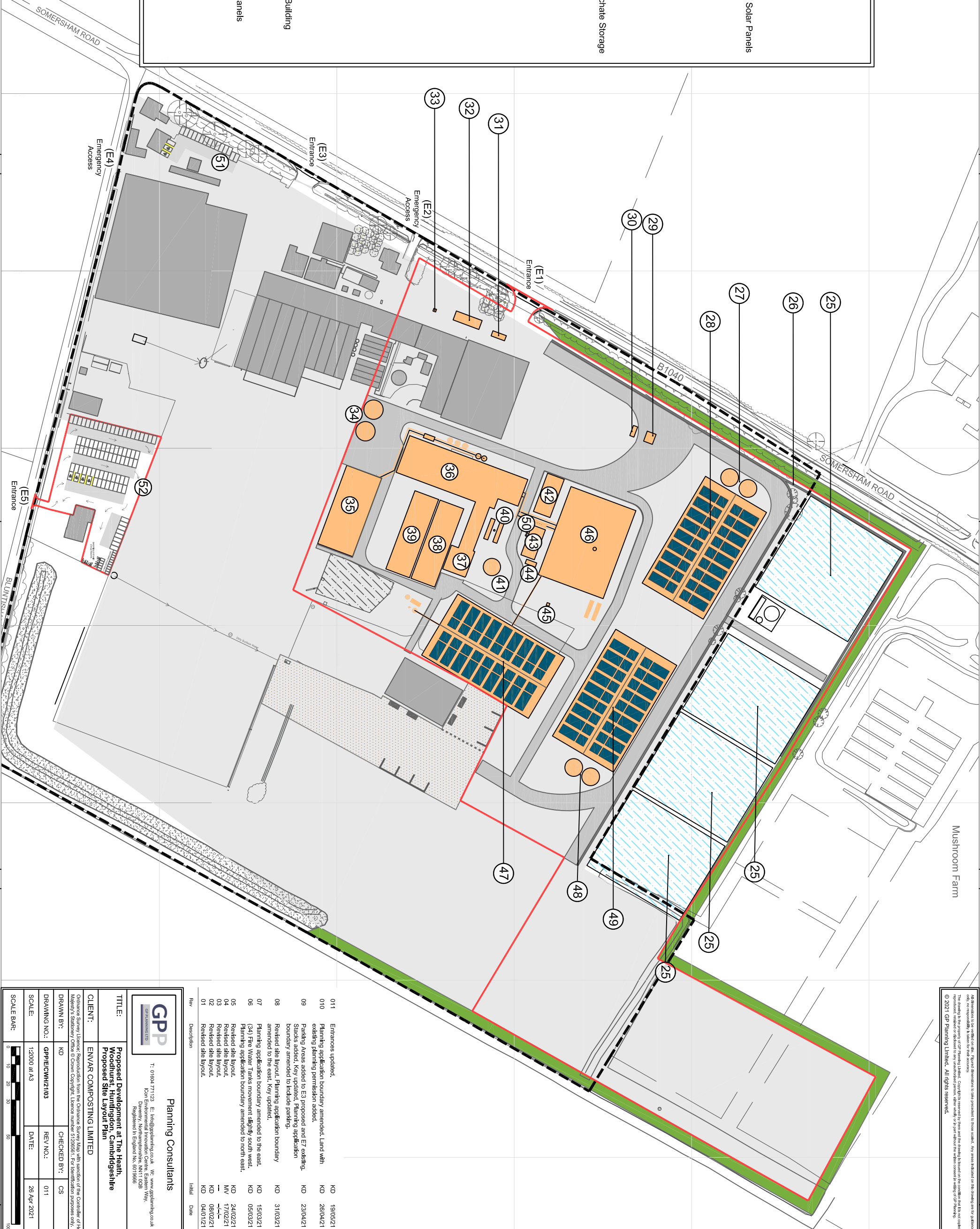

Mushroom Farm

All dimensions to be within 0.1% of stated dimensions to 100mm. Any areas indicated on this drawing are for guidance only and are not intended to be used for construction purposes.
 This drawing is the property of GPP Planning Limited. Copyright is reserved by GPP Planning Limited on the content and the use of this drawing. No part of this drawing may be reproduced, stored in a retrieval system, or transmitted in any form or by any means, electronic, mechanical, photocopying, recording, or by any information storage and retrieval system, without the prior written permission of GPP Planning Limited. All rights reserved.
 © 2021 GPP Planning Limited. All rights reserved.

| Rev | Description | Issued | Date |
|------|--|--------|----------|
| 0111 | Entrances updated. | KD | 19/05/21 |
| 0110 | Planning application boundary amended. Land with existing planning permission added. | KD | 28/04/21 |
| 09 | Parking Areas added to E3 proposed and E7 existing. Stacks added. Key updated. Planning application boundary amended to include parking. | KD | 23/04/21 |
| 08 | Revised site layout. Planning application boundary amended to the east. Key updated. | KD | 31/03/21 |
| 07 | Planning application boundary amended to the east. | KD | 15/03/21 |
| 06 | (34) Fire Water Tanks movement slightly south west. Planning application boundary amended to north east. | KD | 05/03/21 |
| 05 | Revised site layout. | KD | 24/02/21 |
| 04 | Revised site layout. | MV | 17/02/21 |
| 03 | Revised site layout. | KD | 08/02/21 |
| 02 | Revised site layout. | KD | 04/01/21 |
| 01 | Revised site layout. | KD | 04/01/21 |

GPP
 Planning Consultants

T: 01604 771123 E: info@gppplanning.co.uk W: www.gppplanning.co.uk
 Icon Environmental Innovation Centre, E1028
 Registered in England No. 6719856

TITLE:
**Proposed Development at The Heath,
 Woodhurst, Huntingdon, Cambridgeshire
 Proposed Site Layout Plan**

CLIENT:
 ENVAR COMPOSTING LIMITED

DRAWN BY:
 KD

CHECKED BY:
 CS

DRAWING NO.:
 GPP/ECWH/21/03

REV NO.:
 011

SCALE:
 1:2000 at A3

DATE:
 26 Apr 2021

SCALE BAR:
 0 10 20 30 50 100

ORIGINAL A3 SITE SHEET