

Scale 1:100

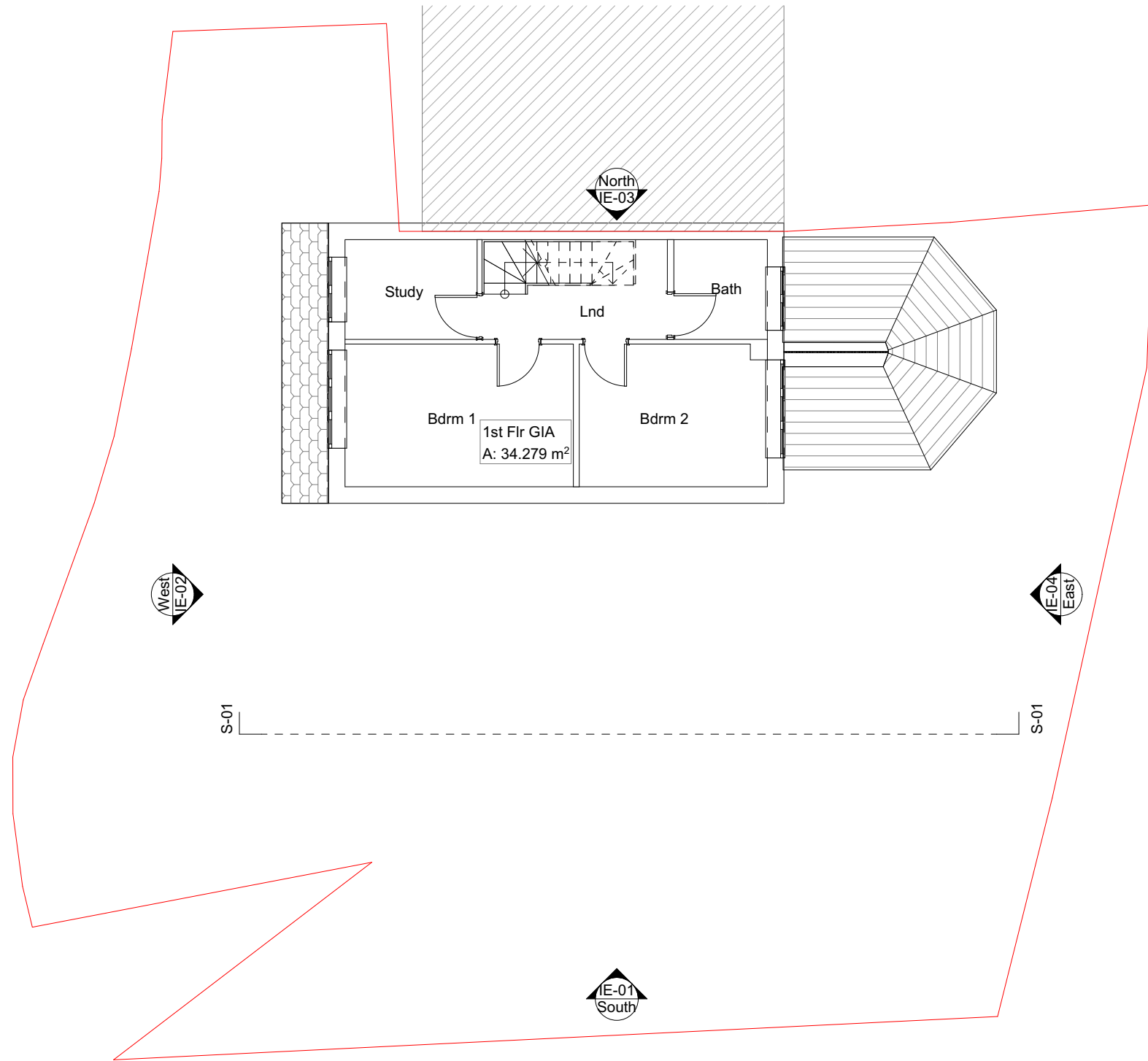

Existing 1ST FLR
1:100

The material used in any exterior works is to be of a similar appearance to those used in the construction of the existing dwelling house



This Drawing is © to Homefront Architecture LTD © 2020. This drawing may not be copied by any third parties without prior written permission. This drawing is prepared for the purpose of obtaining planning permission or Building Regulations approval or as stated in the 'Drawing Status Box' only and not intend for any other use, do not constitute as full working drawings. All construction work carried out prior to receiving all necessary approvals for planning/or building regulations is entirely at the householders / Client risk. All building work to be completed to the satisfaction of the local authority building control officer and in accordance with current building regulations and as such additional unforeseen building works may be required on site. Copies from this drawing are not to be scaled. All dimension in millimeters. This drawing is to be scaled. All details to be verified and dimensions to be checked on site by the contractor prior to commencement of work. All omissions and discrepancies to be reported to Admin@homefront3darchitecturedesigns immediately. The contractor shall inspect all adjoining properties which may be affected by the works and record and report to the owner and defects. The contractor shall be entirely responsible for the security, strength and stability of the building during the course of the works

Applicant Mr Bogdan Malaniuc	Site Address 2 Somerford Way SE16 6QW	Drawing Status Planning	Scale at 1:100								
Project Description 5 person 4bed new dwelling house with double rear projecting dormer	Application Full Plans	Drawing Description Existing 1st Flr	Print at A3	Drawing Number							
			Issue Date July 2021	project	originator	zone	level	type	role	number	rev
				PL.8						A	