

- Note:-**
- All dimensions indicated are approximate and are for guidance purposes only. Actual dimensions should be checked on site.
 - Contractor to assume design responsibility under CDM2015.
 - For proposed Elevations see drawing 2019/111-005
 - For proposed block plan see drawing 2029/111-003

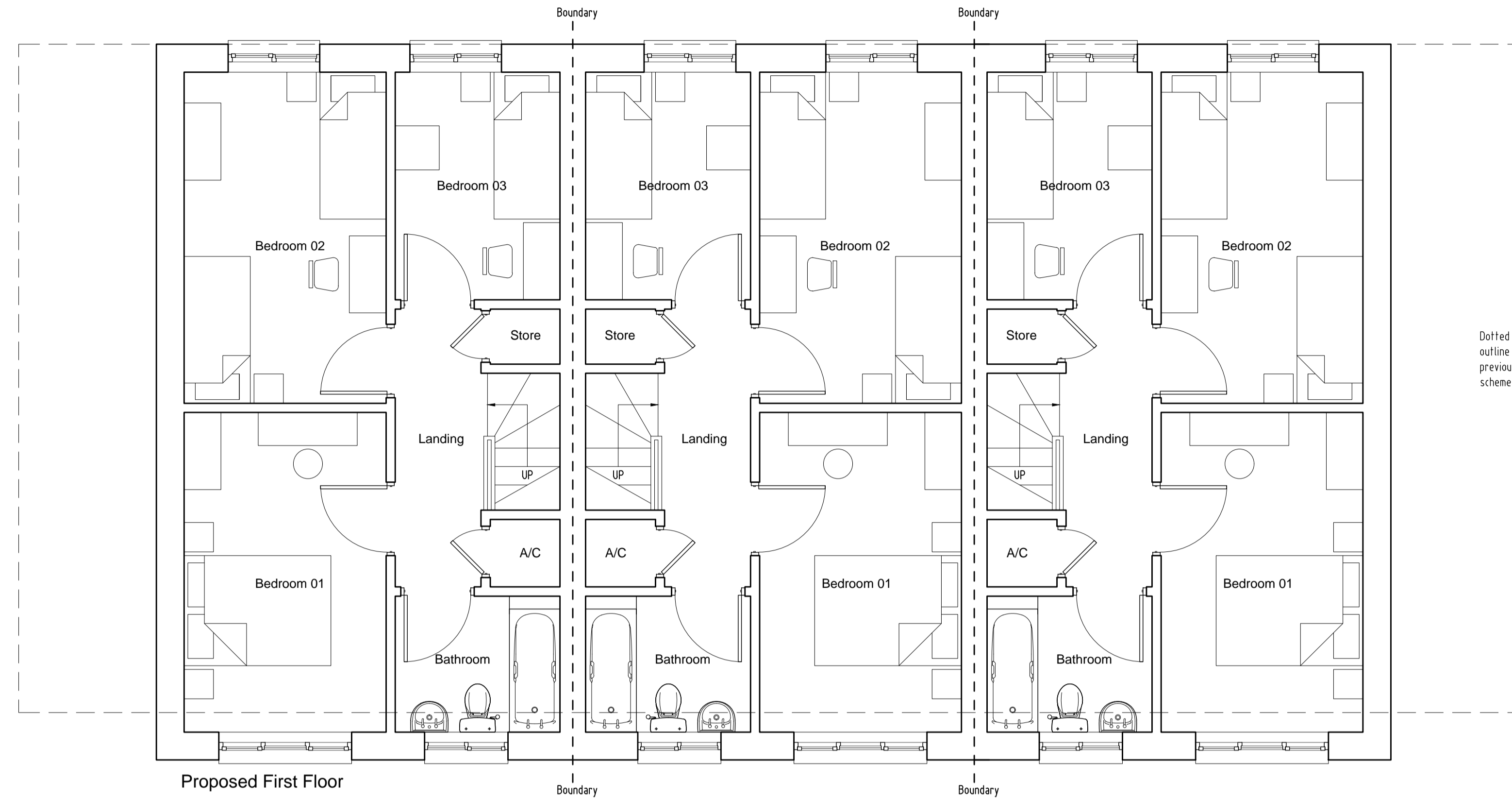

C4.1.1 All housing developments should meet the minimum floor space standards set out in Table 3.1 of the London Plan below:

Number of bedrooms (b)	Number of bed spaces (persons (p))	Minimum gross internal floor areas and storage (sqm)			
		1 storey dwellings	2 storey dwellings	3 storey dwellings	Built in storage
1b	1p	39 (37)*			1
	2p	50	2b	2b	1.5
2b	3p	61	1b	1b	2
	4p	70	1b	1b	
3b	4p	74	1b	1b	2.5
	5p	86	1b	1b	
	6p	95	1b	1b	
4b	5p	90	1b	1b	3
	6p	99	1b	1b	
	7p	108	1b	1b	
	8p	117	1b	1b	
5b	6p	103	1b	1b	3.5
	7p	112	1b	1b	
	8p	121	1b	1b	
6b	7p	116	123	129	4
	8p	125	132	138	

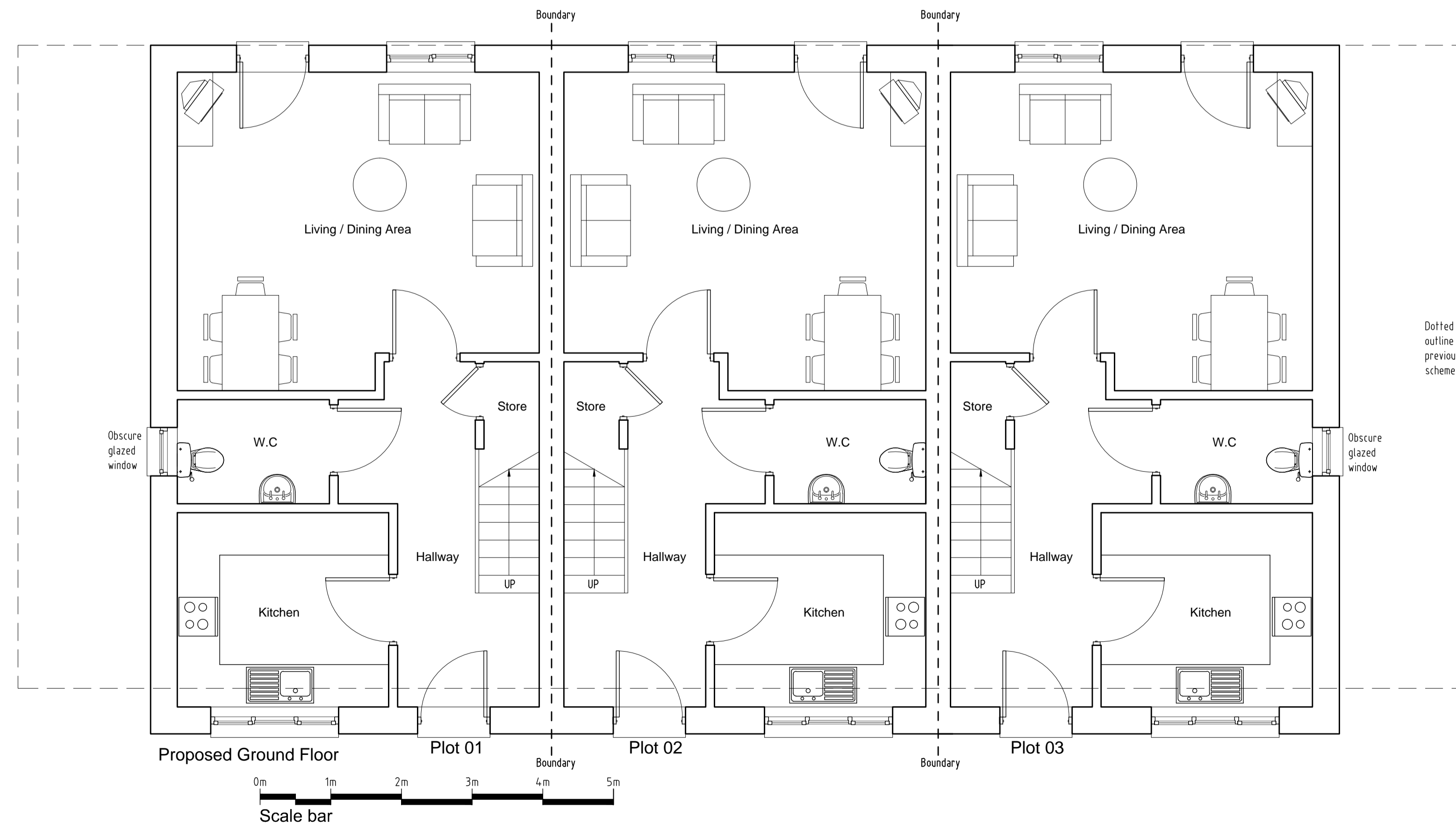

A	Drawing updated following planners advice	13.05.21			
REV	DESCRIPTION	DATE	INT	CHKD	
	STATUS	FOR INFORMATION			

Client
Mr J Kennard

Project
**83 Colyers Lane, Erith,
Kent. DA8 3NG**

Title
Proposed Floor Plans

Scale	Date	Drawn	Checked
1:50@A1	03.03.20	N/A	N/A
Project No:	Drawing No.	Revision	
2019-111	004	A	