

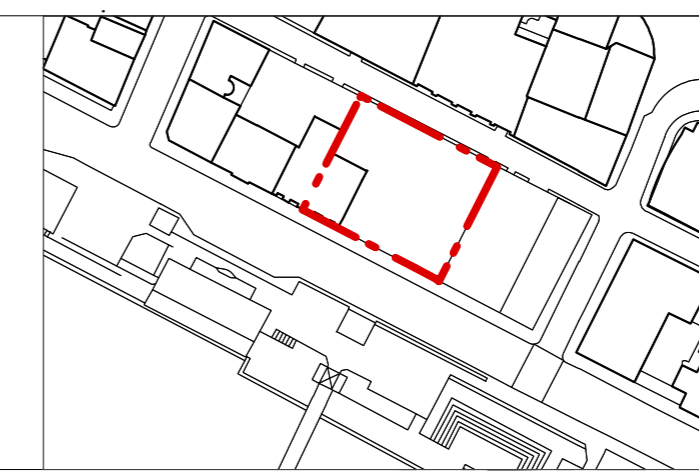

ALL DIMENSIONS TO BE CHECKED ON SITE PRIOR TO MANUFACTURE.

Revisions		
A	11/06/2021	Issued for Planning



Client	Silk (Clyde 3) Ltd	
Project	Virgin Hotels 236-246, Clyde Street, Glasgow, G1 4JH	
Drawing Title	Existing Approved Side Elevation	

 Twenty First Architecture Ltd, 314 Goswell Road, London, EC1V 7AF Tel: +44(0)20 7952 0252 www.21starchitecture.com	Status	Planning	Drawn	DD	Checked	RD
	Scale	1:50@A3 1:25@A2		Date	Jun 2021	
Drwg. No.	310_PL3_EX_05		Revision	A		

Information contained within this drawing is the sole copyright of 21st Architecture Ltd. and is not to be reproduced without express permission. No implied licence exists. This drawing not to be used for land transfer or valuation purposes. Do not scale from this drawing. All dimensions & levels are to be checked on site by the contractor. Issued for purposes indicated only. Drawing errors and omissions to be reported to the architect.