

**WALL FINISHES NOTES**

1. UNDESIRABLE MOISTURE, INTERNALS, EXTERNAL SURFACES, FIXTURES & FITTINGS WHICH ARE NOT TO BE COATED, BY COVERING WITH DUST SHEETS, MASKING OR OTHER SUITABLE MATERIALS.

2. EXISTING WET PAINT SHOULD BE REMOVED WHERE NECESSARY TO PROTECT OTHER OPERATIONS & THE SURFACE TO BE COATED.

3. BEFORE COMMENCING WORK, CAREFULLY TACK DOWN & SET AROUND ALL FINISHES & FITTINGS LIABLE TO BE AFFECTED FOR SETTING.

4. REMOVE ANY RESIDUES FROM SURFACES TO BE COATED & KEEP ON COMPLETION. FINISHES TO BE REMOVED AS NECESSARY & RETURNED WITHIN 48 HOURS.

5. PAINT FINISHES TO SETTING, DOORS & INTERNAL EXPOSED SOFTWOOD ELEMENTS.

**PREPARATION**

1. ALL PREPARATION GENERALLY TO BE TO BS 6150, PART 4.

2. MATERIALS USED IN PREPARATION MUST BE TYPES RECOMMENDED BY THEIR MANUFACTURERS & THE COATING MANUFACTURERS FOR THE SITUATION & SURFACES BEING PREPARED.

3. SURFACES TO BE COATED TO BE PROTECTED BY COVERING WITH DUST SHEETS, MASKING OR OTHER SUITABLE MATERIALS.

4. REMOVE ANY EFFLORESCENCE SALTS FROM SURFACES. REPAIR REMOVAL IF EFFLORESCENCE OCCURS. CLEAN OFF DIRT, GREASE & OIL FROM SURFACES. IF CONTAMINATION OF SURFACES BY OILS/RESIDUES HAS OCCURRED, OBTAIN QUOTE FROM SPECIALIST RESTORATION CONTRACTORS FOR REMOVAL OF SURFACES BY OILS/RESIDUES.

5. SURFACES TO BE COATED TO BE PROTECTED BY COVERING WITH DUST SHEETS, MASKING OR OTHER SUITABLE MATERIALS.

6. REMOVE ANY RESIDUES FROM SURFACES TO BE COATED & KEEP ON COMPLETION. FINISHES TO BE REMOVED AS NECESSARY & RETURNED WITHIN 48 HOURS.

7. REMOVE ANY DUST & PARTICLES FROM ROOF ABOVE PREPARATION OF SURFACES BY OILS/RESIDUES.

8. REMOVE ANY RESIDUES FROM SURFACES TO BE COATED & KEEP ON COMPLETION. FINISHES TO BE REMOVED AS NECESSARY & RETURNED WITHIN 48 HOURS.

9. REMOVE ANY RESIDUES FROM SURFACES TO BE COATED & KEEP ON COMPLETION. FINISHES TO BE REMOVED AS NECESSARY & RETURNED WITHIN 48 HOURS.

10. WHERE COATINGS ARE COMPLETELY REMOVED, PREPARE SURFACES AS SPECIFIED FOR UNCOATED SURFACES.

**PREPARATION OF PREVIOUSLY COATED SURFACES**

1. PREPARE IN ACCORDANCE WITH BS 6150, PART 6.

2. WHERE COATINGS ARE COMPLETELY REMOVED, PREPARE SURFACES AS SPECIFIED FOR UNCOATED SURFACES.

3. REMOVE ANY RESIDUES FROM SURFACES TO BE COATED & KEEP ON COMPLETION. FINISHES TO BE REMOVED AS NECESSARY & RETURNED WITHIN 48 HOURS.

4. REMOVE ANY RESIDUES FROM SURFACES TO BE COATED & KEEP ON COMPLETION. FINISHES TO BE REMOVED AS NECESSARY & RETURNED WITHIN 48 HOURS.

5. REMOVE ANY RESIDUES FROM SURFACES TO BE COATED & KEEP ON COMPLETION. FINISHES TO BE REMOVED AS NECESSARY & RETURNED WITHIN 48 HOURS.

6. REMOVE ANY RESIDUES FROM SURFACES TO BE COATED & KEEP ON COMPLETION. FINISHES TO BE REMOVED AS NECESSARY & RETURNED WITHIN 48 HOURS.

7. REMOVE ANY RESIDUES FROM SURFACES TO BE COATED & KEEP ON COMPLETION. FINISHES TO BE REMOVED AS NECESSARY & RETURNED WITHIN 48 HOURS.

8. REMOVE ANY RESIDUES FROM SURFACES TO BE COATED & KEEP ON COMPLETION. FINISHES TO BE REMOVED AS NECESSARY & RETURNED WITHIN 48 HOURS.

9. REMOVE ANY RESIDUES FROM SURFACES TO BE COATED & KEEP ON COMPLETION. FINISHES TO BE REMOVED AS NECESSARY & RETURNED WITHIN 48 HOURS.

10. WHERE COATINGS ARE COMPLETELY REMOVED, PREPARE SURFACES AS SPECIFIED FOR UNCOATED SURFACES.

**PREPARATION OF WEATHERED SURFACE TIMBER BY SANDING DOWN SURFACE**

1. REMOVE ANY DEBRIS OR WEATHERED SURFACE TIMBER BY SANDING DOWN SURFACE.

2. REMOVE ANY DEBRIS OR WEATHERED SURFACE TIMBER BY SANDING DOWN SURFACE.

3. REMOVE ANY DEBRIS OR WEATHERED SURFACE TIMBER BY SANDING DOWN SURFACE.

4. REMOVE ANY DEBRIS OR WEATHERED SURFACE TIMBER BY SANDING DOWN SURFACE.

5. REMOVE ANY DEBRIS OR WEATHERED SURFACE TIMBER BY SANDING DOWN SURFACE.

6. REMOVE ANY DEBRIS OR WEATHERED SURFACE TIMBER BY SANDING DOWN SURFACE.

7. REMOVE ANY DEBRIS OR WEATHERED SURFACE TIMBER BY SANDING DOWN SURFACE.

8. REMOVE ANY DEBRIS OR WEATHERED SURFACE TIMBER BY SANDING DOWN SURFACE.

9. REMOVE ANY DEBRIS OR WEATHERED SURFACE TIMBER BY SANDING DOWN SURFACE.

10. WHERE COATINGS ARE COMPLETELY REMOVED, PREPARE SURFACES AS SPECIFIED FOR UNCOATED SURFACES.

**PREPARATION OF UNCOATED TIMBER**

1. SAND DOWN TO A SMOOTH, EVEN FINISH WITH ARRISSES & MOLDING EDGES LIGHTLY ROUNDED OR FLALED.

2. REMOVE ANY DEBRIS OR WEATHERED SURFACE TIMBER BY SANDING DOWN SURFACE.

3. REMOVE ANY DEBRIS OR WEATHERED SURFACE TIMBER BY SANDING DOWN SURFACE.

4. REMOVE ANY DEBRIS OR WEATHERED SURFACE TIMBER BY SANDING DOWN SURFACE.

5. REMOVE ANY DEBRIS OR WEATHERED SURFACE TIMBER BY SANDING DOWN SURFACE.

6. REMOVE ANY DEBRIS OR WEATHERED SURFACE TIMBER BY SANDING DOWN SURFACE.

7. REMOVE ANY DEBRIS OR WEATHERED SURFACE TIMBER BY SANDING DOWN SURFACE.

8. REMOVE ANY DEBRIS OR WEATHERED SURFACE TIMBER BY SANDING DOWN SURFACE.

9. REMOVE ANY DEBRIS OR WEATHERED SURFACE TIMBER BY SANDING DOWN SURFACE.

10. WHERE COATINGS ARE COMPLETELY REMOVED, PREPARE SURFACES AS SPECIFIED FOR UNCOATED SURFACES.

**STAINING TIMBER**

1. APPLY PRIMER WHERE RECOMMENDED BY THE STAIN MANUFACTURER.

2. APPLY STAIN IN FLOWING COATS, BRUSH OUT EXCESS STAIN BEFORE SET TO PRODUCE UNIFORM DEPTH OF COLOUR.

3. REMOVE ANY EXCESS STAIN BEFORE SET TO PRODUCE UNIFORM DEPTH OF COLOUR.

4. REMOVE ANY EXCESS STAIN BEFORE SET TO PRODUCE UNIFORM DEPTH OF COLOUR.

5. REMOVE ANY EXCESS STAIN BEFORE SET TO PRODUCE UNIFORM DEPTH OF COLOUR.

6. REMOVE ANY EXCESS STAIN BEFORE SET TO PRODUCE UNIFORM DEPTH OF COLOUR.

7. REMOVE ANY EXCESS STAIN BEFORE SET TO PRODUCE UNIFORM DEPTH OF COLOUR.

8. REMOVE ANY EXCESS STAIN BEFORE SET TO PRODUCE UNIFORM DEPTH OF COLOUR.

9. REMOVE ANY EXCESS STAIN BEFORE SET TO PRODUCE UNIFORM DEPTH OF COLOUR.

10. WHERE COATINGS ARE COMPLETELY REMOVED, PREPARE SURFACES AS SPECIFIED FOR UNCOATED SURFACES.

**WALLPAPER HANGING**

1. THINK FIRST COAT WITH WHITE SPIRIT IN ACCORDANCE WITH MANUFACTURERS RECOMMENDATIONS. BRUSH WELL IN AROUND JOINTS & IN GUTS.

2. REMOVE ANY EXCESS STAIN BEFORE SET TO PRODUCE UNIFORM DEPTH OF COLOUR.

3. REMOVE ANY EXCESS STAIN BEFORE SET TO PRODUCE UNIFORM DEPTH OF COLOUR.

4. REMOVE ANY EXCESS STAIN BEFORE SET TO PRODUCE UNIFORM DEPTH OF COLOUR.

5. REMOVE ANY EXCESS STAIN BEFORE SET TO PRODUCE UNIFORM DEPTH OF COLOUR.

6. REMOVE ANY EXCESS STAIN BEFORE SET TO PRODUCE UNIFORM DEPTH OF COLOUR.

7. REMOVE ANY EXCESS STAIN BEFORE SET TO PRODUCE UNIFORM DEPTH OF COLOUR.

8. REMOVE ANY EXCESS STAIN BEFORE SET TO PRODUCE UNIFORM DEPTH OF COLOUR.

9. REMOVE ANY EXCESS STAIN BEFORE SET TO PRODUCE UNIFORM DEPTH OF COLOUR.

10. WHERE COATINGS ARE COMPLETELY REMOVED, PREPARE SURFACES AS SPECIFIED FOR UNCOATED SURFACES.

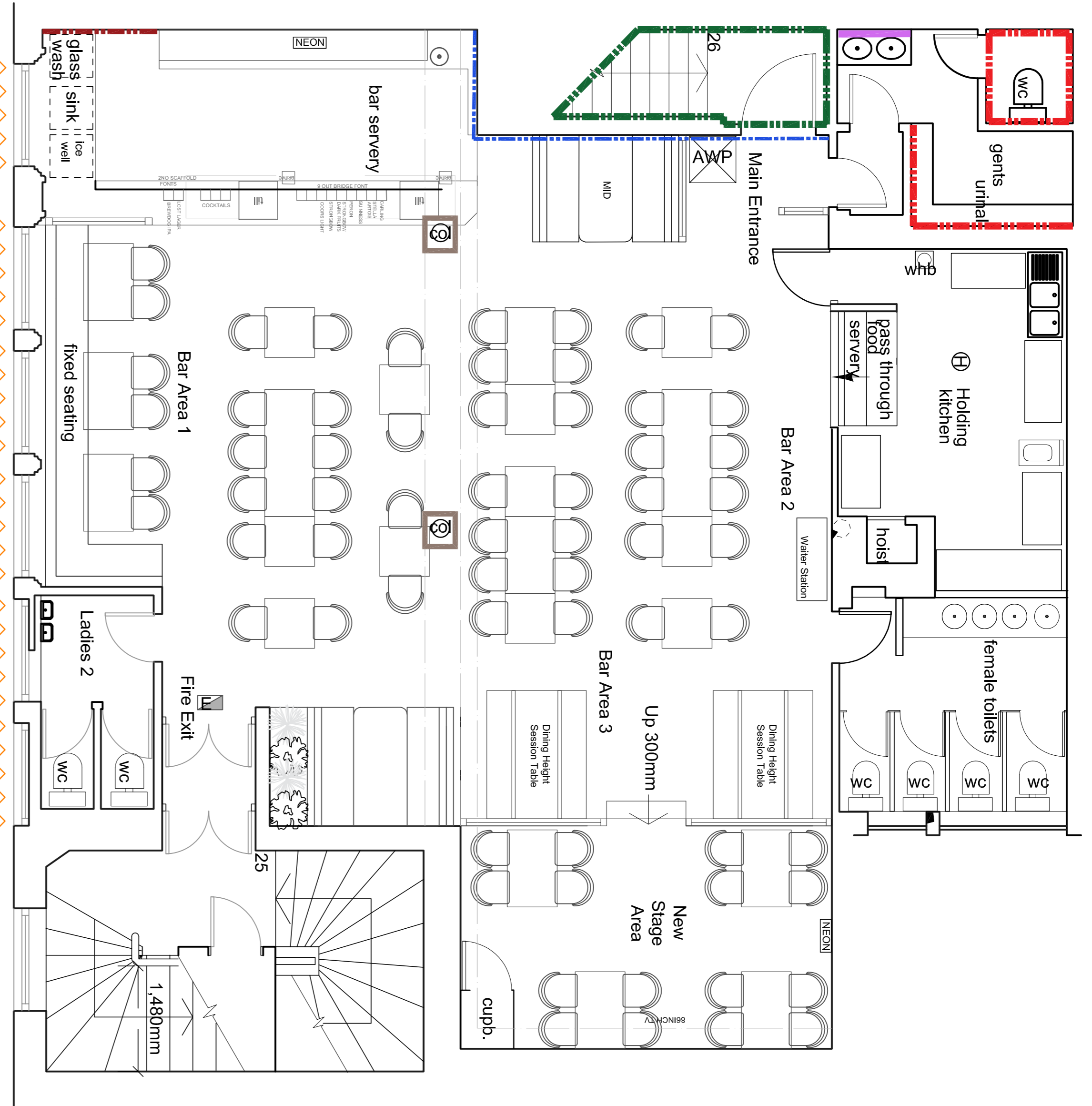
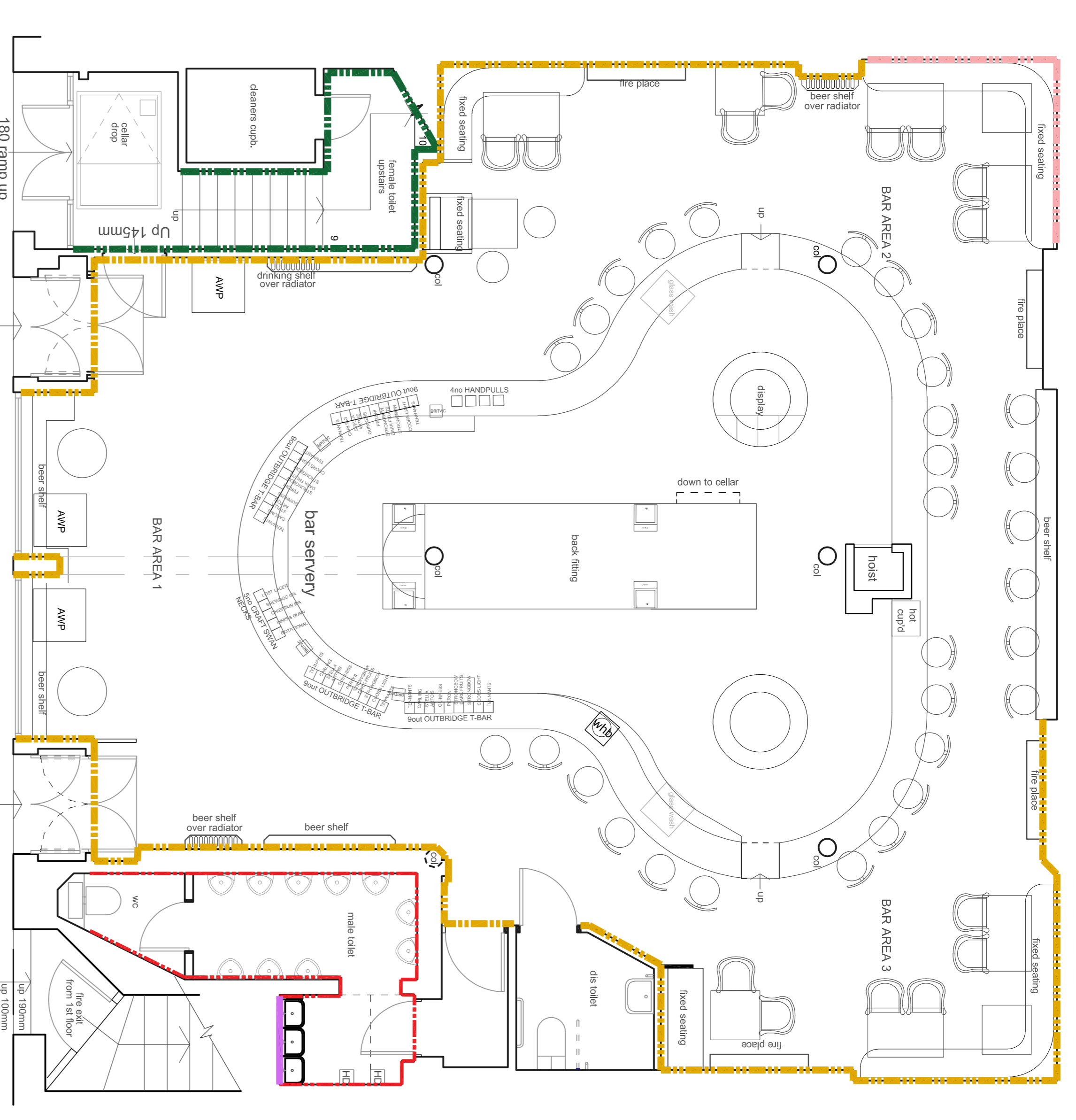

**WALL FINISHES KEY**  
 WHERE TWO FINISHES ARE SHOWN TOGETHER, SYMBOL CLOSEST TO WALL INDICATES LOWER FINISH (E.G. TO DADO), WHERE NO FINISH IS INDICATED WALLS ARE TO BE PAINTED IN DULUX DIAMOND MATT EMULSION. JMDA TO PRODUCE MARKED UP DRAWING INDICATING FINISHES.

**RETAIN EXISTING ANTIQUE CLAD MIRROR & REMOVE EXISTING VINYL'S TO MIRROR & MAKE GOOD.**

**EXISTING COLUMNS TO RECEIVE GLOSS PAINT COLOUR TO BE SPECIFIED BY JMDA**

**RETAI ALL EXISTING MIRRORED PANELS.**

**MC TO REMOVE EXISTING TEXTURE WALLPAPER TO WALLS & FRESH WALLS FOR NEW FEATURE DECORATIVE WALLPAPER TO WALLS ONLY**

**WALLPAPER REFERENCE: STYLE LIBRARY WILLIAM MORRIS SNAKESHEAD 21 6425 CHARCOAL/SPICE**

**GROUT REF: MAPEL 114 ANTHRACITE**

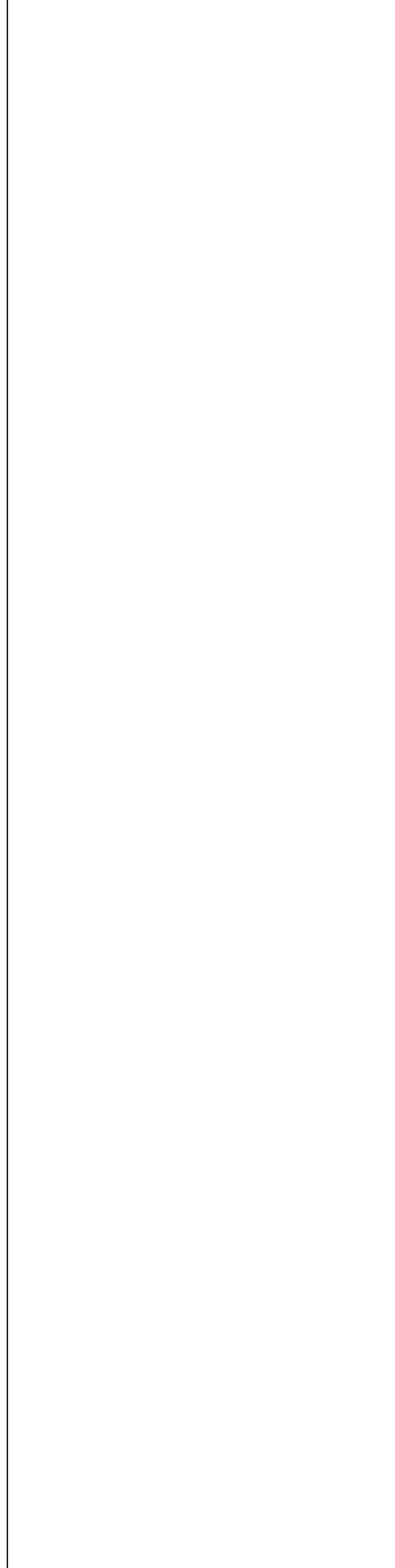

JOB TITLE	DATE	SCALE	DRAWING NO.
MITCHELLS & BUTLERS THE HORSE SHOE BAR GLASGOW	22.11.19	1:50 @ A1	JMDA 1486/105B
DRAWING TITLE: PROPOSED WALL FINISHES / CURTAINS			
NOTE: THIS DRAWING TO BE PRINTED IN COLOUR FOR CLARITY			
DRAWN BY: ES		DRAWING NO: JMDA 1486/105B	