

ALL DIMENSIONS, LEVELS AND CLEARANCES TO BE CHECKED ON SITE PRIOR TO WORKS COMMENCING.
 THIS DRAWING SHOULD BE READ IN CONJUNCTION WITH ALL OTHER PROJECT RELATED DRAWINGS, SPECIFICATIONS AND DOCUMENTS AS PART OF A SINGLE PROJECT PACKAGE.
 ANY DISCREPANCY BETWEEN THIS DRAWING, OTHER DRAWINGS FORMING PART OF THIS CONTRACT, OR THE SPECIFICATIONS, SHALL BE QUANTIFIED MUST BE CLARIFIED BEFORE COMMENCEMENT OF ANY WORK OR ORDERING OF ANY MATERIALS.
 PLEASE CONSULT THE AUTHOR OR PROJECT MANAGER SHOULD THE READER REQUIRE CLARIFICATION ON ANY PART OF THIS DRAWING.
 THE COPYRIGHT OF THE DRAWING AND DESIGN IS THE PROPERTY OF THE COMPANY. THIS INFORMATION HAS BEEN ISSUED UNDER SPECIFIC TERMS FOR THIS PROJECT AND MAY ONLY BE USED AND REPRODUCED ACCORDINGLY.

NOTES

- LEGEND:
- SOLAR PANEL NEW (TYPICAL)
 - SOLAR PANEL EXISTING LOCATION

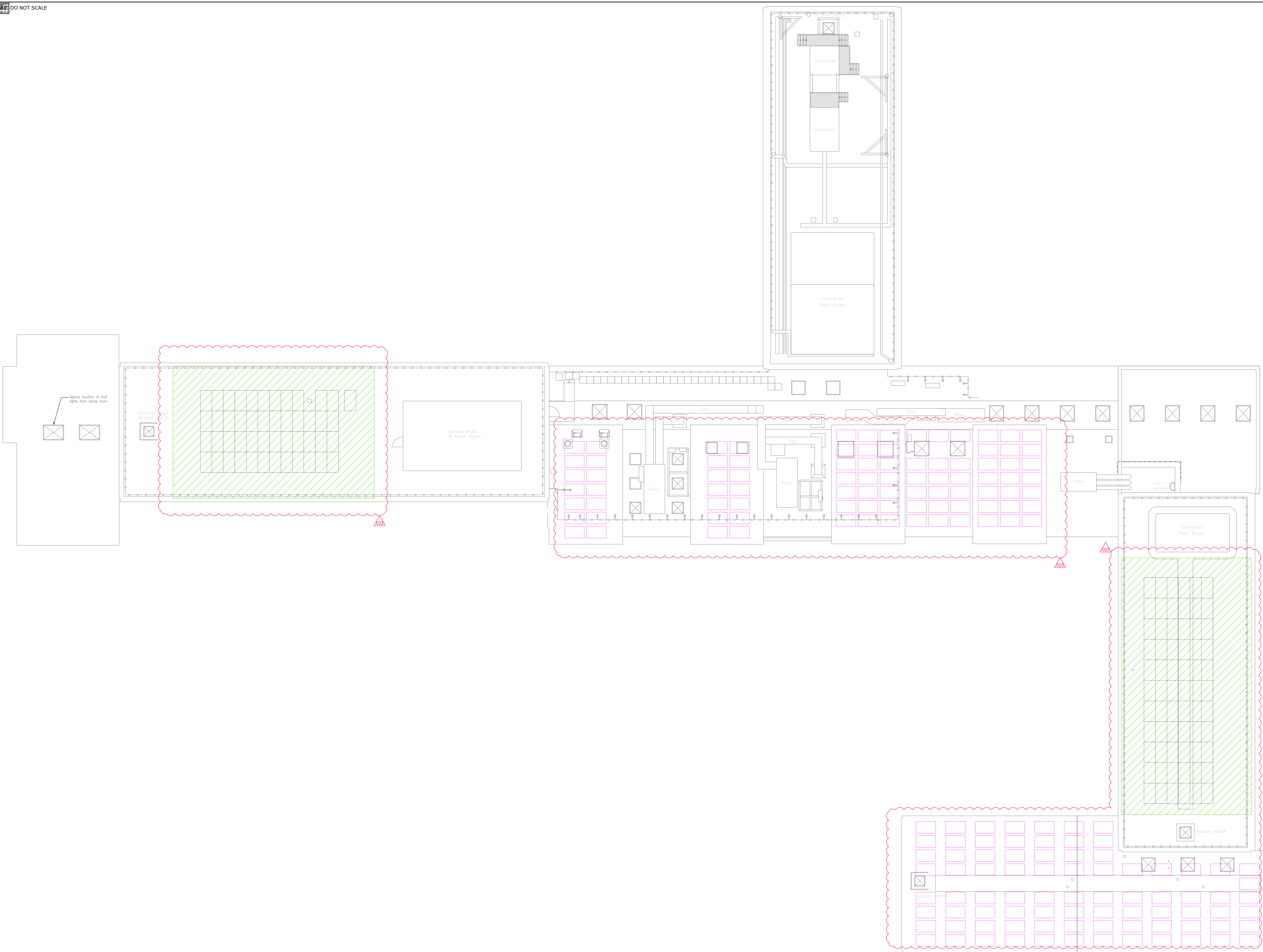

021	18.07.21	JM	JC	PI Panel Modified as Indicated
022	09.06.21	JM	JC	Tender Issue
023	28.05.21	JM	JC	Tender Issue
024	27.05.21	JM	JC	Preliminary Issue
025	18.05.21	JM	JC	Preliminary Issue

FRANKHAM
 Frankham Consultancy Group Limited
 E: enquiries@frankham.com
 www.frankham.com

INFO & CONTACT

BOCP OFFICE Ipswich Road Bishopsclee Road Ipswich, Suffolk IP1 3JG T: 01473 839977	COVENTRY OFFICE Clydebank Office New Enterprise House 214 Salford Road Coventry CV4 9JF T: 01845 222000
LONDON OFFICE Third Floor Bentley House 15-17 St Cross Street London EC3A 6HQ T: 020 7451 0790	STEVENAGE OFFICE Suite 217, Second Floor Long Cross Business Centre Lunden Road, Stevinge Hertfordshire SG2 2JG T: 020 3714 7963

Client: East Sussex County Council

Project Title: Solar PVR Development

Drawing Title: County Hall Roof Level Electrical Services Proposed PV Layout

Status: TENDER ISSUE

Drawn By: DK | Designed By: JM | Checked By: RG | Approved By: JC

Original Issue Date: 18/05/2021 | Scale: @ A0: 1:100

Job No	File Ref	Originator	Zone	Level
522093		FCG	COU	RF
Type	Discipline	Number	Suitability	Revision
DR	E	6004	D2	C03