

Agricultural Building Proposed Elevations Wingates Moor Farm, Longhorsley

North Elevation

Open elevation; 3 x 6.096m (20 ft) bays and 1 x 4.572m (15 ft) bay separated by steel stanchions. The roof will be clad with Marley Eternitt Fibre Cement roof sheets.



East Elevation

Open elevations; 15.240m (50 ft) wide 15 degree pitch roof with Yorkshire boarding from eaves to pitch

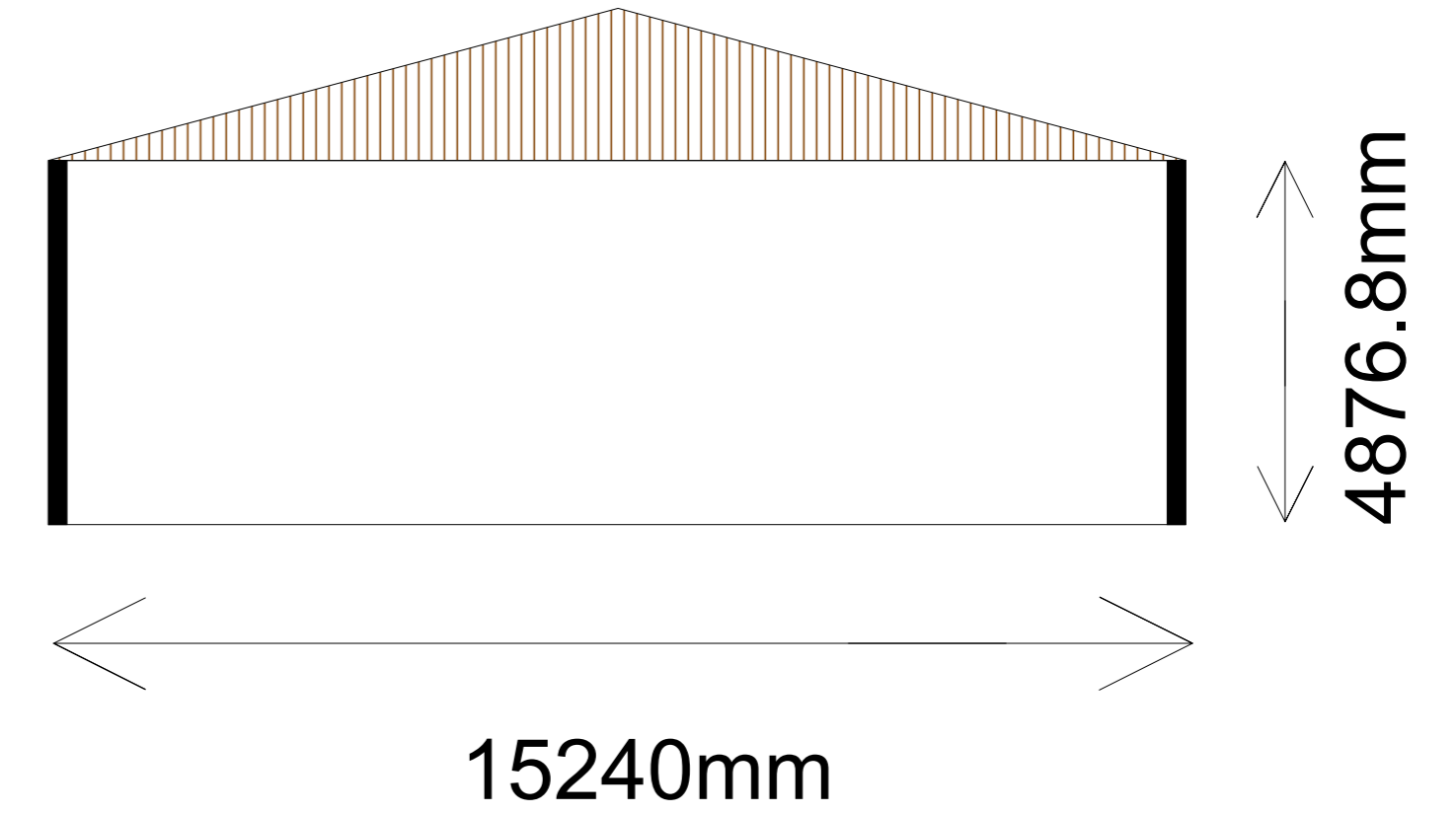

South Elevation

Open elevation; 3 x 6.096m (20 ft) bays and 1 x 4.572m (15 ft) bay separated by steel stanchions. The roof will be clad with Marley Eternitt Fibre Cement roof sheets.

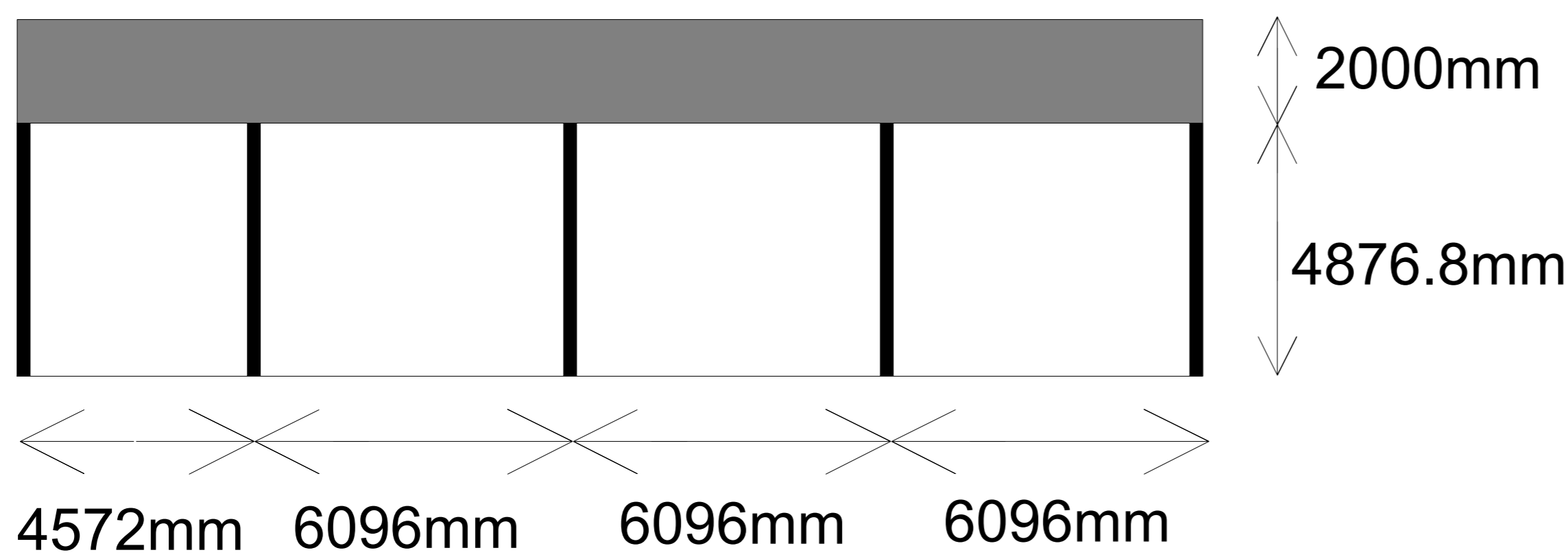

West Elevation

15.240m (50 ft) wide with 1.2m high concrete panels with Yorkshire board cladding above. 15 degree pitch roof

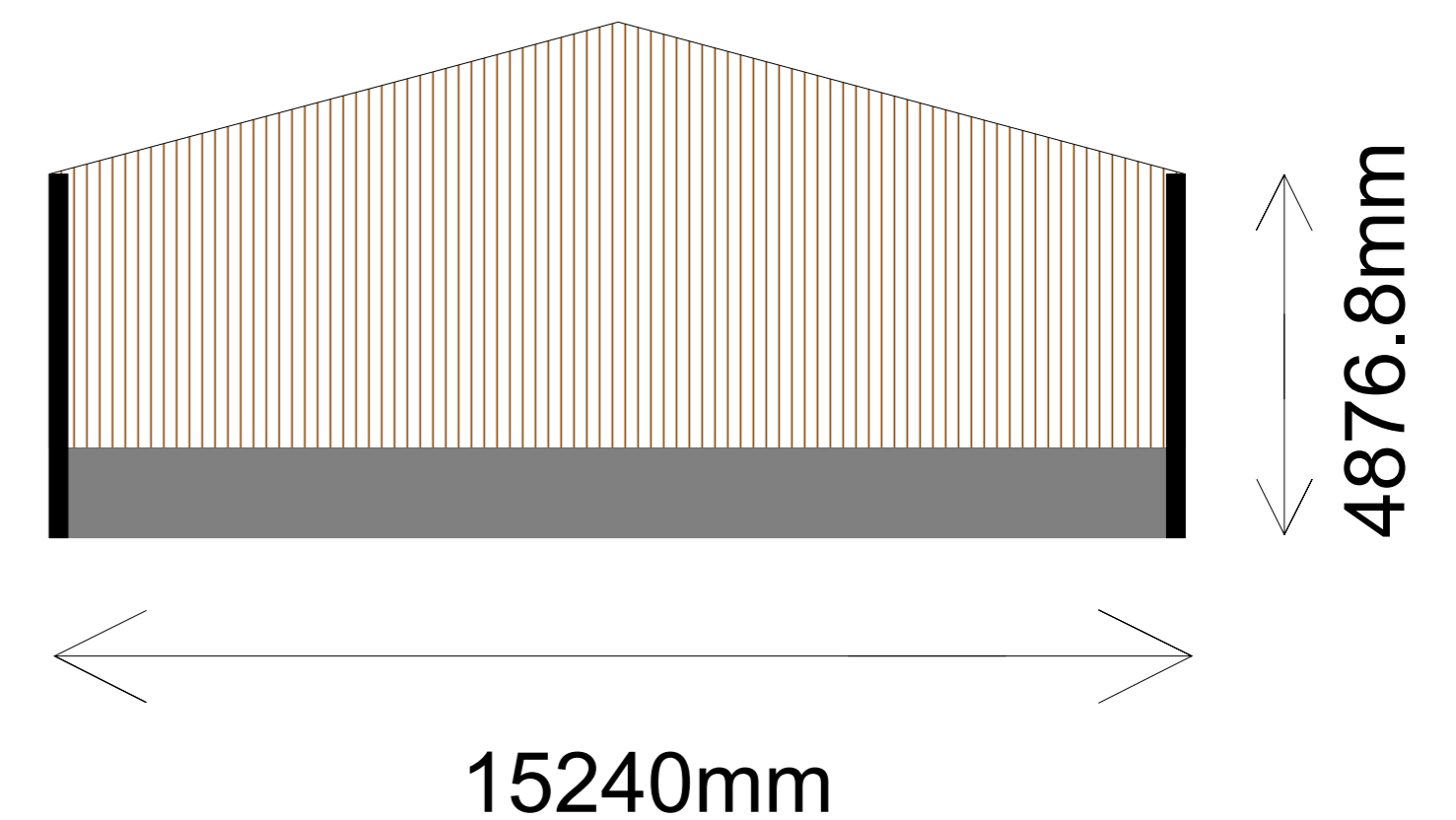

Floorplan

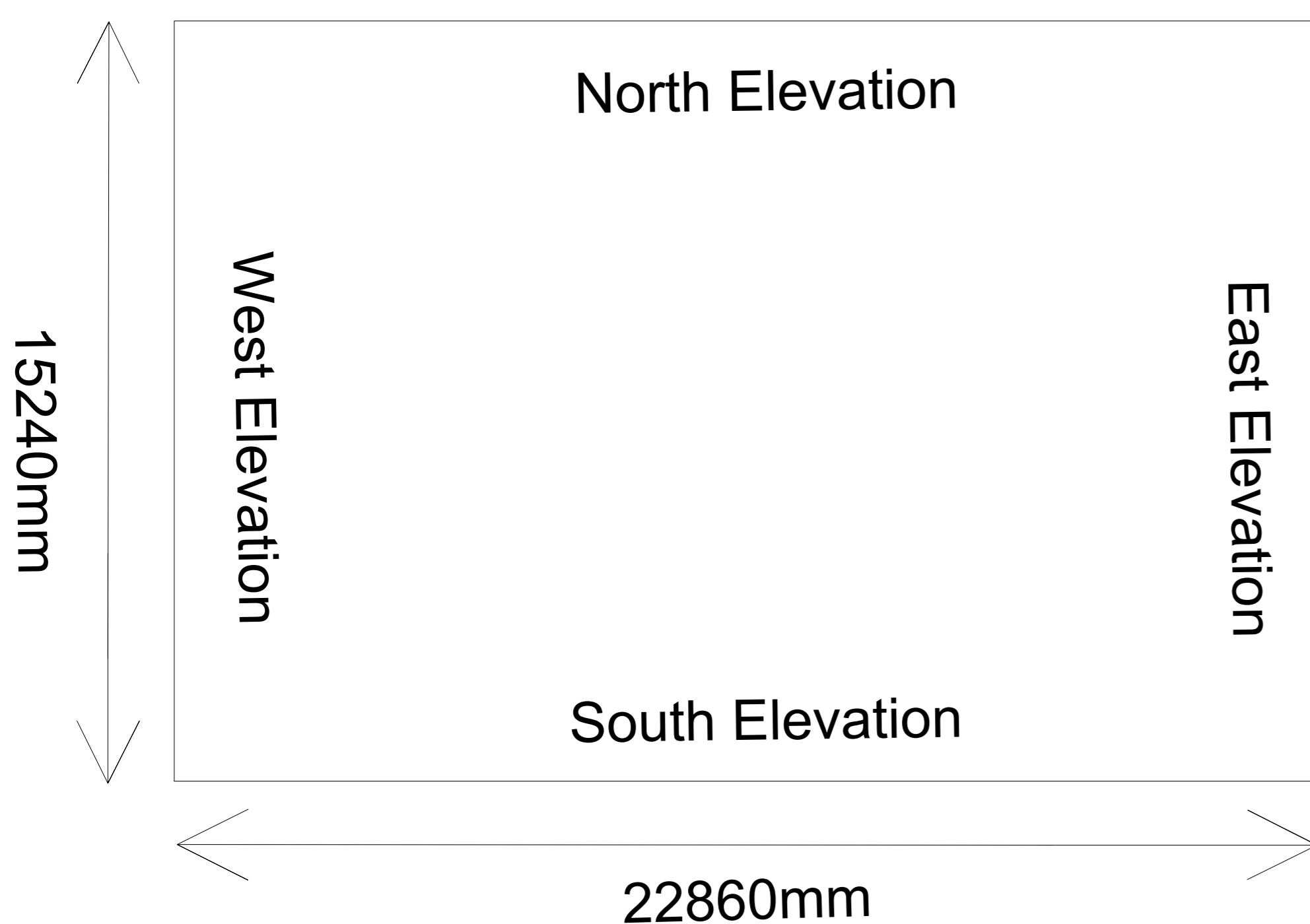

Roof Plan

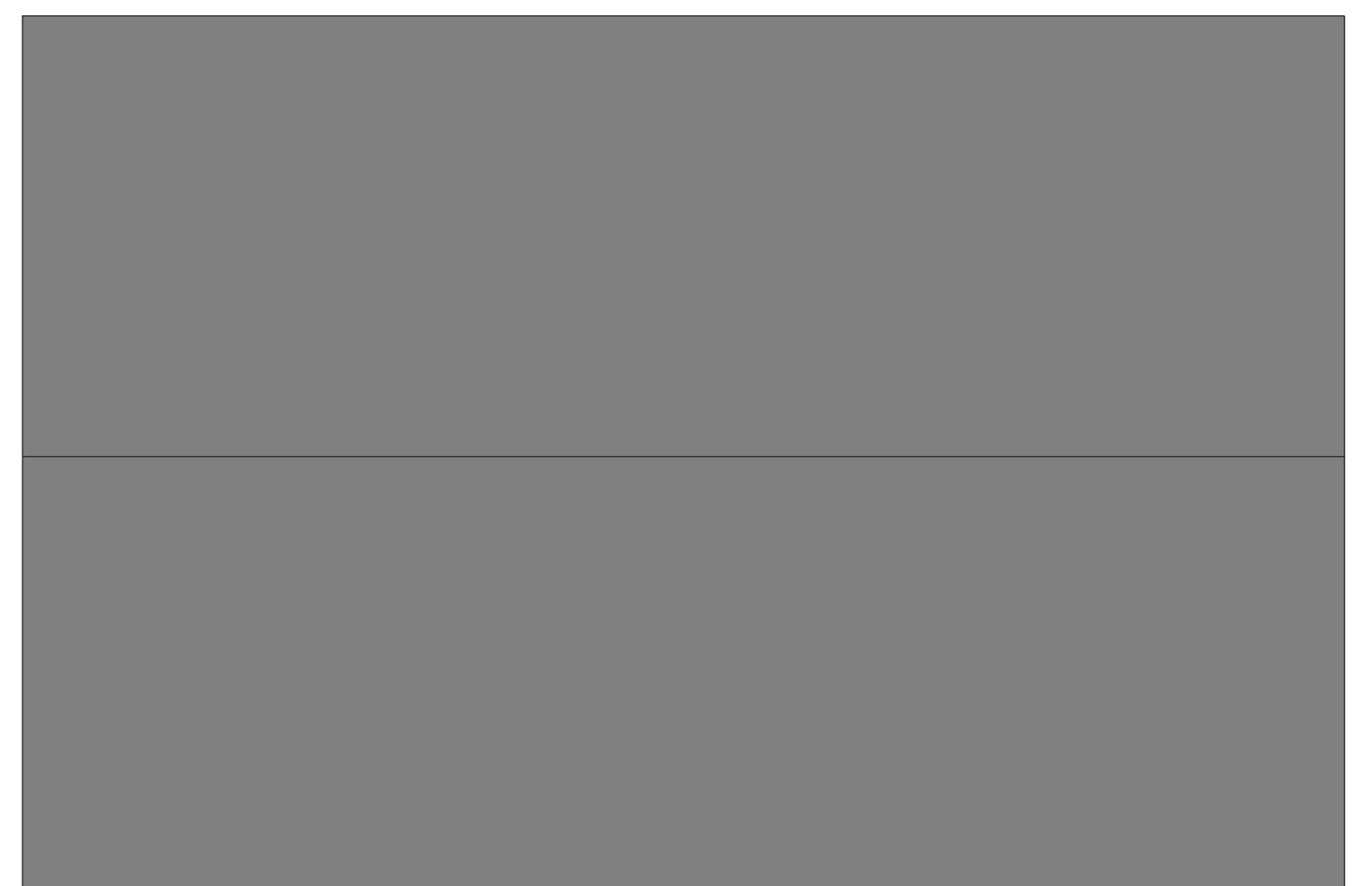

YoungsRPS

Priestpopple, Hexham
01434 609000

Proposed Agricultural Building Elevation

SCALE : 1 : 100 @ A1 DATE : 21/07/2021

MAP FILENAME : YRPS-WINBOON-05B

Map data shown may contain Ordnance Survey® products supplied by Pear Technology Services Ltd; Email: info@peartechnology.co.uk © Crown Copyright and database rights from date shown above Ordnance Survey® licence number 100023148