

General Notes

/ All debris, unless specified elsewhere, to be removed from site by suitable transport to an approved coup.
 / The work area must be supervised or secured at all times to ensure that unauthorised persons do not gain entry.
 / All workmanship, materials, components, fixtures, fittings and installation to be in accordance with British Standards Codes of Practice or BBA Certificates where they exist or in accordance with the manufacturers recommendations and instructions.
 / All finishes to be made good on completion of the works and where appropriate to match existing.
 / All new works to be in accordance with the building (Scotland) regulations 2004 and all current amendments.
 / All new works, products and processes are to be in accordance with the relevant British standards and manufacturers guidance.

The contractor shall be responsible for:
 - notifying building standards officer of start date for work at least 3 days prior to starting
 - verifying all sizes and angles prior to purchasing or ordering materials or components
 - prior to commencing works, verifying that he is working to drawings and specifications which have been approved by the local authority

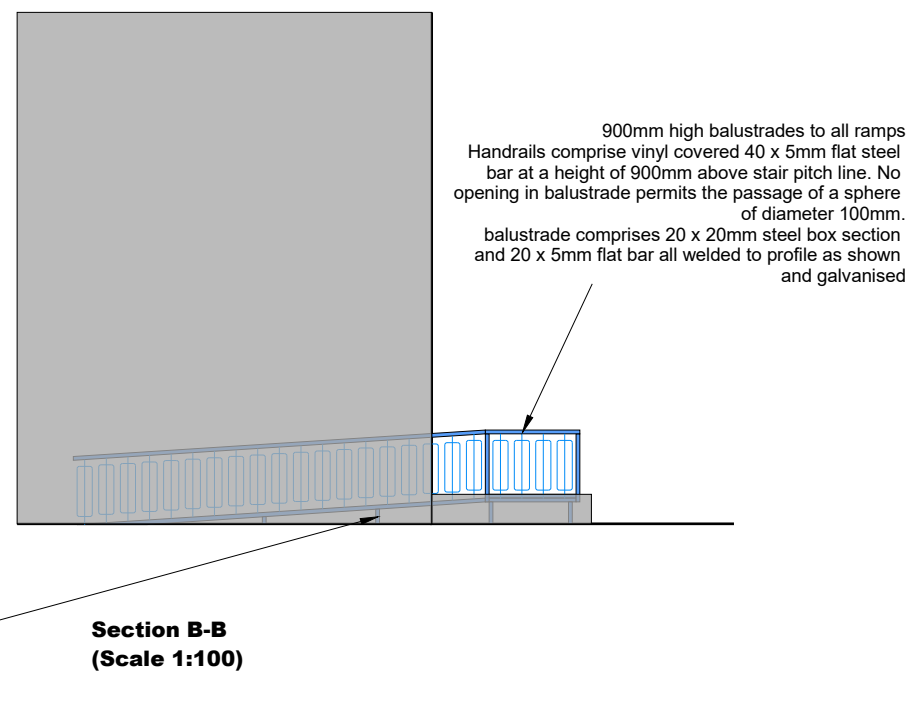
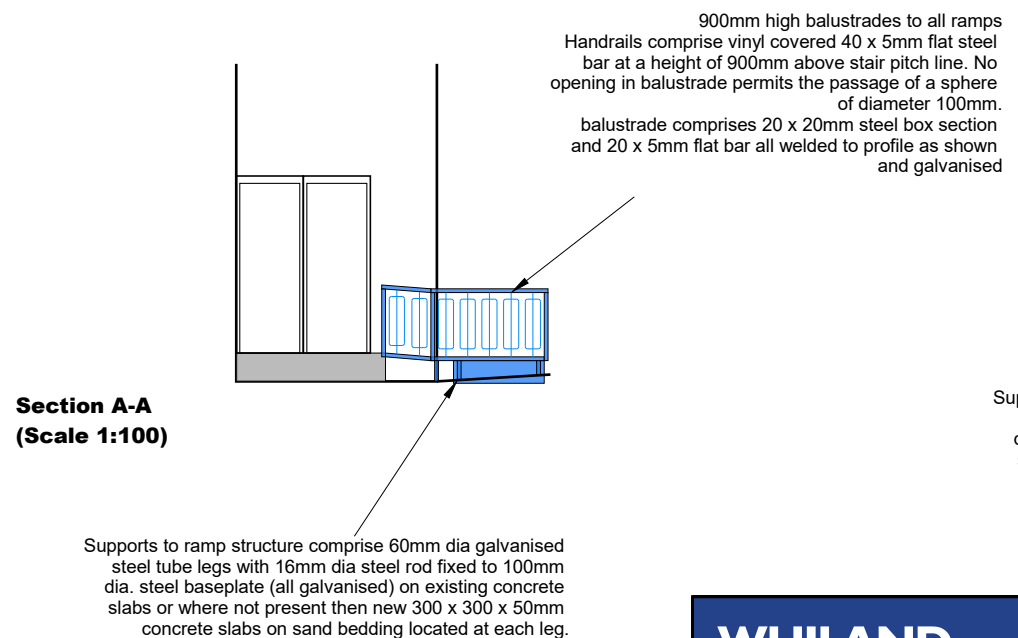
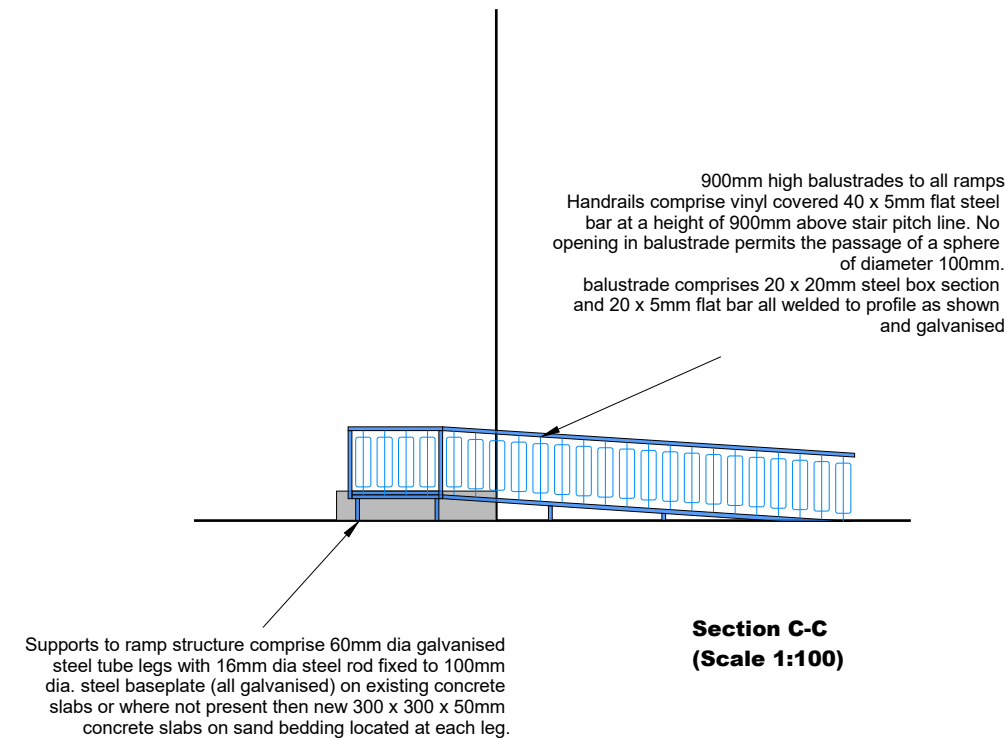
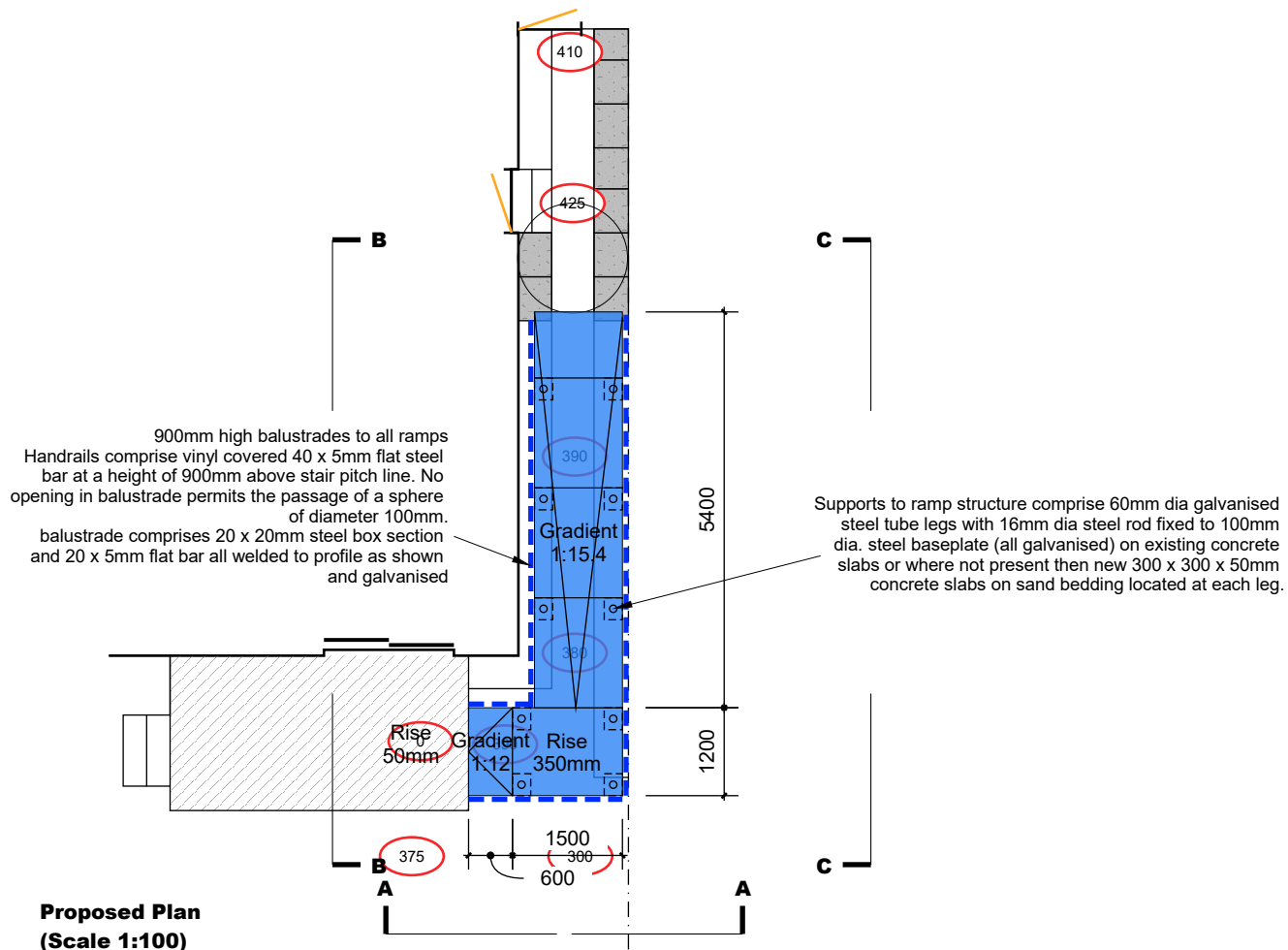

60mm dia galvanised steel tube legs with 16mm dia steel rod fixed to 100mm dia. steel baseplate (all galvanised) on existing concrete slabs or where not present then new 300 x 300 x 50mm concrete slabs on sand bedding located at each leg.



Client Name: Marion Dyson	Drawing No 20059-AL03	Drawn by: BM	Revision	Date: 14/07/21
Client Address: 33 Kirk Park, Dunbar, EH42 1BJ	Drawing Title: Proposed plan and elevations			
William P Whiland & Son, 8 Alder Road, Broadmeadow Estate, Dumbarton, G82 2EL Tel: 01389 730430 Fax: 01389 743833 Email: ramps@whiland.co.uk				

Entrance: Rear	Platform Height: 0mm
Rise: 400mm	Gradient: 1:12/1:15.4
Ramp Length: 6000mm exc. landings	Ramp Width: 1200mm

This drawing is the copyright of William P Whiland & Son Ltd. and must not be copied or reproduced without permission - only written dimensions to be respected - where applicable, all dimensions are to be checked on site - this drawing must be read in conjunction with the contract specification and all other architects / engineers; layouts, schedules and details