

NOTE:
 • THIS DRAWING IS COPYRIGHT.
 • CONTRACTORS, CLIENT AND ALL SUB-CONTRACTORS USING THIS DRAWING TO CHECK ALL DIMENSIONS ON SITE.
 • ONLY FIGURED DIMENSIONS ARE TO BE WORKED FROM.
 • DISCREPANCIES MUST BE REPORTED IMMEDIATELY BEFORE PROCESSING.

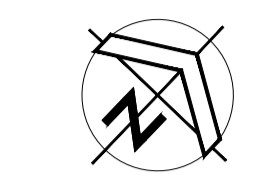

NOTE:
 • Difference between Floor Levels = 500mm
 • All details and drainage to be confirmed
 • Ground conditions and structure subject to Structural Engineers Details
 • All Fire Doors etc to be agreed / confirmed

--- Demolition
 ■ Proposed
 ⊕ FFL Proposed Levels +50.00
 50.00 Existing Levels (All levels left on for information)

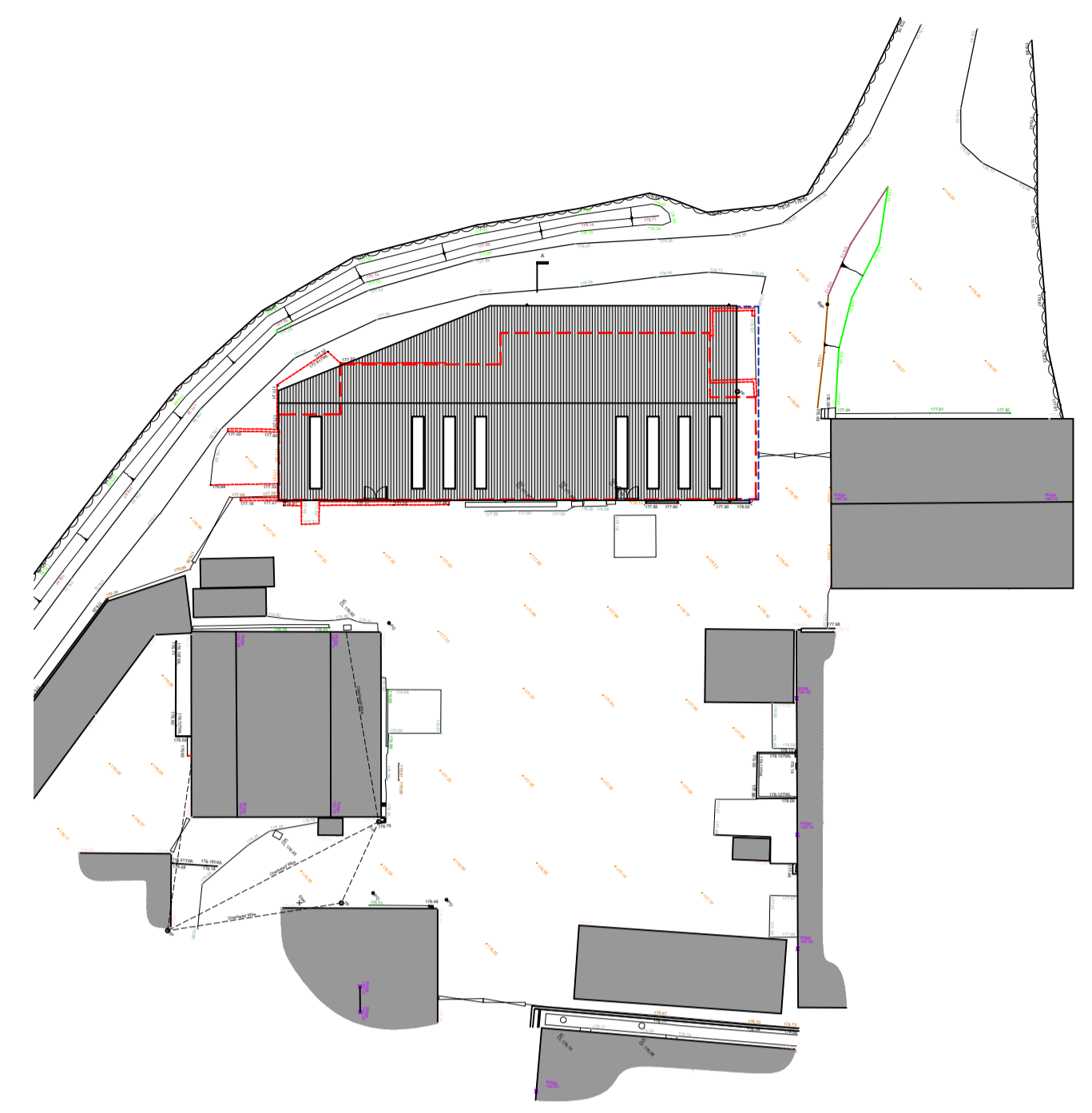

03 Proposed Block Plan
 1:500

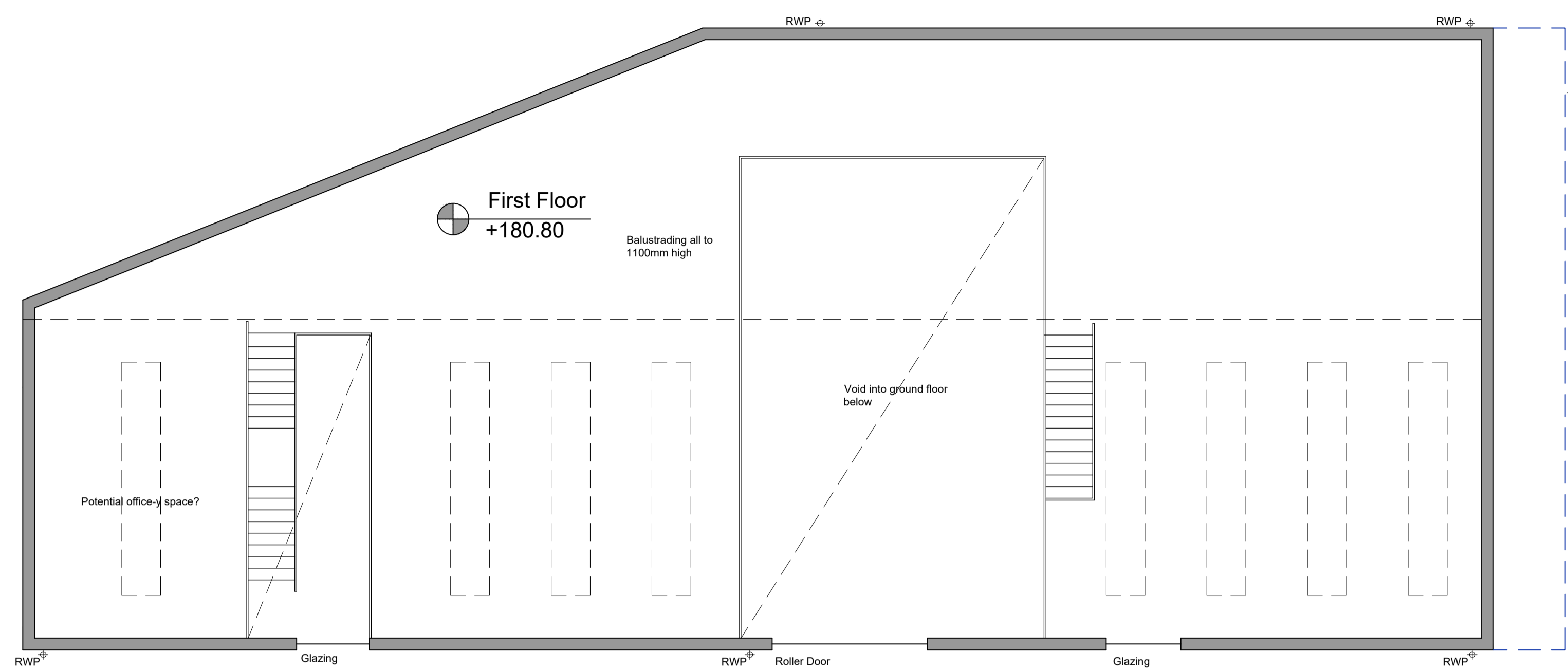

02 First Floor Plan
 1:100

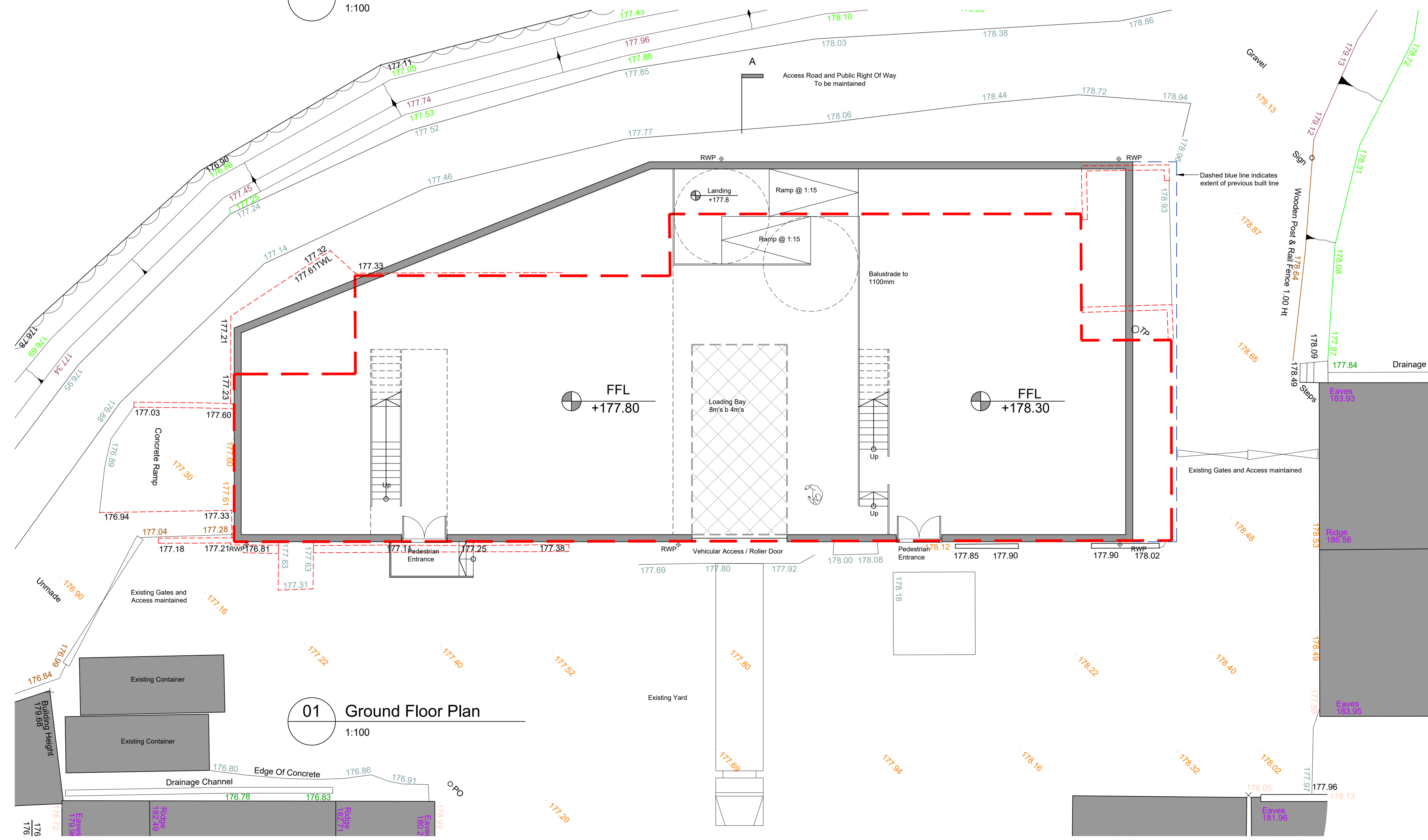

01 Ground Floor Plan
 1:100

Rev	Date	Comment:
C	06.07.21	Proposed Block Plan added, Area of proposals reduced
B	04.05.21	Issued for Planning
A	01.03.21	Revised following clients comments

PLANNING	
MSG ARCBUILD mark@msgarcbuild.co.uk	
ARCHITECTURAL & BUILDING CONSULTANT 01841 521552	
Client	SUSTAINABLE FURNITURE
Property	SUSTAINABLE FURNITURE, GOONVEAN INDUSTRIAL ESTATE, ST STEPHEN, SAINT AUSTELL PL26 7QF
Project	PROPOSED REPLACEMENT WAREHOUSE AND STORES
Drawing	PROPOSED PLANS
Project No.	45500
Date:	Jan 2021
Drawing No.	PL-10
Revision:	C
Scale	As Noted @A1
Drawn:	MSG