

# BIRDS NESTING OPPORTUNITIES PLAN

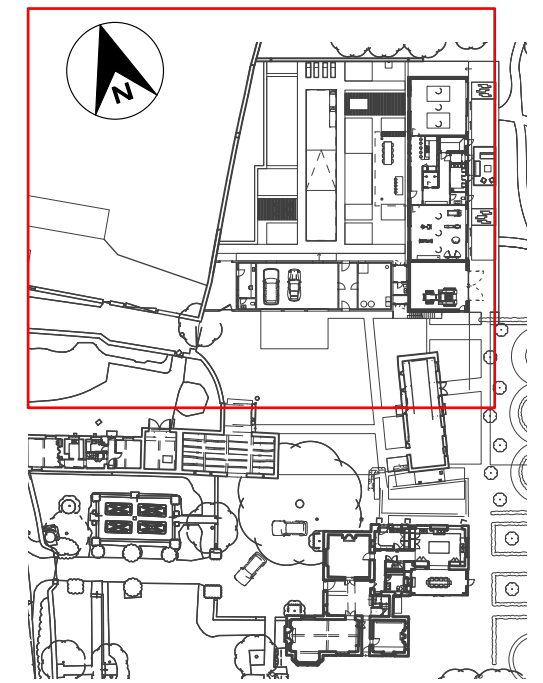
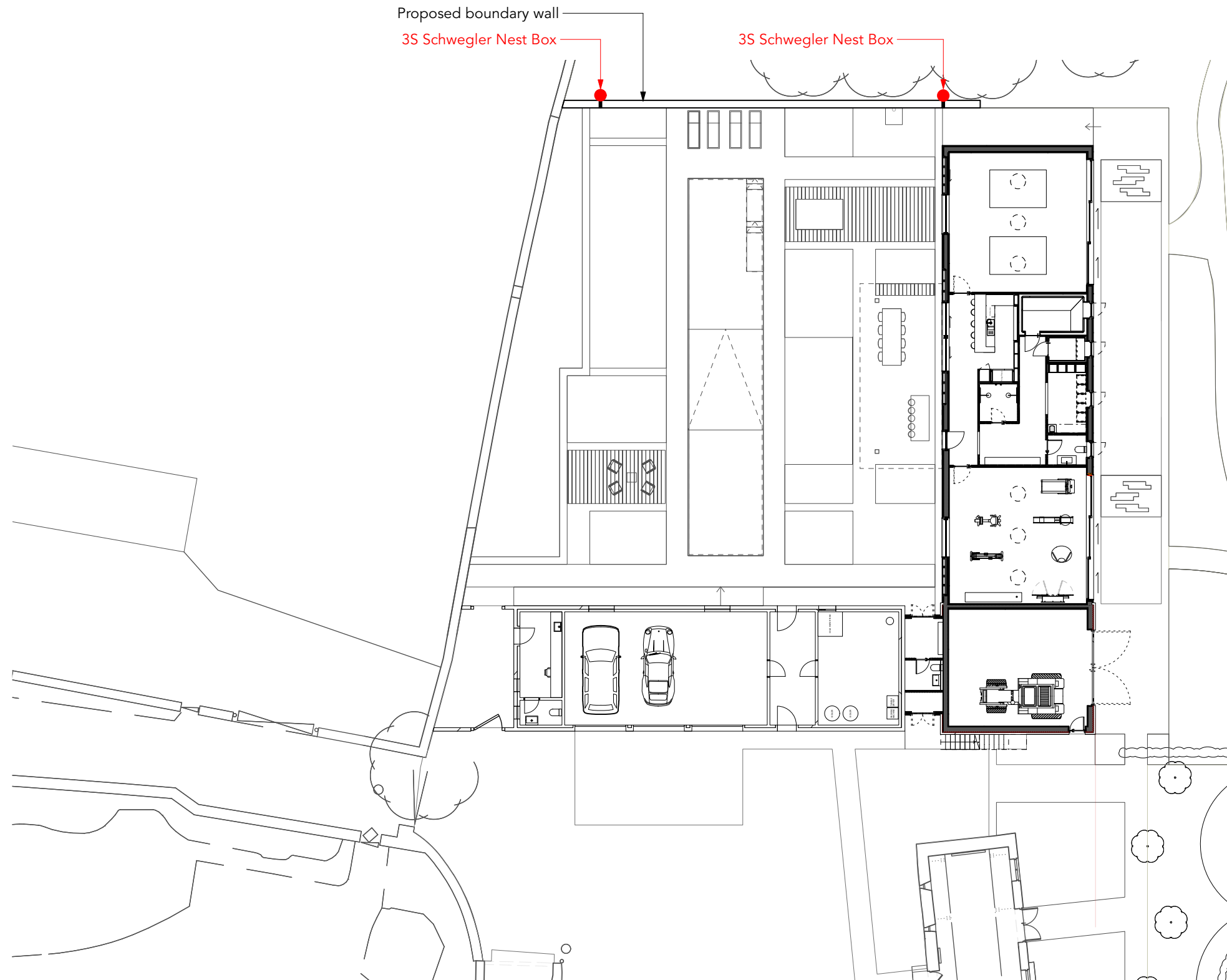

## KEY

● 3S Schwegler Nest Box

01 Broadwell House - Bird Boxes Location - Proposed Plan  
Scale - 1:250@A3

## PLANNING

### RUNDELL ASSOCIATES

Architecture & Design  
12 Salem Rd, London W2 4DL

+44 (0)207 483 8360  
office@rundellassociates.com

rundellassociates.com

Client  
**MR & MRS JACKSON**

Structural Engineer  
-

Services Engineer  
-

Quantity Surveyor  
-

Project **Broadwell House**

Drawing Title  
**Proposed  
Birds nesting opportunities  
Planning**

Date **29.07.2021** Revision **A**

Scale **1:250**

Job No. **3509**

Drawing No.  
**ASK32.P**

Drawn by **AR**

Checked

# BIRDS NESTING OPPORTUNITIES - ELEVATION

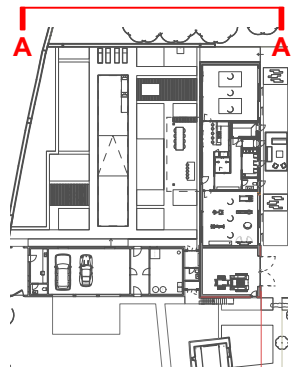
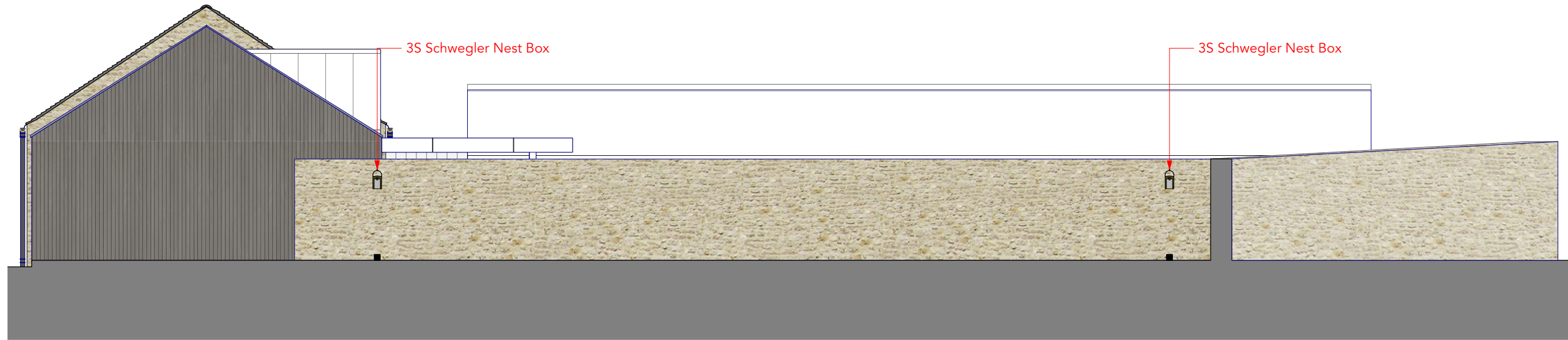

01 Broadwell House - 3S Schwegler Nest Boxes - Proposed Elevation A  
Scale - 1:100@A3

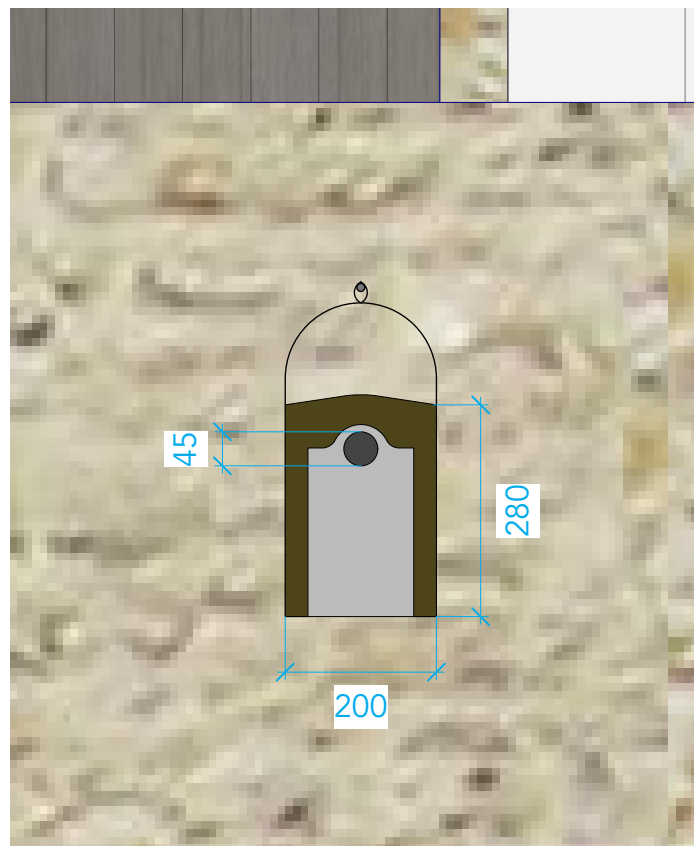

02 Broadwell House - 3S Schwegler Nest Boxes - Proposed Elevation A - Close-up  
Scale - 1:10@A3

03 Broadwell House - 3S Schwegler Nest Box  
Reference Image

Task Name	Start	End
Surface hardscaping to walled garden and perimeter of new buildings	January 2022	March 2022
3S Schwegler Nest Boxes will be provided at the end of construction of the boundary wall, in Spring 2022		

04 Broadwell House - 3S Schwegler Nest Boxes timetable of provision  
Reference Image

## PLANNING

### RUNDELL ASSOCIATES

Architecture & Design  
12 Salem Rd, London W2 4DL

+44 (0)207 483 8360  
office@rundellassociates.com

rundellassociates.com

Client **MR & MRS JACKSON**

Structural Engineer -

Services Engineer -

Quantity Surveyor -

Project **Broadwell House**

Drawing Title  
**Proposed  
Birds nesting opportunities  
Planning**

Date **29.07.2021** Revision **A**

Scale **1:50**

Job No. **3509**

Drawing No. **ASK32.1.P**

Drawn by **AR** Checked