



**A**  
ELEV SCALE 1:100 @ A1  
PROPOSED NORTH EAST ELEVATION



**B**  
ELEV SCALE 1:100 @ A1  
PROPOSED SOUTH EAST ELEVATION



**C**  
ELEV SCALE 1:100 @ A1  
PROPOSED SOUTH WEST ELEVATION



**D**  
ELEV SCALE 1:100 @ A1  
PROPOSED NORTH WEST ELEVATION

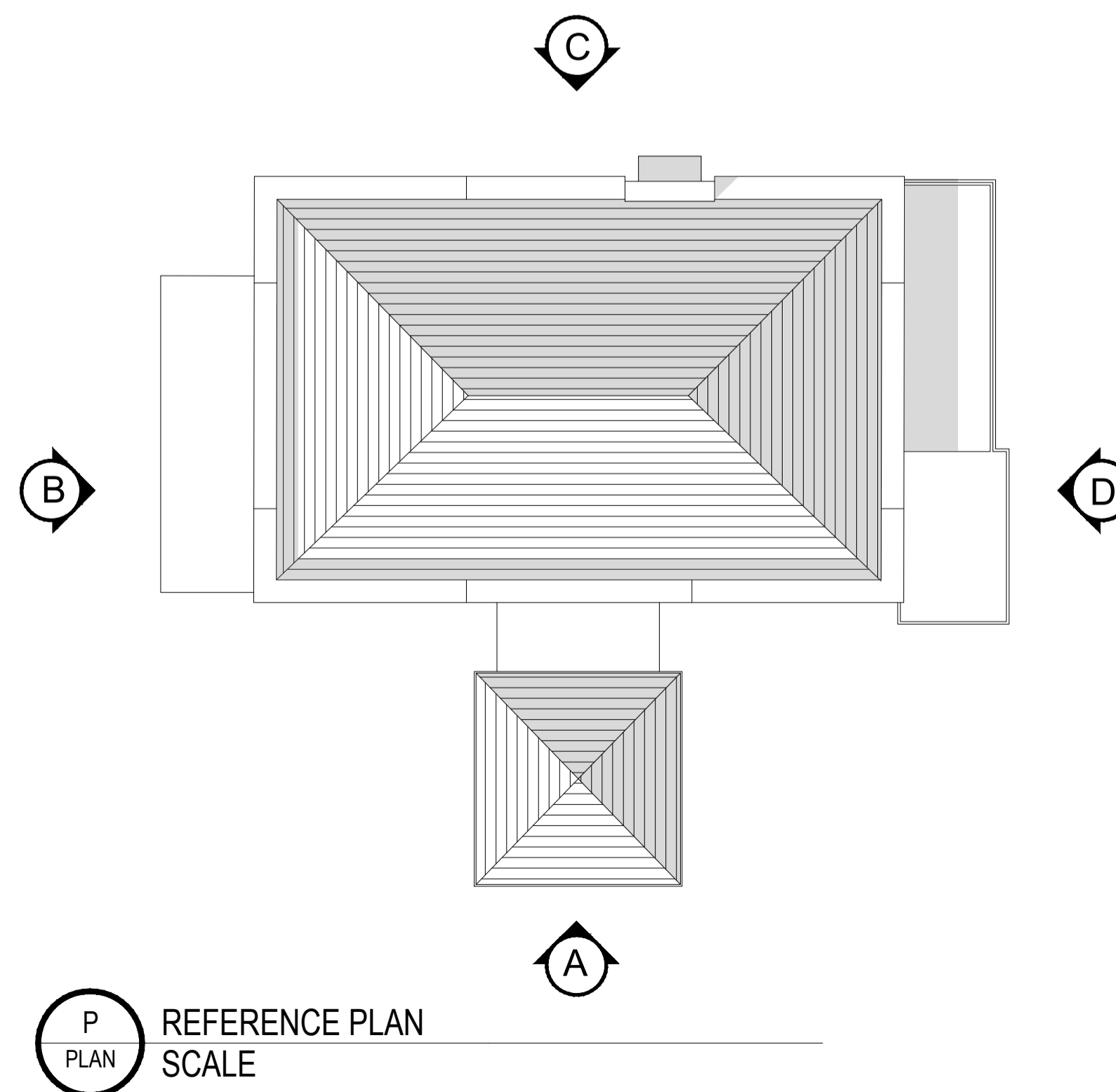

**P**  
PLAN SCALE  
REFERENCE PLAN

<b>SIGN S1</b>	TIM HORTONS DESCRIPTOR SIGN
SIZE	3900mm X 805mm X 100mm
QUANTITY	1
SPECIFICATION	SIGNAGE MOUNTED ONTO THE FACADE. INTERNALLY ILLUMINATED RED LED LETTERS. ALUMINUM SIDES & BACK PPC IN GREY PANTONE 4010. RED PLEX CHANNEL LETTER FACES PANTONE 186C RED TRIM CAP.

<b>SIGN S2</b>	TIM HORTONS DESCRIPTOR SIGN
SIZE	6640mm X 1375mm X 100mm
QUANTITY	2
SPECIFICATION	SIGNAGE MOUNTED ONTO THE FACADE. INTERNALLY ILLUMINATED RED LED LETTERS. ALUMINUM SIDES & BACK PPC IN GREY PANTONE 4010. RED PLEX CHANNEL LETTER FACES PANTONE 186C RED TRIM CAP.

<b>SIGN S3</b>	TIM HORTONS STACKED DESCRIPTOR SIGN
SIZE	1655mm X 1050mm X 100mm, 2495mm X 1100mm X 100mm
QUANTITY	1
SPECIFICATION	SIGNAGE MOUNTED ONTO THE FACADE. INTERNALLY ILLUMINATED RED LED LETTERS. ALUMINUM SIDES & BACK PPC IN GREY PANTONE 4010. RED PLEX CHANNEL LETTER FACES PANTONE 186C RED TRIM CAP.

<b>SIGN S4</b>	TIM HORTONS CANADIAN LEAF
SIZE	1900mm X 1840mm X 100mm
QUANTITY	1
SPECIFICATION	WALL MOUNTED. ALUMINUM 'MAPLE LEAF' TRAY SIGN FINISHED IN RED TO MATCH RAL 3020 WITH BACK-LIT 'HALO' EFFECT LED ILLUMINATION. LED INTERNALLY ILLUMINATED WHITE LETTERING ONLY. (RED LEAF NOT ILLUMINATED).

<b>SIGN S5</b>	STACKED DRIVE THRU LETTERING
SIZE	1435mm X 945mm X 100mm
QUANTITY	1
SPECIFICATION	30 INTERNALLY ILLUMINATED RED OPAL ACRYLIC LETTERS. BUILT UP BLACK RETURNS TO MATCH RAL 9003 60% GLOSS. ALL POWER CABLES/CONDUIT TO BE CONCEALED.

<b>SIGN S6</b>	DRIVE THRU LETTERING
SIZE	1620mm X 215mm X 100mm
QUANTITY	1
SPECIFICATION	30 INTERNALLY ILLUMINATED WHITE OPAL ACRYLIC LETTERS. BUILT UP BLACK RETURNS TO MATCH RAL 9003 60% GLOSS. ALL POWER CABLES/CONDUIT TO BE CONCEALED.

<b>SIGN S7</b>	DRIVE THRU LETTERING
SIZE	2700mm X 355mm X 100mm
QUANTITY	2
SPECIFICATION	30 INTERNALLY ILLUMINATED WHITE OPAL ACRYLIC LETTERS. BUILT UP BLACK RETURNS TO MATCH RAL 9003 60% GLOSS. ALL POWER CABLES/CONDUIT TO BE CONCEALED.

**NOTES:**

- LUMINANCE TO BE 500Cd/m2 WITHIN SIGNAGE. CONTRACTOR TO ADVISE.
- ALL POWDERCOATING TO BE AT 60% SHINE.
- ALL WALL MOUNTED SIGNAGE TO HAVE CONCEALED POWER CONNECTIONS OR CONDUIT. ONLY THE SIGNAGE LETTERING SHOULD BE VISIBLE ON THE FACADE

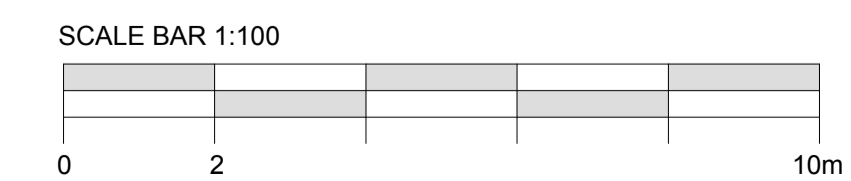

**IMPORTANT:**  
ONLY SCALE FOR PLANNING PURPOSES.  
ALL DIMENSIONS SHOWN ARE FOR REFERENCE ONLY, AND SHOULD BE VERIFIED ON SITE BY THE PRINCIPLE CONTRACTOR.  
COPYRIGHT:  
THIS DRAWING AND THE DETAILS HEREIN ARE THE COPYRIGHT OF BEYOND COMMUNICATIONS LTD AND MUST NOT BE REPRODUCED, ALTERED OR PASSED TO ANY THIRD PARTY WITHOUT PRIOR WRITTEN CONSENT.  
THE CONTRACTOR TO ADVISE ON ALL DETAILS AND ENSURE STABILITY AND STRENGTH OF CONSTRUCTION. THE CONTRACTOR TO PROVIDE SETTING OUT AND ROD DRAWINGS FOR APPROVAL PRIOR TO CONSTRUCTION.  
THE CONTRACTOR TO CHECK ALL DIMENSIONS ON SITE AND RELATE TO THESE DRAWINGS. THE CONTRACTOR TO REPORT ANY DISCREPANCIES TO DESIGNERS PRIOR TO CONSTRUCTION.  
ALL SERVICES TO LOCAL AUTHORITIES, BCO AND ENVIRONMENTAL HEALTH REQUIREMENTS, AND TO SERVICE ENGINEERS DETAILS. ALL STRUCTURE TO STRUCTURAL ENGINEERS DETAILS AND LOCAL AUTHORITIES AND BCO REQUIREMENTS.  
ALL CONSTRUCTION AND MATERIALS TO COMPLY WITH CURRENT BUILDING AND FIRE REGULATIONS.  
THE CONTRACTOR SHALL COMPLY WITH THE CANADIAN REGULATIONS FIRE PRECAUTIONS, CODE OF PRACTICE FOR THE PREVENTION OF FIRES ON CONSTRUCTION SITES AND BUILDINGS UNDERGOING REPAIR/RENEWMENT HEALTH & SAFETY AT WORK REGULATIONS 1974.  
CODE OF WELFARE CONDITIONS AS OUTLINED IN THE NATIONAL WORKING RULE AGREEMENT FOR THE BUILDING INDUSTRY AND ANY STATUTORY RULES AND ORDERS RELATING TO THE PROVISION AND MAINTENANCE OF WELFARE AND SAFETY MEASURES AND AMENITIES FOR ALL WORK PEOPLE EMPLOYED ON SITE.  
CONTRACTOR TO ENSURE, WHERE APPLICABLE, THAT ALL LANDLORDS GUIDELINE REQUIREMENTS ARE MET.  
WHERE DRAWINGS HAVE BEEN ISSUED AS DXF, DWG OR OTHER ELECTRONIC MEANS, THE DESIGNERS CANNOT BE HELD RESPONSIBLE FOR THE ACCURACY OF THE DATA WITHIN YOUR CAD SYSTEM AFTER TRANSFORMATION. THE RECIPIENT IS ADVISED TO USE THE TRANSLATED DATA ONLY AS BACKGROUND FOR DRAWING PURPOSES.

REV	DATE	DESCRIPTION	NAME
A	23/07/2021	HEIGHT FROM THE GROUND TO THE BASE OF ADVERTISEMENTS ADDED.	MVB

Status: **PLANNING**

**Beyond LONDON**  
4a KING STREET STUDIOS, LONDON, W6 0QA  
WWW.BEYONDLONDON.COM  
TEL: 020 8846 3880

Client: **Tim Hortons**

Project Name: **7416 TEESIDE**

Format: **NON-STANDARD DRIVE-THRU**

Title: **PROPOSED ELEVATIONS (ADVERTS)**

Site Address: **Haydock Park Road  
Teesside Retail Park  
Stockton-on-Tees  
TS17 7BG**

Drawing No: <b>7416-PL-01.7</b>	Rev: <b>A</b>
Date: <b>17/05/2021</b>	Scale: <b>1:100 @A1</b>
Drawn by: <b>MVB</b>	Checked: <b>MC</b>