

EXISTING SITE PLAN
(1:200)

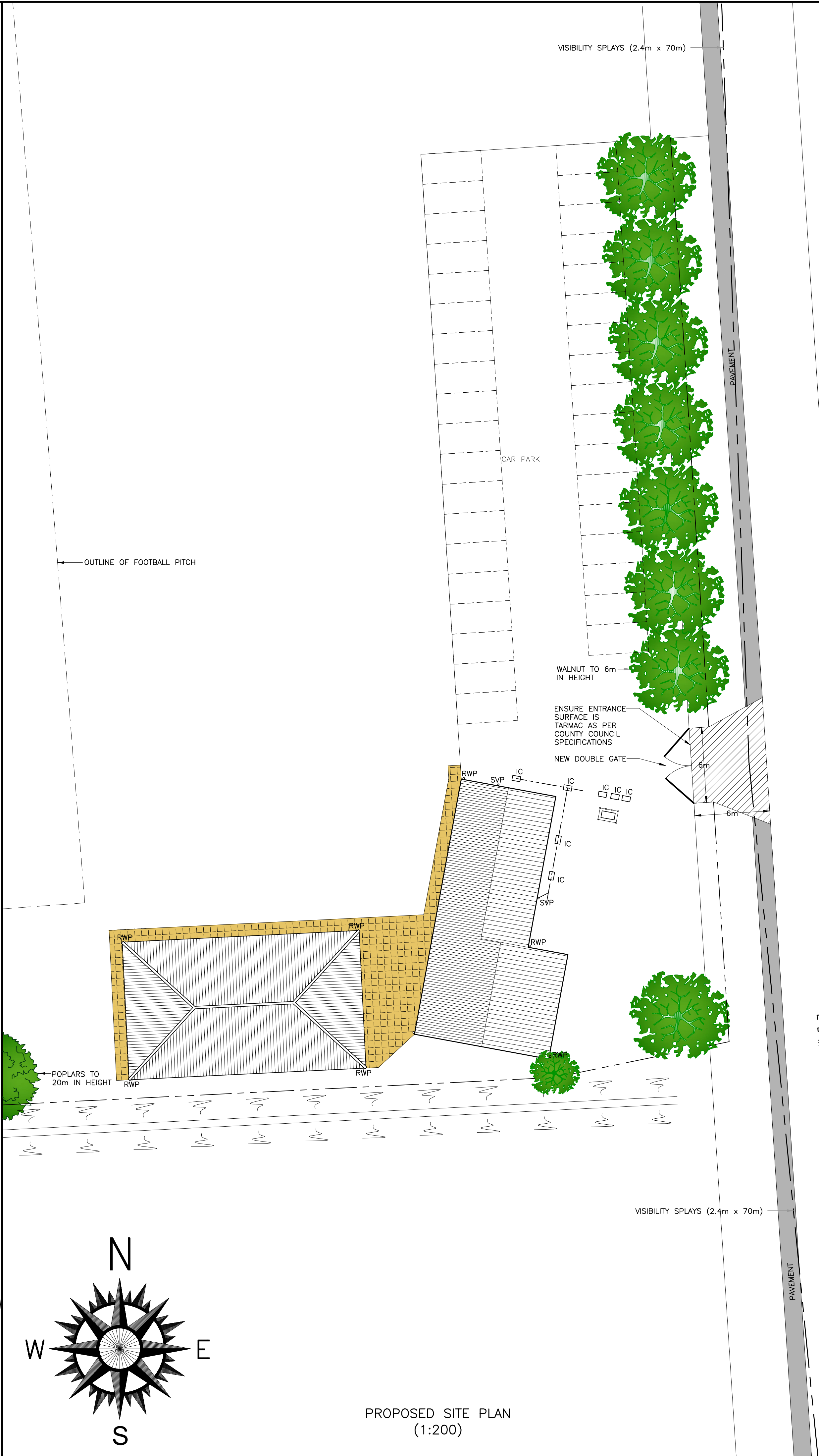

PROPOSED SITE PLAN
(1:200)

Copyright on all drawings prepared by Morton & Hall Consulting Limited is their property. Drawings and designs may not be reproduced in part or in whole without their written permission.
Please read, if in doubt ask. Change nothing without consulting the Engineers.
Contractor to check all dimensions on site before work starts or materials are ordered. If in doubt ask. All dimensions are in mm unless stated otherwise.
Where materials, products and workmanship are not fully specified they are to be of the standard appropriate to the works and suitable for the purpose stated in or reasonably to be inferred from the drawings and specification. All work to be in accordance with good building practice and BS 8000 to the extent that the recommendations define the quality of the finished work. Materials products and workmanship to comply with all British Standards and EOTA standards with, where appropriate, BS or EC marks.

All products and materials to be handled, stored, prepared and used or fixed in accordance with the manufacturers current recommendations.

The contractor is to arrange inspections of the works by the BCO (or NHBC) as required by the Building Regulations and is to obtain completion certificate and forward to the Engineer

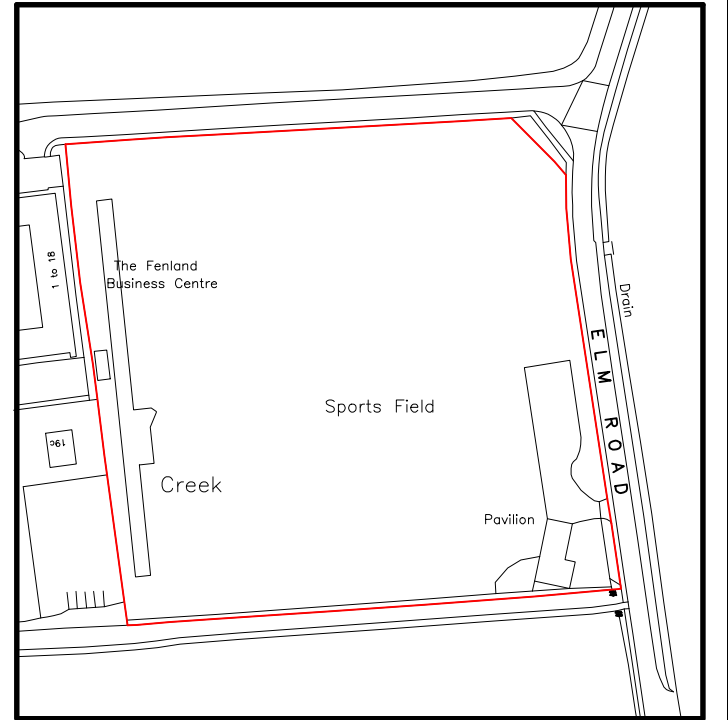

LOCATION PLAN
(1:2500)
LICENCE NUMBER 100022432

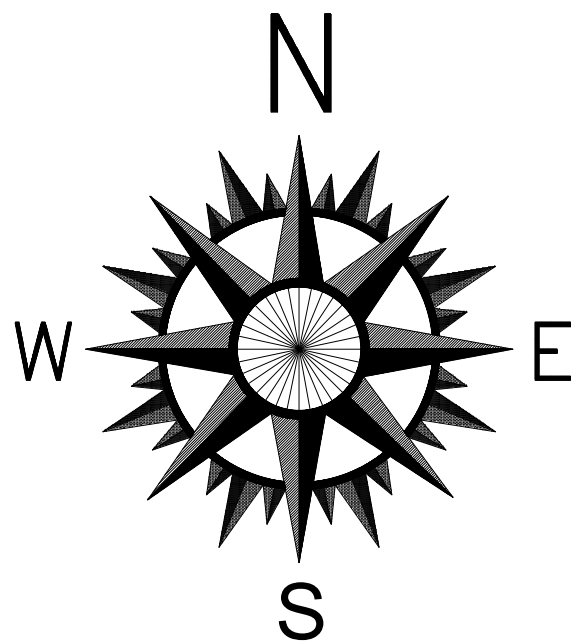

B A	PLANNERS COMMENTS	JUL 21
	SCHEME REVISED	FEB 21
REVISIONS		DATE

MORTON & HALL
CONSULTING LIMITED
CONSULTING STRUCTURAL ENGINEERS

1 Gordon Avenue,
March,
Cambridgeshire.
PE15 8AJ

Tel: 01354 655454
Fax: 01354 660467
E-mail: info@mortonandhall.co.uk
Website: www.mortonandhall.co.uk

CLIENT
March Sports Association

PROJECT
Elm Road Sports Field
March
Cambs
PE15 8PP

TITLE
Existing and Proposed
Site Plans

DRAWN R.Papworth	DATE OF ISSUE
CHECKED	
DATE Jan 2021	DRAWING NUMBER H7149/01b
SCALE 1:200	