

PLANT SCHEDULE

SHRUBS	QTY	CODE	PLANT NAME	STOCK	SIZE	SPACING
4No.	Cea Bmo	Ceanothus	'Blue Mound'	C 3L	40-60cm	3/m2
9No.	Heb eve 5L	Hebe	evanosa	C 5L	40-60cm	4/m2
6No.	Hyd Ann	Hydrangea	arborescens 'Annabelle'	C 3L	40-50cm	3/m2
22No.	Lav Hid 5L	Lavandula	angustifolia 'Hidcole'	C 5L	40-50cm	4/m2
7No.	Per BS	Perovskia	'Blue Spire'	C 3L	30-40cm	4/m2

NOTES AND ABBREVIATIONS:
 C = Container (or pot) grown, followed by size of the container (or pot)
 QTY = Quantity
 SIZE = Height or Spread of juvenile plant
 STOCK = Root condition/protection method eg Bare root
 - Refer to specification for further information
 - All plants to be completely hardened off
 - Substitutions to be agreed with Landscape Architect
 Plant Schedule generated by 'Qscape' software 14/07/2021

Rev.	Date (yymm-dd)	Initials	Details
A.	21-07-19	RE	Rear garden sheds added

ALL DIMENSIONS TO BE CHECKED ON SITE. TO BE READ WITH ALL CONTRACT DOCUMENTATION. ANY DISCREPANCIES TO BE REPORTED TO THE CONTRACT ADMINISTRATOR. DO NOT SCALE FROM THIS DRAWING.

Elwood Landscape Design 2021

N.B. These landscape proposals have NOT been cross referenced against drainage or service locations. All services and utilities to be checked to identify any potential conflicts with existing trees. Client/engineer to review and advise accordingly.

KEY

Soft Works

- EXISTING TREE & VEGETATION RETAINED ON ADJACENT LAND.
- PROPOSED SHRUB PLANTING WITH 65MM DEPTH BARK MULCH AFTER SETTLEMENT. TOPSOIL DEPTH 400MM TO BE RECESSED FROM TOP OF PLANTER BY 100MM.

Hard Works

- PROPOSED CONCRETE IMPRINT PAVING IN HERRINGBONE PATTERN. DETAILS BY ARCHITECT.
- PROPOSED CONCRETE PAVING SLABS LOCATED ACROSS STEPS AND LANDING. DETAILS BY ARCHITECT.
- PROPOSED CONCRETE ALLY & PATH BETWEEN THE BUILDINGS. DETAILS BY ARCHITECT.
- PROPOSED GRAVEL OVER GEOTEXTILE MEMBRANE TO SIDE OF HOUSE & REAR OF SHEDS.
- PROPOSED 1.8M HIGH CLOSE BOARD FENCE WITH CONCRETE POSTS. DETAILS BY ARCHITECT.
- PROPOSED PCC KERB TO EDGE OF PAVING. TO ARCHITECT'S DETAILS.

SCHEDULE OF QUANTITIES

SOFT LANDSCAPE TO GENERAL AREAS:

HARD LANDSCAPE TO GENERAL AREAS:

- 116m² Concrete imprint surface to parking bays
- 10m² Concrete surface to alley & path
- 20m² Edging kerb
- 1.0m Fencing hand rail to steps/walls
- 69m² Fencing Closeboard
- 2m² Gravel over geotextile membrane
- 46m Retaining wall
- 14m² Slabs to step treads

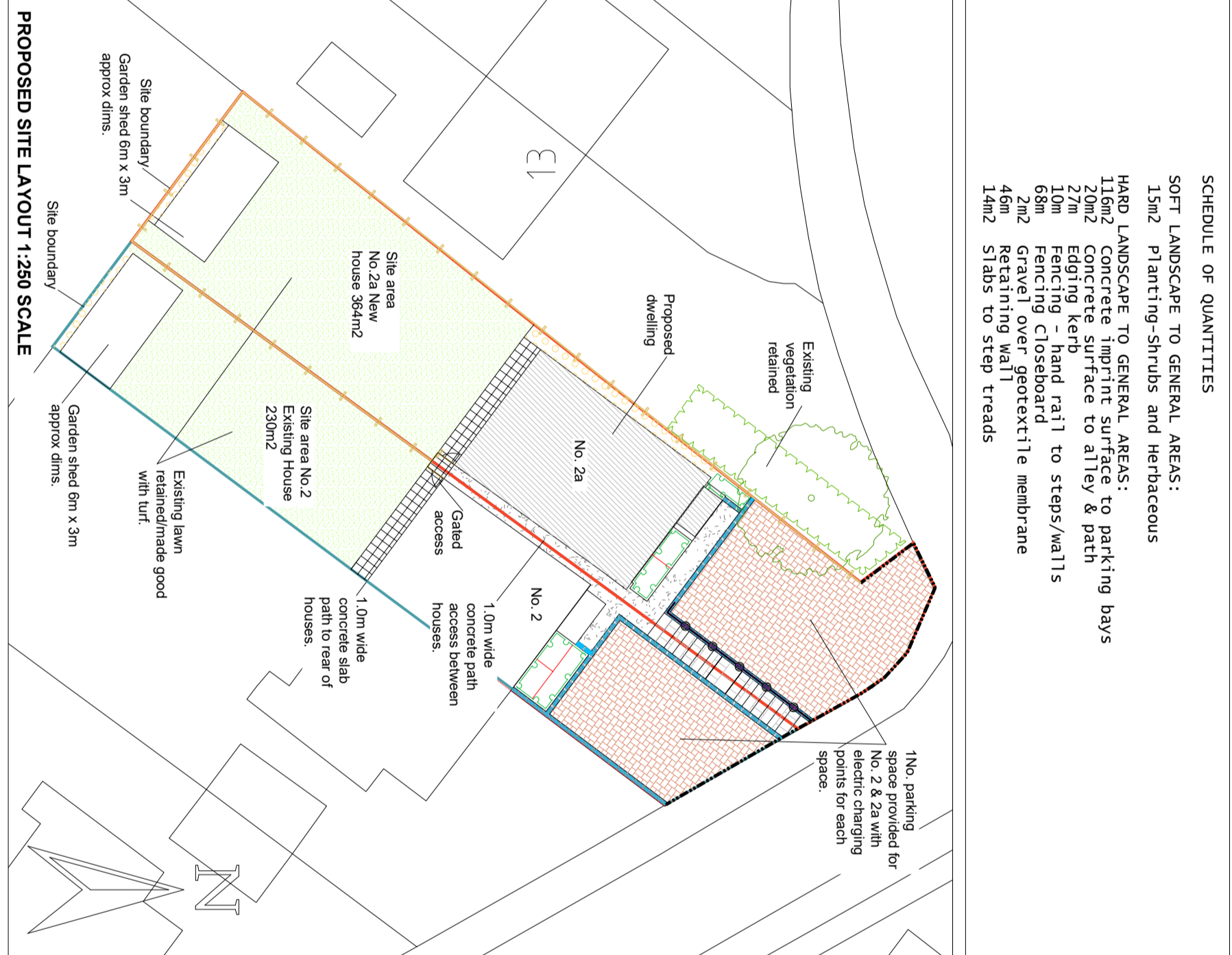

OUTLINE SPECIFICATION NOTES

IMPLEMENTATION PROGRAMME

Soft landscaping to be undertaken once all hard landscape works are completed to courtyard.

SERVICES

These landscape proposals have NOT been cross referenced against services or utilities. All services/ utilities plans and utility locations must be checked to avoid potential conflicts. Client/engineer to review and advise accordingly.

TOPSOIL PREPARATION

The raised planters shall have a fully decompacted base with existing or new free draining subsoil, free from all debris and building material placed into the base to make up levels of between 600mm to 1000mm depth. A capping layer of 400mm quality loam topsoil shall be placed into the planter over subsoil, filled to within 100mm of the top. Topsoil shall be supplied in accordance with Bourne Armenty specifications as a general landscape mix; type TS6 Premium loam or similar, with a minimum of 10% and maximum of 20% clay fines of 0.002mm size, to BS 3882:2015. The raised border shall be forked over prior to planting with 100mm depth of peat free compost added to the topsoil surface. All weeds shall be removed in full to include roots, by hand.

PROPOSED ORNAMENTAL SHRUBS

All shrubs shall be container grown, bushy and have a minimum of three breaks/ branches from the base of the plant with full root development in the container. All shrubs shall be planted at even centres, offset from the edges of the wall by 0.3m to allow for branch development.

BARK MULCH

Following planting surface topsoil shall be mulched with composted bark mulch to form a depth of 65mm, to reach 50mm after settlement. All mulch shall be a medium grade composted bark or similar approved, containing less than 5% wood. It shall be pest, disease and weed free with no Methyl Bromide contamination. Prior to mulching all beds shall be spread with a layer of slow release fertiliser and watered to field capacity.

HARD LANDSCAPE

Refer to the ELD Key for material type and size to Architects details.

VALIDATION

The Landscape Architect may inspect the planting works, without notice, at any point during the project to ensure all soiling and planting specifications are complied with, to the required standards. Any works found to be substandard or at odds to the specification shall be made good, and/or replaced by the contractor at his own expense, unless proof of Landscape Architect substitution or variation approval can be provided.

IRRIGATION

The timing and frequency of irrigation should take into account the prevailing weather conditions, soil moisture release characteristics and the response of the shrubs to water deficits, or periods of prolonged soil saturation. The frequency of irrigation is more important than the volume of water given at any one time. Increased water volumes cannot compensate for a lack of frequency. All shrubs shall be irrigated as required, using appropriate water sources to maintain good and proper plant establishment. Monitoring is recommended if there are 10 consecutive days during the growing season at >25 °C. Water should only be added if soil moisture probe/tensiometer values indicate that it would be appropriate to do so. An automated irrigation system may be required if manual watering is not undertaken throughout the summer months.

MAINTENANCE MAKING GOOD DEFECTS

The Landscape Contractor shall be responsible for maintenance of shrubs until the building is ready for occupation, where after the Resident shall be responsible for maintaining plants.

The resident shall remain liable for shrub replacement in perpetuity, to include the following works, undertaken on a regular basis throughout the year:

- Plant failures: All plants that die during the first 5 years, from any cause excluding vandalism, shall be replaced during the next planting season.
- Weeds: The planters shall be kept free of weeds in perpetuity. This shall be by mechanical or chemical methods as appropriate, in line with the manufacturer's instructions and in compliance with the Pesticides Act (1998), taking care to avoid drift onto surrounding vegetation. All arisings shall be removed to include dead stems, 1 week later following herbicide treatment.
- Mulch: All areas of bark mulch shall be topped up to 65mm depth at the end of each 12 month period and once annually thereafter, to allow for settlement to 50mm.
- Pests & Disease: All plants should be checked on a regular basis for pests and diseases. Remedial action should be taken promptly on discovery, where necessary.
- Pruning - General: Any damaged shoots or branches shall be pruned off plants using appropriate secateurs/loppers. Shrubs shall be pruned as required to prevent encroachment and obstruction to paths and to maintain shape and condition. All pruning undertaken in accordance with good horticultural practices. All arisings shall be removed.

E.L.D

ELWOOD LANDSCAPE DESIGN
 CHARTERED LANDSCAPE ARCHITECTS

<p>Surfolk Office: The Barn, Cherry Tree Farm, Mendlesham Green, Stowmarket, Suffolk IP14 5RQ. Tel: 01449 768828 E: team@e-l-d.co.uk</p>	<p>Cambridgeshire Office: The Nursery, Market Street, Fordingham, Cambridgeshire, CB7 5LQ. Tel: 01638 721066 E: team@e-l-d.co.uk</p>
<p>CLIENT: <input checked="" type="checkbox"/> ISSUED BY: <input type="checkbox"/></p> <p>PROJECT: RT DRAFTER SOLUTIONS LTD for MR MIRCEA BARUTLU ESCU BRR 7DA</p>	<p>PROJECT: PROPOSED HARD & SOFT LANDSCAPE</p>
<p>DWG TITLE: PROPOSED HARD & SOFT LANDSCAPE</p>	<p>DATE: 14TH JULY 2021</p>
<p>SCALE: 1:200, 1:250 & 1:100 @ A2</p>	<p>DRAWING NO: RTOW 559/14-001</p>
<p>DRAWN BY: AE.</p>	<p>CHECKED BY: REV.</p>

© Crown Copyright and database rights 2019. OS 100031961 National Map Centre. Purchased 18/04/2019 1 year licence.