

IMPORTANT NOTES:
Any discrepancies must be reported to ARA Architecture before proceeding.
Figured dimensions only are to be worked from.
This drawing remains the copyright of the ARA Architecture.
This drawing is supplied in order to gain Planning Permission and Building Regulations Approval only and is not to be used as a working drawing unless the Builder or Owner verifies the accuracy of the drawings by checking all dimensions, details, angles and notes on site before work commences or ordering any materials.
The Owner is to check his own deeds to verify that no restrictions or covenants exist to prevent building.
DO NOT SCALE OFF THIS DRAWING

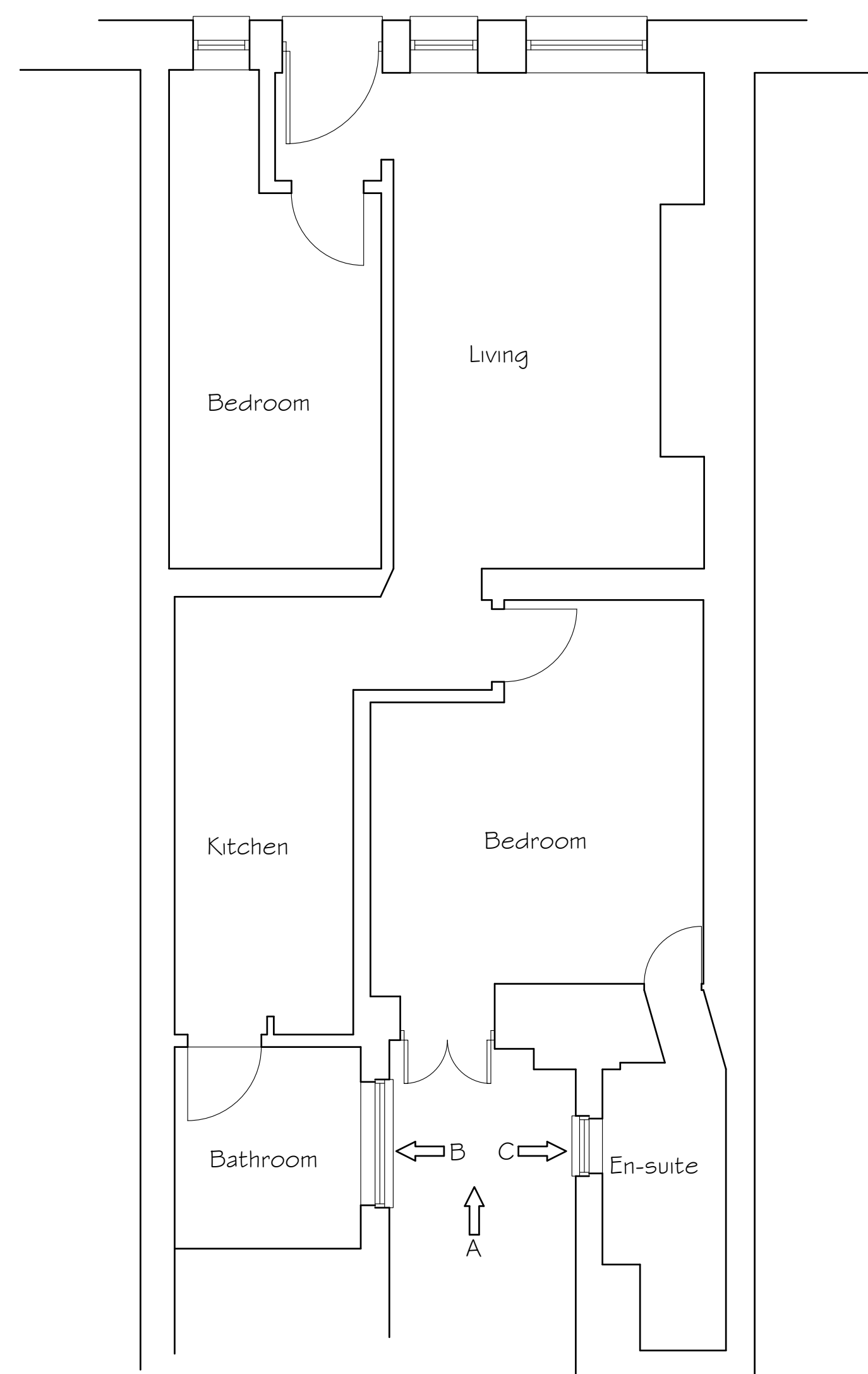

EXISTING GROUND FLOOR PLAN
1:50

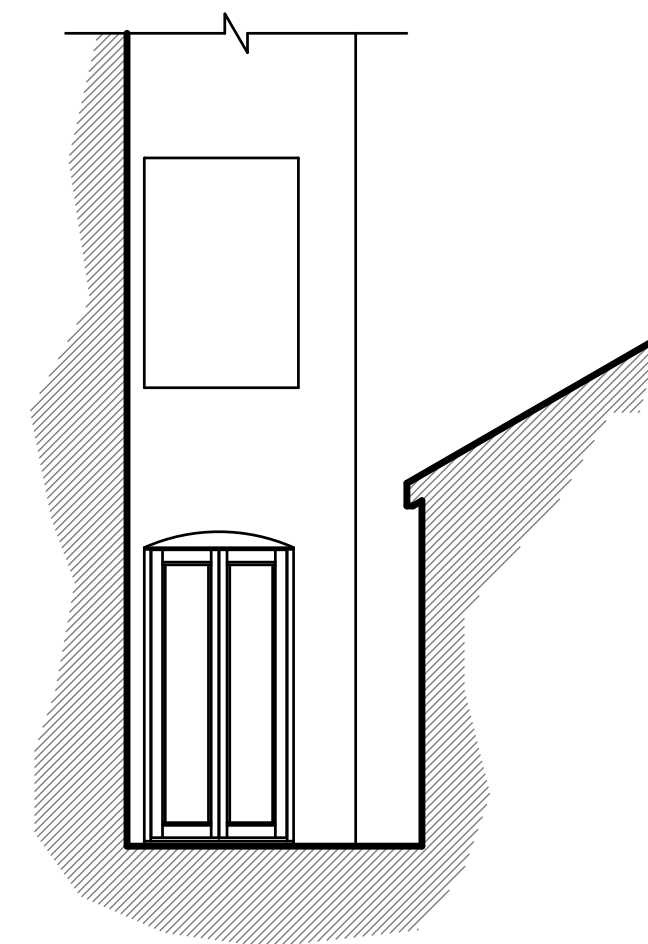

EXISTING ELEVATION A
1:50

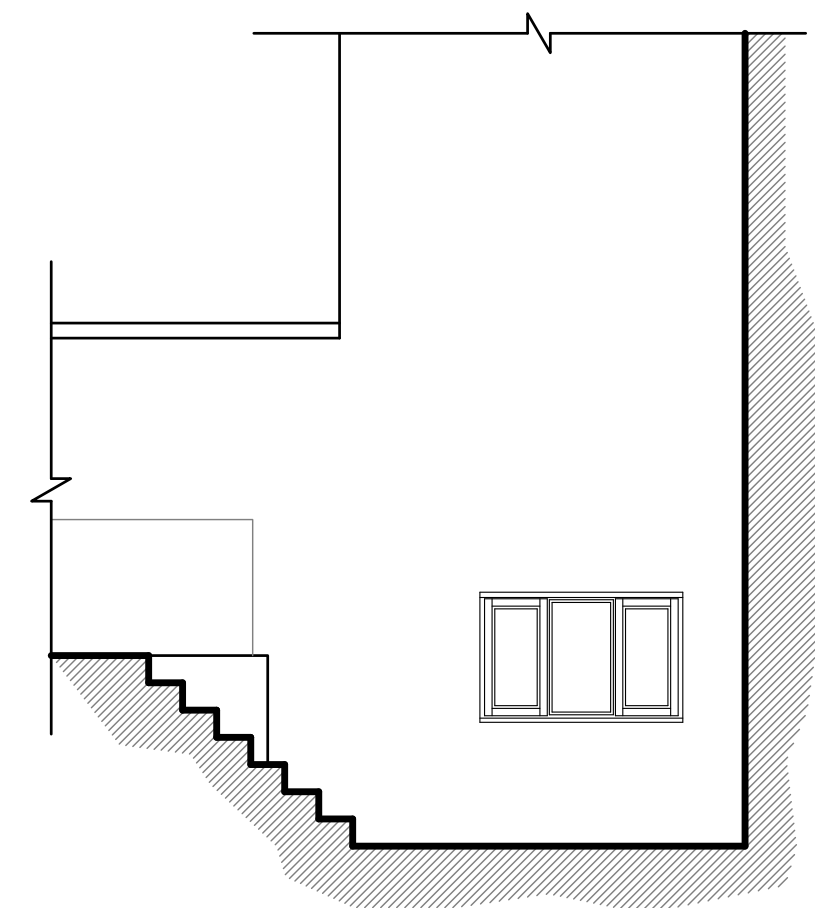

EXISTING ELEVATION B
1:50

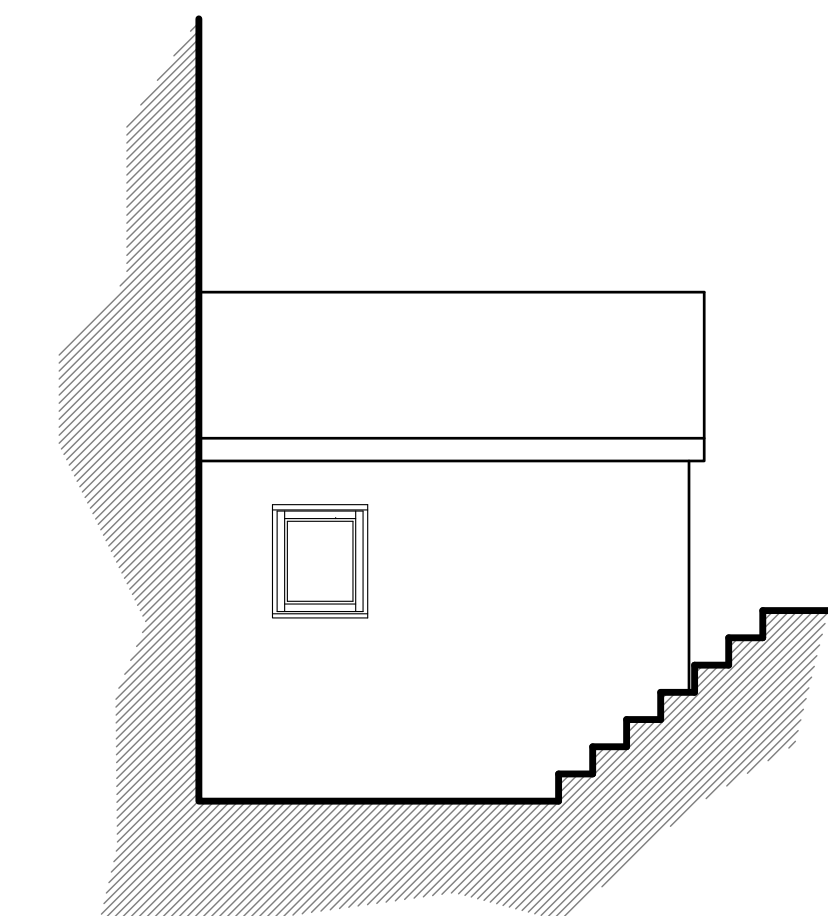

EXISTING ELEVATION C
1:50

project
PROPOSED REPLACEMENT
WINDOWS AT
5B FORTFIELD TERRACE
SIDMOUTH
EX10 8NT

drawing EXISTING PLAN &
ELEVATIONS

scale 1:50@A1 **drawn** MRP

date JUNE 2021 **checked**

drawing no. 8309-01 **rev**

ara
architecture
39 Rolle Street, Exmouth, Devon, EX8 2SN
tel: (01395) 271619 fax: (01395) 270386
e-mail: info@ara-architecture.co.uk