

SITE LOCATION
(Scale 1:25000)

Ordnance Survey MAP extract based upon Landranger MAP series with the permission of the controller of Her Majesty's Stationery Office Crown copyright. All rights reserved.

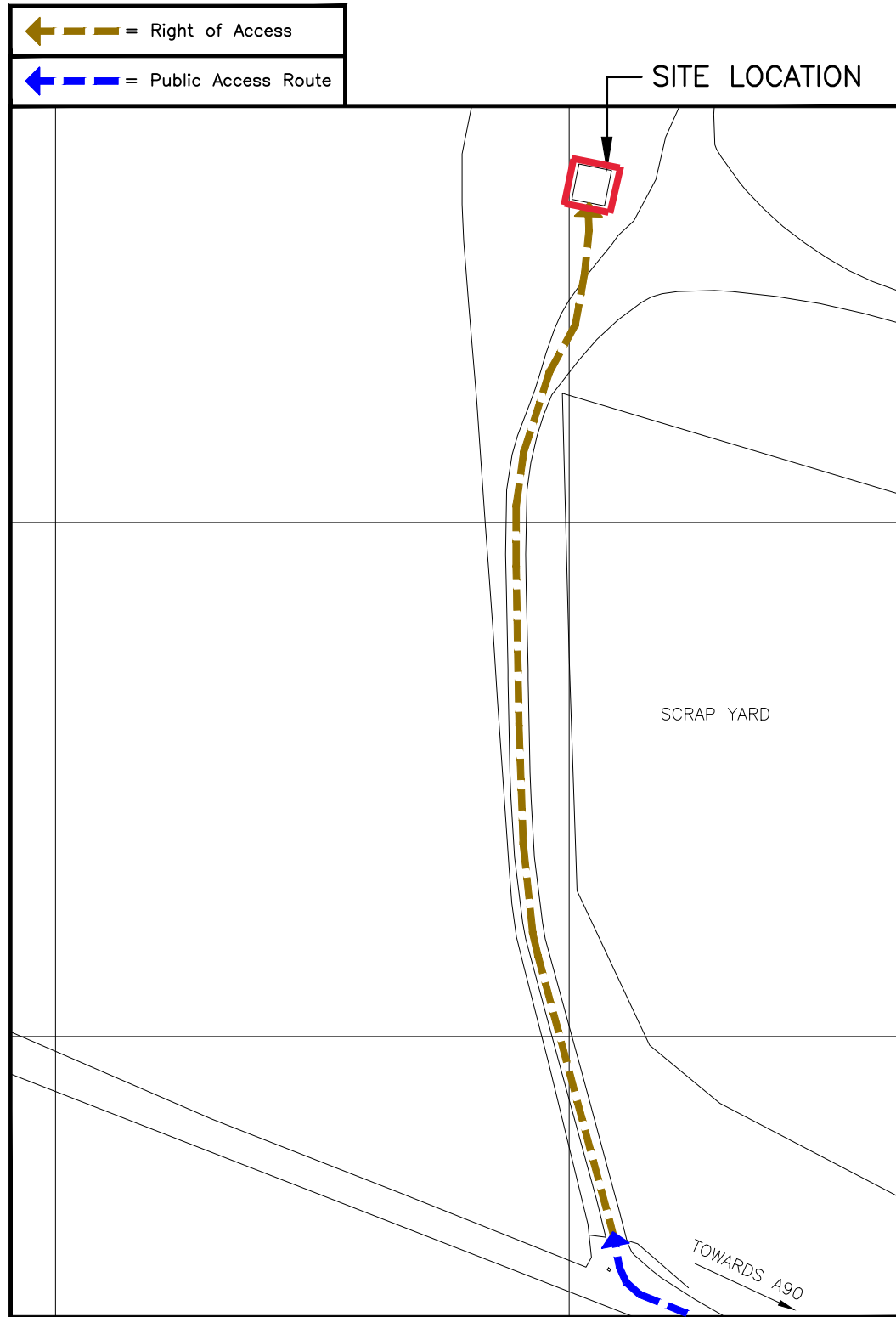

SITE PHOTOGRAPH

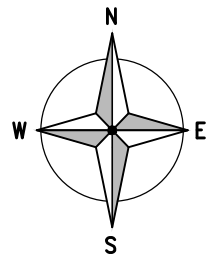

DETAILED SITE LOCATION
(Scale 1:1250)

Based upon Ordnance Survey MAP extract with the permission of the Controller of Her Majesty's Stationery Office. Crown copyright. All rights reserved.

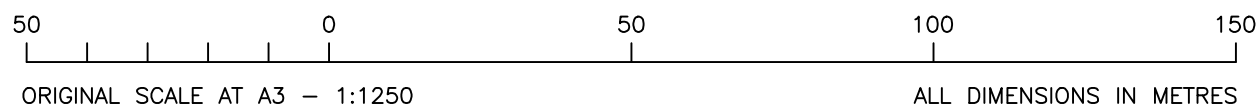

ALL DIMENSIONS ARE IN mm UNLESS NOTED OTHERWISE

N.G.R | E: 390812 N: 810068

DIRECTIONS TO SITE:
FROM THE A96 INVERNESS, HEAD INTO ABERDEEN (BUCKSBURN AREA), TURN LEFT AT THE ROUNDABOUT AFTER THE CARWASH (MAIN JUNCTION ROUNDABOUT) AND TAKE A LEFT DOWN TO BRIDGE OF DON ROUNDABOUT. TAKE THE RIGHT EXIT, AND CROSS BRIDGE OF DON OVER RIVER. AT THE NEXT ROUNDABOUT, TURN LEFT SIGNPOSTED GRANDHOME AND CONTINUE DOWN UNMARKED ROAD FOR 30 METERS. PARK UP AT THE METAL FENCE/GATE ON THE RIGHT HAND SIDE, AND FOLLOW THE TRACKTHROUGH PEDESTRIAN WOOD GATE TO THE SITE (APPROX. 800 METERS)

NOTES:

REV	Issued for Approval	MAP	FC	26.01.21
	MODIFICATION	BY	CH	DATE

Telelink Infra Services
Address: Station Road,
Woolhampton, Reading,
RG7 5SE, UK
email: office-uk@telelink.com

CORNERSTONE - BEACON 3

Cell Name		Opt.
PERSLEY GRANDHOME ESTATE		A
Cell ID No		
CORNERSTONE	TEF	VF
11351428	069241	19248
E314207		

Site Address / Contact Details
PARKHILL RD.
NEAR GRANITE HILL TERRACE
ABERDEEN
ABERDEENSHIRE
AB22 8AT

Drawing Title: SITE LOCATION MAPS			
Purpose of issue: PLANNING			Dwg Rev:
Drawing Number: 100			A
Surveyed By: Telelink		Original Sheet Size: A3	Pack Issue:
Drawn: MAP	Date: 26.01.21	Checked: SD	Date: 26.01.21
			D

The drawings comply with TEF & Vodafone Standard ICNIRP guidelines.
Designed in accordance with CTIL document: SDN0008 & SDN0009