

Furniture Legend



Tables:
Nolita 5453T outdoor powder coated steel flip-top tables. 600mm Ø, 720mm high. Light Grey colour.
10no. in total



Chairs:
Nolita outdoor powder coated steel seats. 590mm wide, 530mm deep and 850mm high. Light Grey colour.
30no. in total



External Planters:
Reclaimed timber finish with mild steel frames on castors. 1400x400x900mm (WxDxH)
6no. total



A-Board:
Black powder coated frames with interchangeable graphics board. 624x590x1054mm (WxDxH)
1no. in total

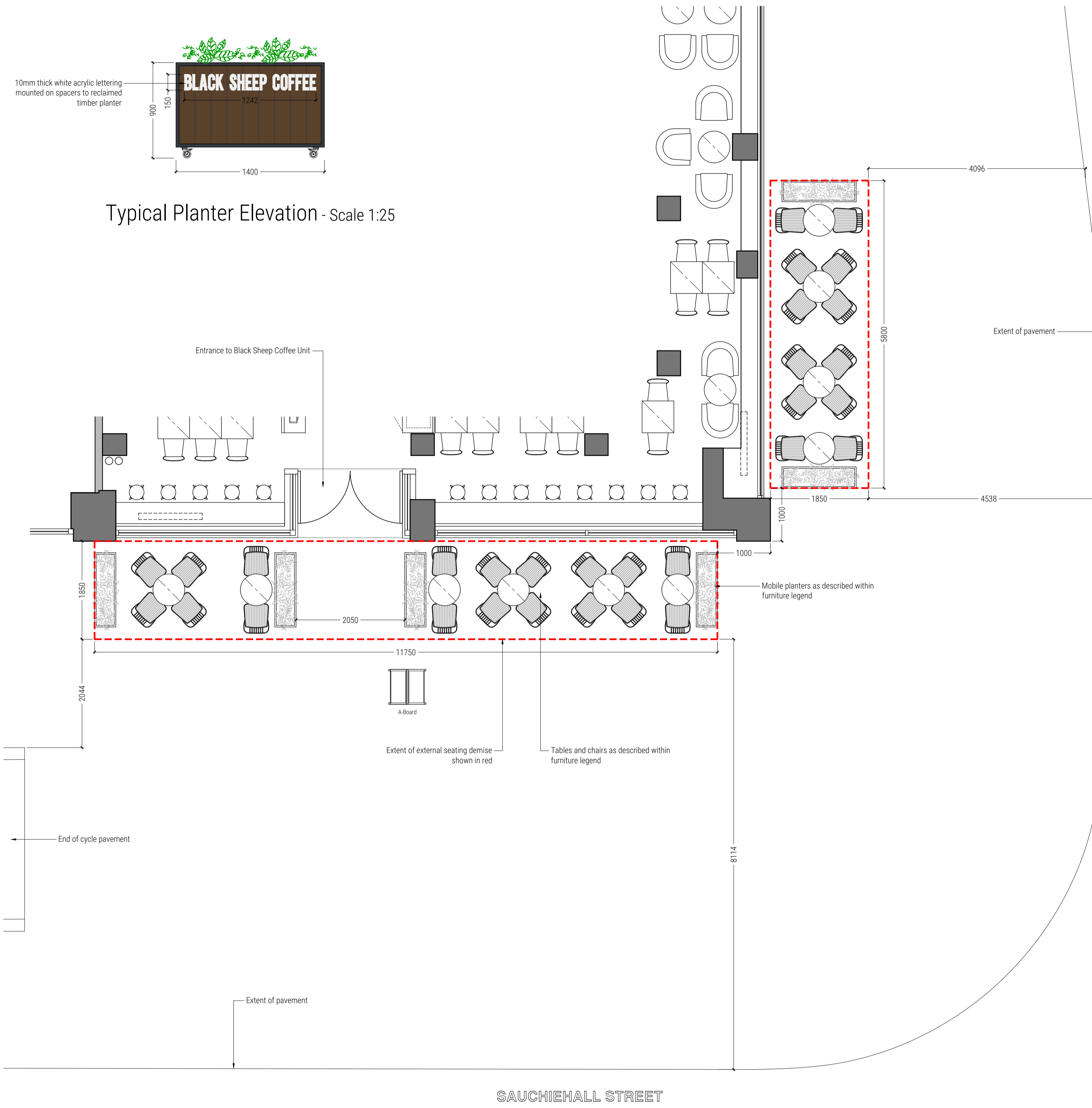

Proposed External Seating

DO NOT SCALE FROM THIS DRAWING. THE AUTHOR OF THIS DRAWING TAKES NO RESPONSIBILITY FOR ANY DIMENSIONS OBTAINED BY MEASURING OR SCALING FROM THIS DRAWING AND NO RELIANCE MAY BE PLACED ON SUCH DIMENSIONS. ALL DIMENSIONS MUST BE CHECKED AND VERIFIED ON SITE BY THE CONTRACTOR BEFORE COMMENCING ANY WORK OR PRODUCING DRAWINGS. RML ARCHITECTURE MUST BE NOTIFIED IMMEDIATELY OF ANY ERRORS OR DISCREPANCIES PRIOR TO THE COMMENCEMENT OF WORK.

THIS DRAWING IS TO BE READ IN CONJUNCTION WITH ALL OTHER RELEVANT CONTRACT DRAWINGS, SCHEDULES AND SPECIFICATIONS.

THIS DRAWING AND ALL INFORMATION CONTAINED WITHIN IS THE SOLE PROPERTY OF RML ARCHITECTURE LTD AND MAY NOT BE REPRODUCED IN WHOLE OR PART WITHOUT WRITTEN PERMISSION FROM RML ARCHITECTURE LTD.

REV	DESCRIPTION	DATE	BY



CLIENT



PROJECT
BLACK SHEEP COFFEE MCLELLAN WORKS
SAUCHIEHALL STREET
GLASGOW
G2 3EH

DRAWING TITLE
PROPOSED EXTERNAL SEATING

PROJECT NUMBER 9553 DATE JUNE '21

SCALE 1:50 @ A1 / 1:100 @ A3 DRAWN BY RML

DRAWING NUMBER 9553-P-07 REVISION -

DRAWING STATUS APPROVAL

NOTE: All external furniture is free standing and stored within shop during non trading hours.
TOTAL EXTERNAL COVERS: 30no.

