

DO NOT SCALE FROM DRAWING
(Except for Town Planning purposes)

This drawing is the copyright of JON BUTCHER ARCHITECT

All dimensions are to be checked on site and any discrepancies reported to the project Architect.

Unless otherwise stated dimensions are taken to structural elements.

All foundation work shown is provisional and subject to on site approval by the Local Authority.

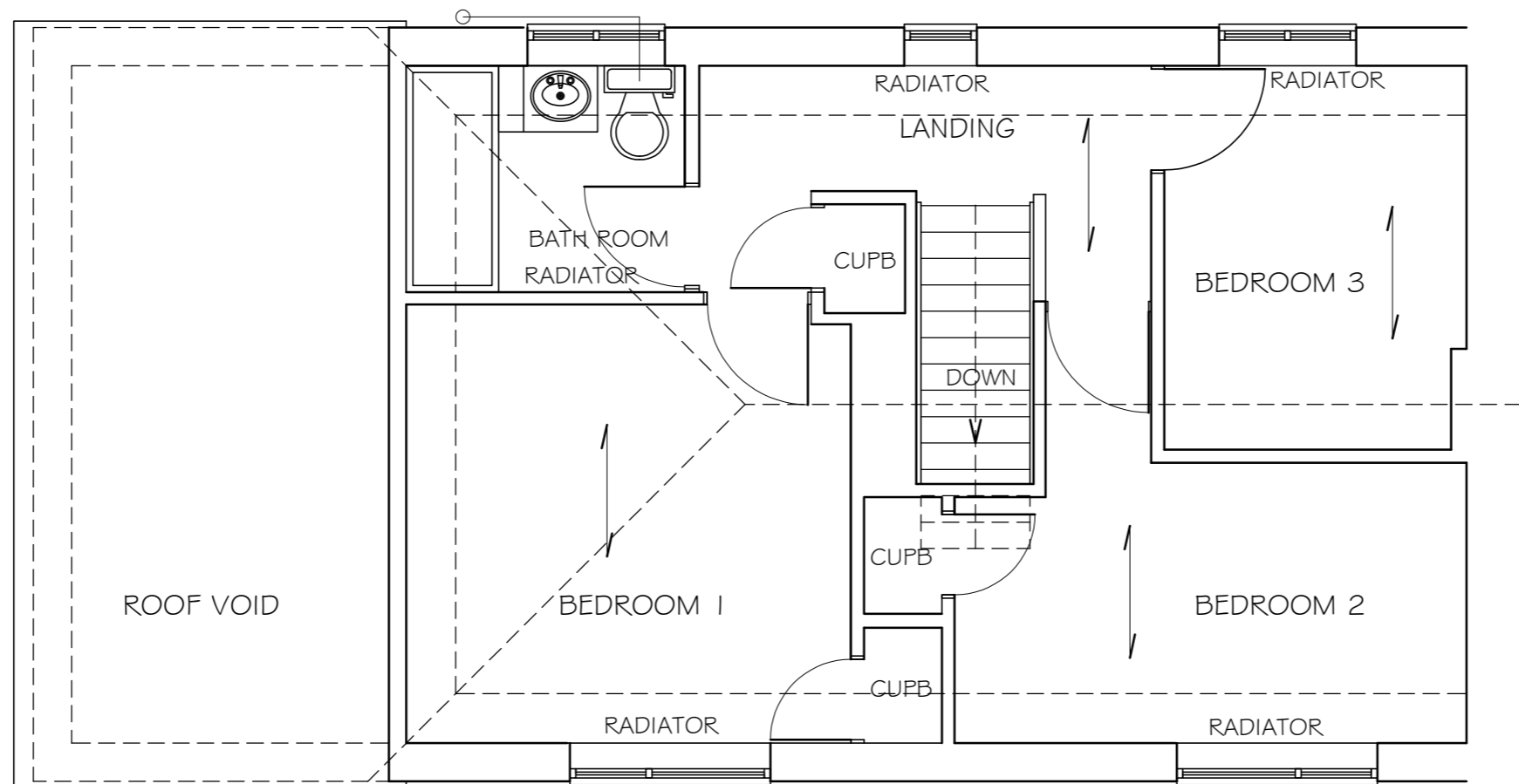

revisions

PROPOSED EXTENSION TO
2 NEW COTTAGE
MILL LANE
UNDERRIVER
SEVENOAKS TN15 0SE

FIRST FLOOR PLAN AS EXISTING

 **Jon Butcher Architect**
ARB Registered Architect

81 HILDEN PARK ROAD HILDENBOROUGH TONBRIDGE TN11 9BW
TEL 07305 132 191 jonbutcherarchitect@gmail.com

Scale 1:50 @A3 Date JUNE 21 Drawn JWB

1 | 2 TP.04