

Drawing Number :
HD/TN10 4AU/PROP-GROUND

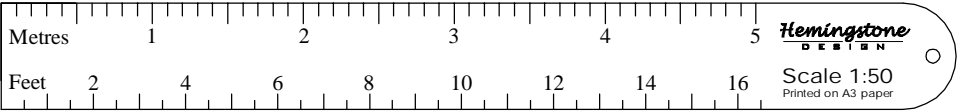

Proposed
Extension
to
127 Estridge Way
Higham Wood
Tonbridge, Kent
TN10 4AU
for
Mr & Mrs M. Wheeler
Local Planning Authority:
Gravesham Borough Council

- Legend
- Tiled Roof
 - Stud Partition
 - Blockwork
 - Brickwork

Unit 1
Claydon Business Park
Great Blakenham
Ipswich
Suffolk
IP6 0NL

Telephone:
0771 400 3663
Email:
hemingstone@btinternet.com

Construction to be to current NHBC standards with all work complying to current Building Regulations. Client and contractor are to be aware of The Party Wall Act 1996. Please ensure there is agreement from adjoining owners before work commences. It is also the responsibility of the client to obtain planning permission where necessary, or to ensure that permitted development rights have not been restricted or removed and there are no restrictive covenants nor special conditions within the property deeds etc which may affect the proposal. Contractor to set out to ensure all work close to adjacent boundaries, including foundations, roof overhangs and gutterings are within the curtilage of the site.

Although this document is printed to scale deformations may occur during the drafting and printing of the plan. All dimensions and information on the document must therefore be checked on site for accuracy and approved with the Building Inspector prior to the commencement of works.

This document is produced for negotiations with the relevant local authorities for approvals under the Building Act and the Town and Country Planning Acts only. All information is also subject to approval under the Building Act and the Town and Country Planning Acts.

© This drawing is copyright and is not to be reproduced without the written permission of Hemingstone Design.
All drawings have been prepared by Rob Hutton, a sole trader, trading as Hemingstone Design.

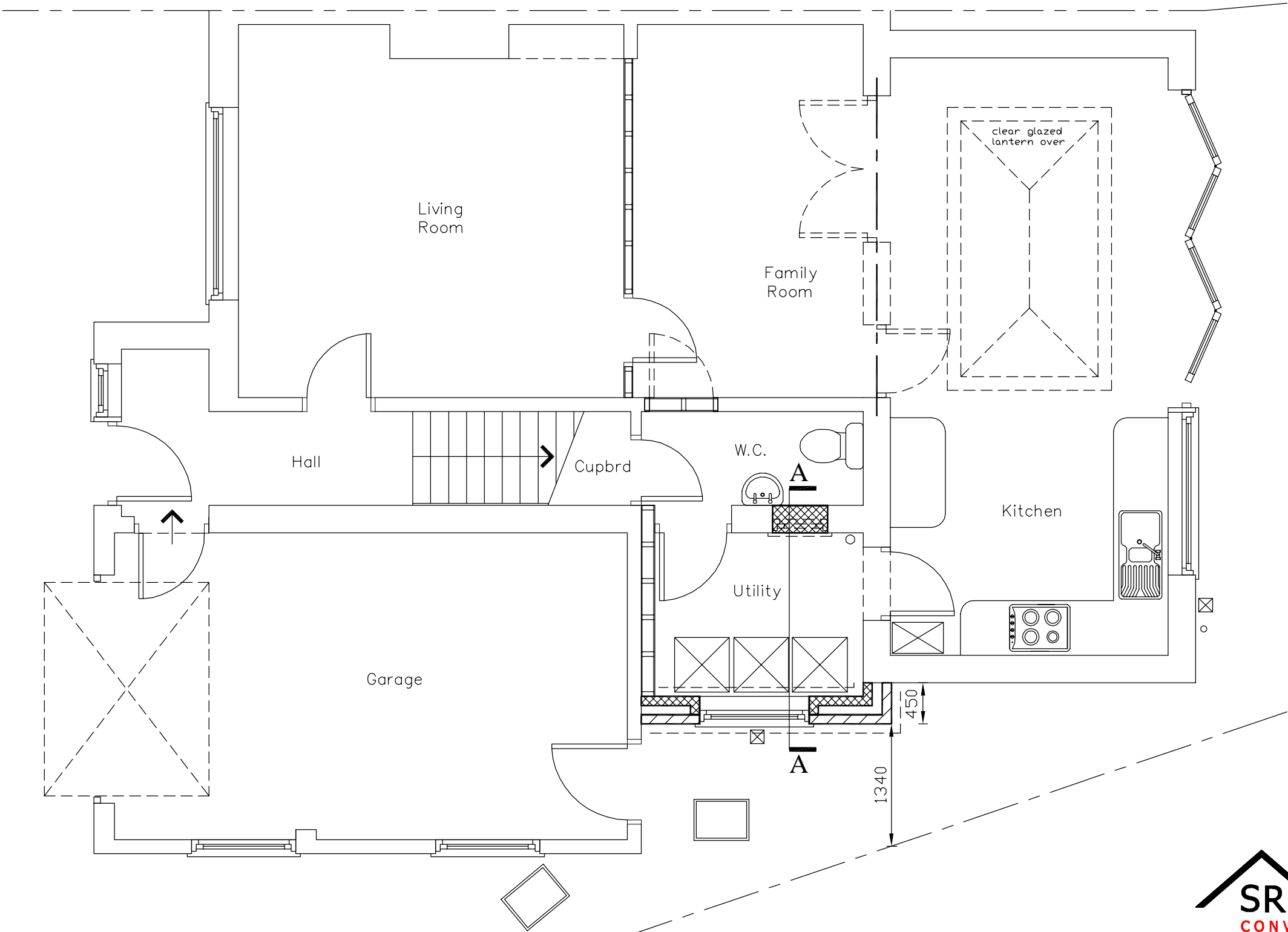

Proposed Ground Floor Plan

SR LOFT
CONVERSIONS
tel 01322 869851

PREPARATIONS AND CHECKS
Contractors must verify all dimensions, levels and boundaries on site before commencing any works.
All existing lintels, beams, foundations etc. taking any new loads are to be exposed and re-assessed for the new load and to be re-inforced or replaced as necessary at the discretion of the Local Authority.
All structural information should be checked against detailed structural engineers information and calculation sheets.
Contractor to assume design responsibility under CDM 2015.