

**Warm Flat roof:**  
 150 x 47mm C24 timber joists @ 400cc inc all the fittings (6x2);  
 Novia FF1 Vapour Control Membrane;  
 100mm Xtratherm rigid insulation between rafters/ noggins;  
 18mm WBP plywood;  
 50mm Xtratherm rigid insulation;  
 18mm WBP plywood;  
 High performance fibreglass roof & all materials inc upstands or 6D  
 ClassicBond Rubber Roof EPDM (1.5mm thick) the client decide;

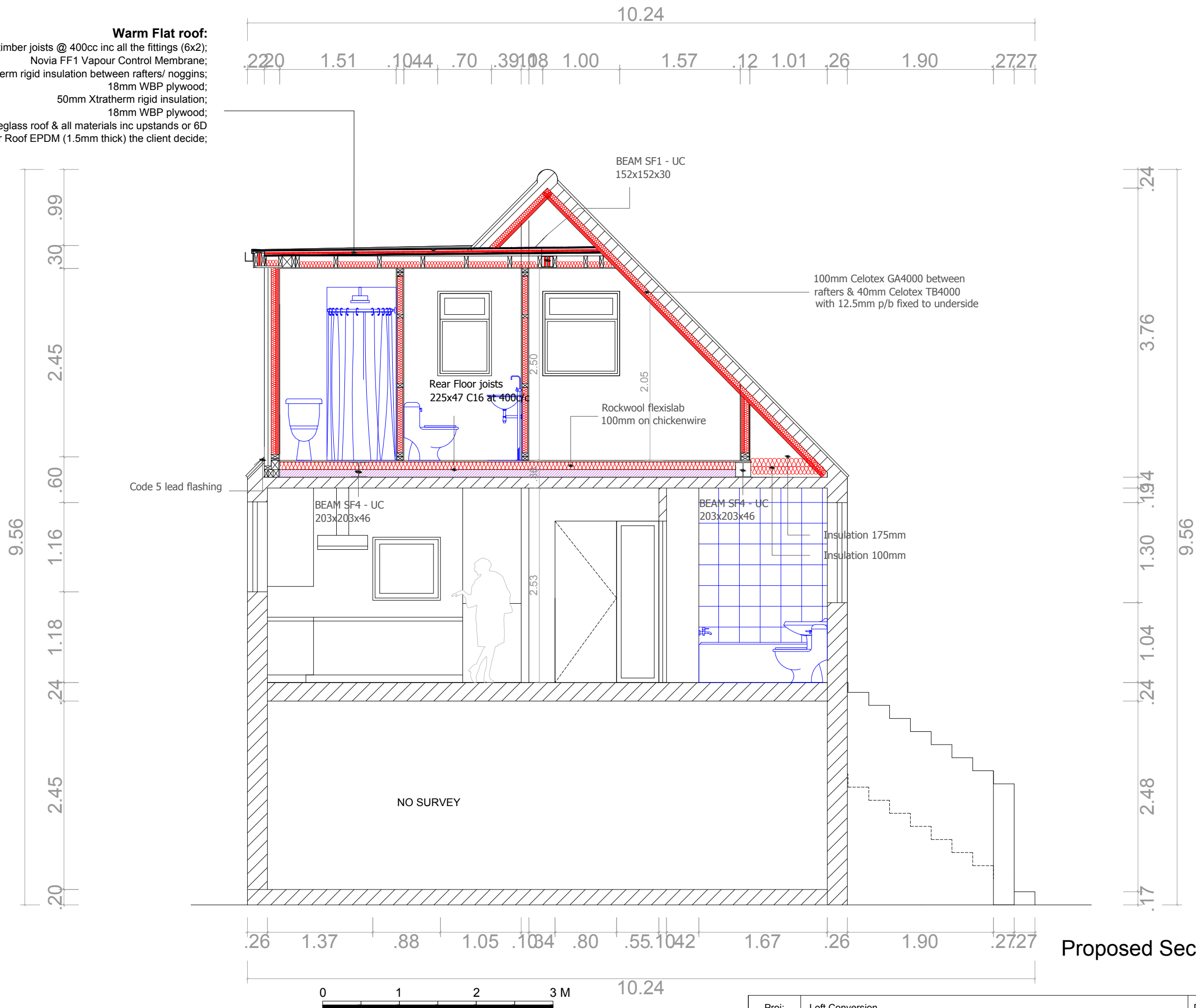

**Proposed Section A**

Status:  
 This drawing is intended for the purpose indicated in the status box only.  
 Do not scale from this drawing. All dimensions shown must be checked on site and discrepancies verified with the contract administrator.  
 This drawing must be read in conjunction with relevant Details and specifications show.

Proj:	Loft Conversion	Date:	July 2021	ARCH.
Prop:	Ana Loureiro	Esc:	1/50	
Drawing	Proposed; Section A	Loc:	1A Westview Close London NW10 1RH	10
		Act:	Paulo do Nascimento Pinheiro Afonso Architect	