

No. 75.

WET ROOM

KITCHEN

No. 73.

UNDER PASSAGE

No. 71.

INTERNALLY NOT SURVEYED AT THIS TIME

EXISTING EXTENSION NOT SURVEYED.

DRAINAGE TO BE REMOVED + RAMPS + RAILS ETC.

DRAINAGE TO BE RESITE AS NECESSARY

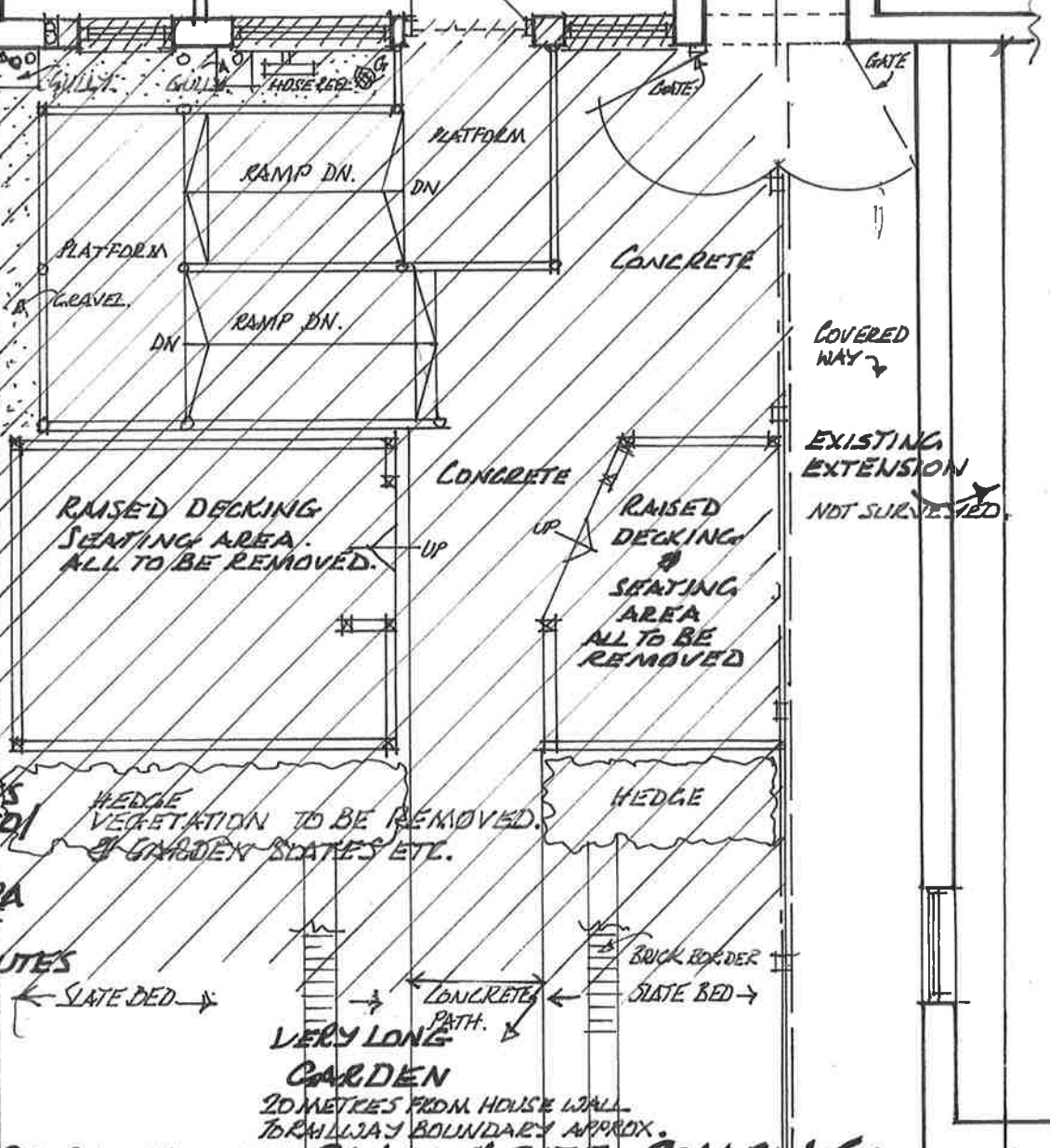

HATCHED AREA INDICATES AREAS TO BE DEMOLISHED / CAREFULLY REMOVED.

NO DRAINAGE CAMERA SURVEY HAS BEEN CARRIED OUT OR ROUTES UNDERGROUND ESTABLISHED AT THIS STAGE OF SKETCH PROPOSALS.

HEDGE VEGETATION TO BE REMOVED. GARDEN SLATES ETC.

VERY LONG GARDEN 20 METRES FROM HOUSE WALL TO RAILWAY BOUNDARY APPROX.

EXISTING PART HOUSE PLAN & SITE. SCALE: 1:50

DISABLED FACILITIES FOR MR. STEVEN BROWNBRIDGE. 73. GARFIELD TERRACE, LEEMAN ROAD, YORK. YO26 4XT.

(THERE IS NO WHEEL CHAIR ACCESS OR EXIT VIA THE FRONT DOOR OF THIS PROPERTY)
* EXISTING & PROPOSED SKETCHES SCHEME 'B' PRODUCED FOR CLIENT BY O.T. / GRANT DEPT. CONSIDERATION / COMMENTS. *

City of York Council
 19 JUL 2021
 RECEIVED

DO NOT SCALE OFF THIS DRAWING



ARCHITECTURAL · PERSPECTIVE · TECHNICAL · DRAWING · SERVICE

DRG No.: 2021/1140: EX. 01
DATE: APRIL / MAY 2021

ROZ AGAR 132, KNAVESMIRE CRESCENT,
YORK YO23 1EU 01904 653983 ©