

360700.

184400.

360900.

184400.

184200.

360700.

184200.

360900.

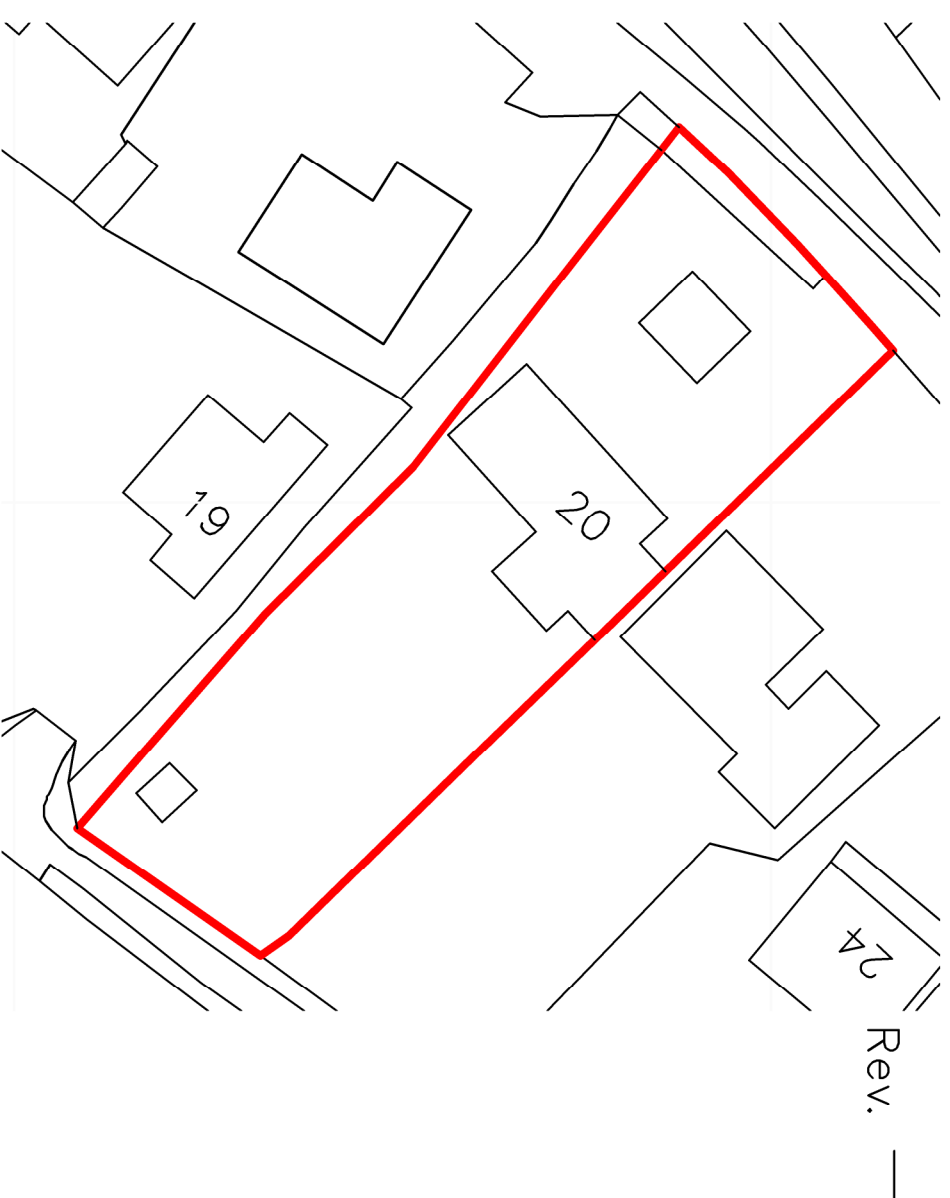

Rev. —

Existing Site plan
scale 1:500 @ A3

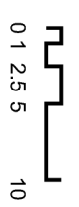

GRID REF:
360847, 184284

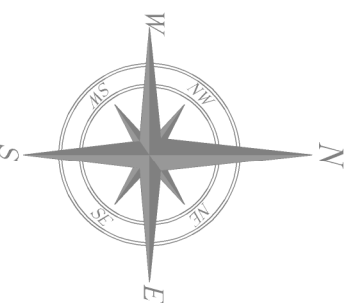

-NOTE-
All dimensions to be checked on site by contractor prior to commencement of any & all works & manufacture of prefabricated items. Any discrepancy or query to be reported and clarified before any associated / all work proceeds. All construction to be in accordance with current relevant Trade and Professional Standards and Guidelines. Statutory requirements and product manufacturers specifications and details. Read drawing in conjunction with finishing specification, workmanship specification, all other associated drawings issued and details which may be issued from time to time.
GSH Architects Ltd 2021
All rights reserved / All copyrights retained

Revision

Title
20 THE SCOP
ALMONDSBURY
BRISTOL

Description
EXISTING SITE #LOCATION PLANS

Dwg. No
21/03-43/001

Scale
Scale as shown @ A3

Date
APRIL 2021

gsh architects
Chartered Architects

3 Hallow Road
Almondsbury
South Gloucestershire
BS32 4DP
Tel: 07516 522885
email: info@gsharchitects.co.uk

Existing Location plan
scale 1:1250 @ A3

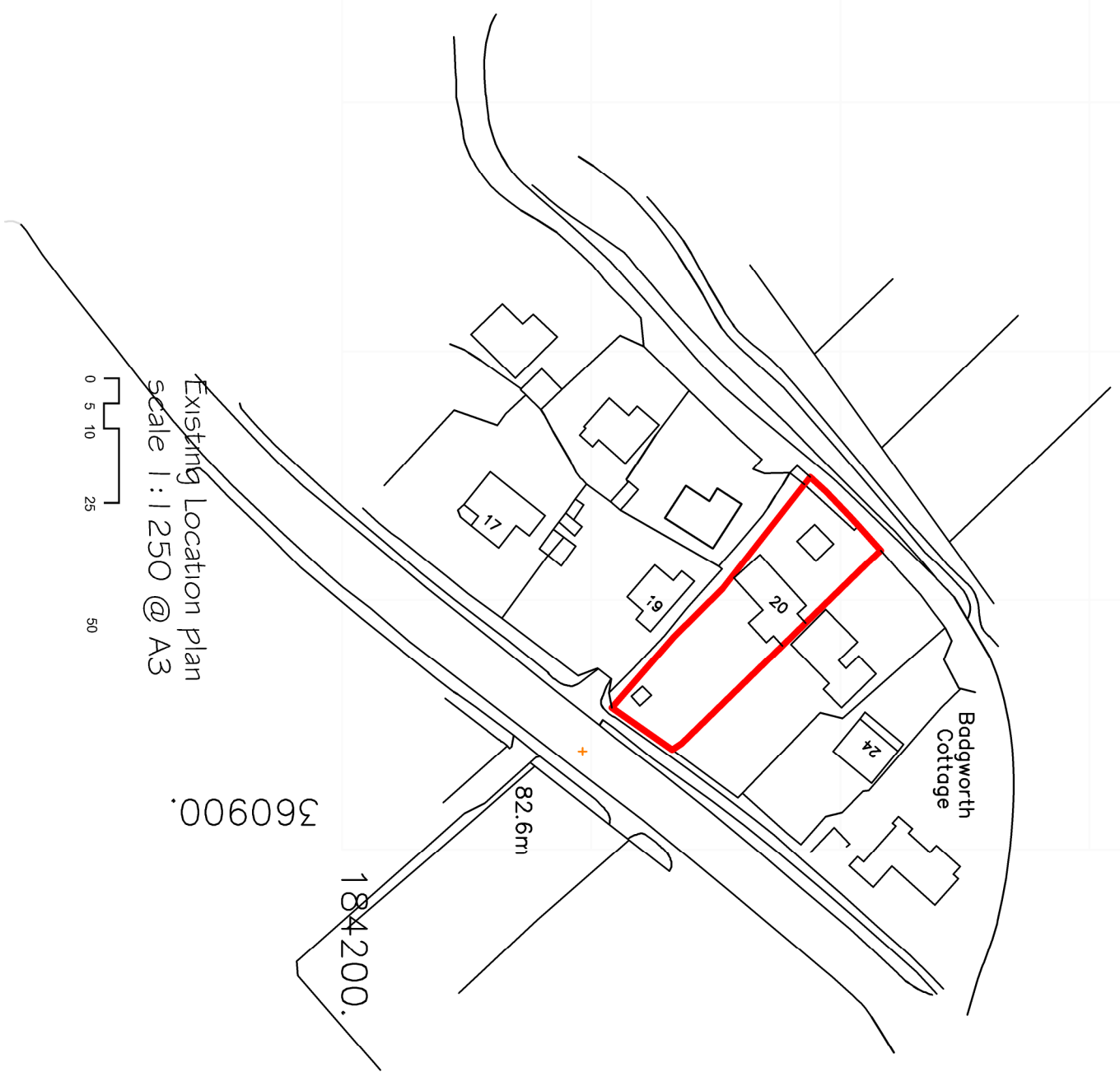
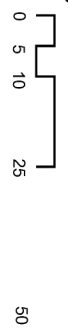

Badgworth
Cottage