

SHRUBS MARKED THUS TO BE A MIXTURE OF
 LAVANDULA 'MIDCOTE PINIC', VERBA, 'MIDCOTE WHITE',
 'COTON EASTER', 'CORAL BEAUTY', 'SIMONSII', CORNUS
 ALBA ELEGANTISSIMA AND SANGUINEA.

ALL PLANTING SE
 CARRIED OUT IN 'A1
 OCCUPATION OR CC
 WHICHEVER IS SOO

65M

62

MIN 1200MM HIGH
 CHAINLINK, GREEN
 PLASTIC COATED ON
 METAL POSTS

HEDGEROW PLANTING
 AROUND PERIMETER
 OF SITE

900 MM HIGH
 CHAINLINK,
 GREEN PLASTIC
 COATED ON
 METAL POSTS

1800MM HIGH
 TIMBER PRIVACY
 PANEL, 1800MM
 LONG

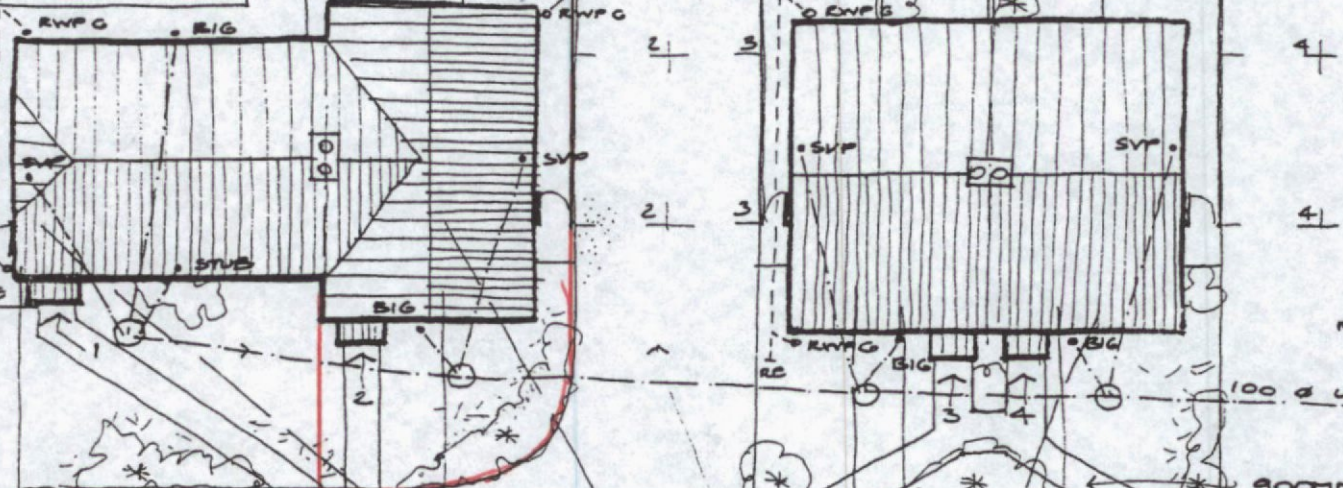

SHINGLE ROLED IN
 GRASS

900MM
 PATHS W
 STANDA
 OUTSIDE
 DOORS
 1200MM

BLACK TERRAZZO FINISH
 TO DRIVE FOR FIRST 6 METRES

CROSSOVER

SHARED ACCESSES MIN.
 5 METRES WIDTH

HALL ROAD

HEDGEROW PLANTING

80% 'CRATGEUS MONOGYNA' (HAWTHORN)
 10% 'ALER CAPESTRE' FIELD MAPLE
 10% 'VIBURNUM OPULUS' GUELDER ROSE
 FIRST ROW SET 300MM FROM BOUNDARY,
 SECOND ROW A FURTHER 500MM FROM FIRST
 ROW AND PLANTED AT 200MM CENTRES. ALER
 AND VIBURNUM STAGGERED AT 500MM CENTRES

PROPOSED TREES

- 1. MALUS SYLVESTRIS : CRAB APPLE
- 2. PRUNUS AVIUM : GEAN 1.2-1.8
- 3. PRUNUS 'TAI HAKU' : GREAT WHITE
- 4. MORUS NIGRA : BLACK MULBERRY
- 5. MAGNOLIA GRANDIFLORA