

Existing

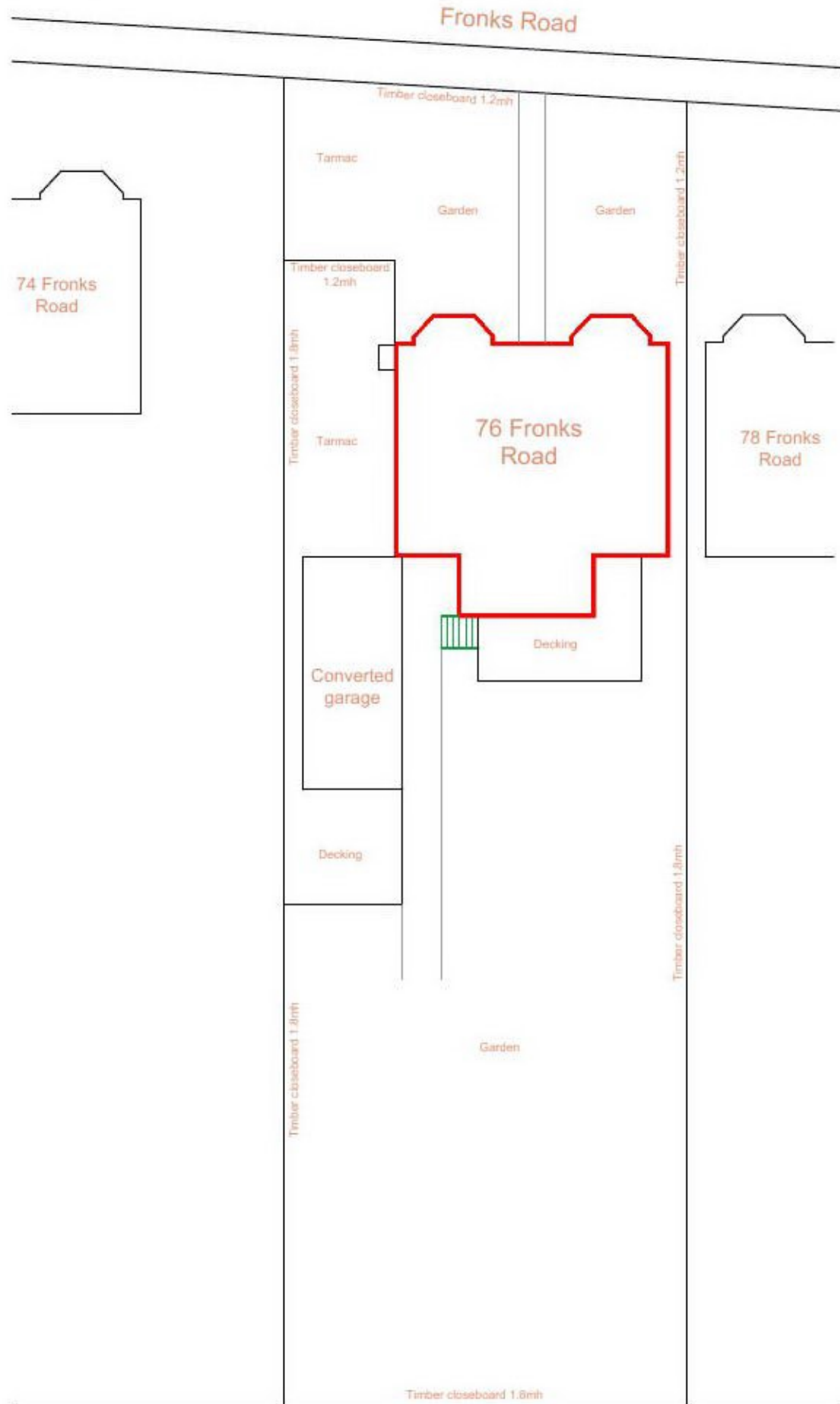

Proposed

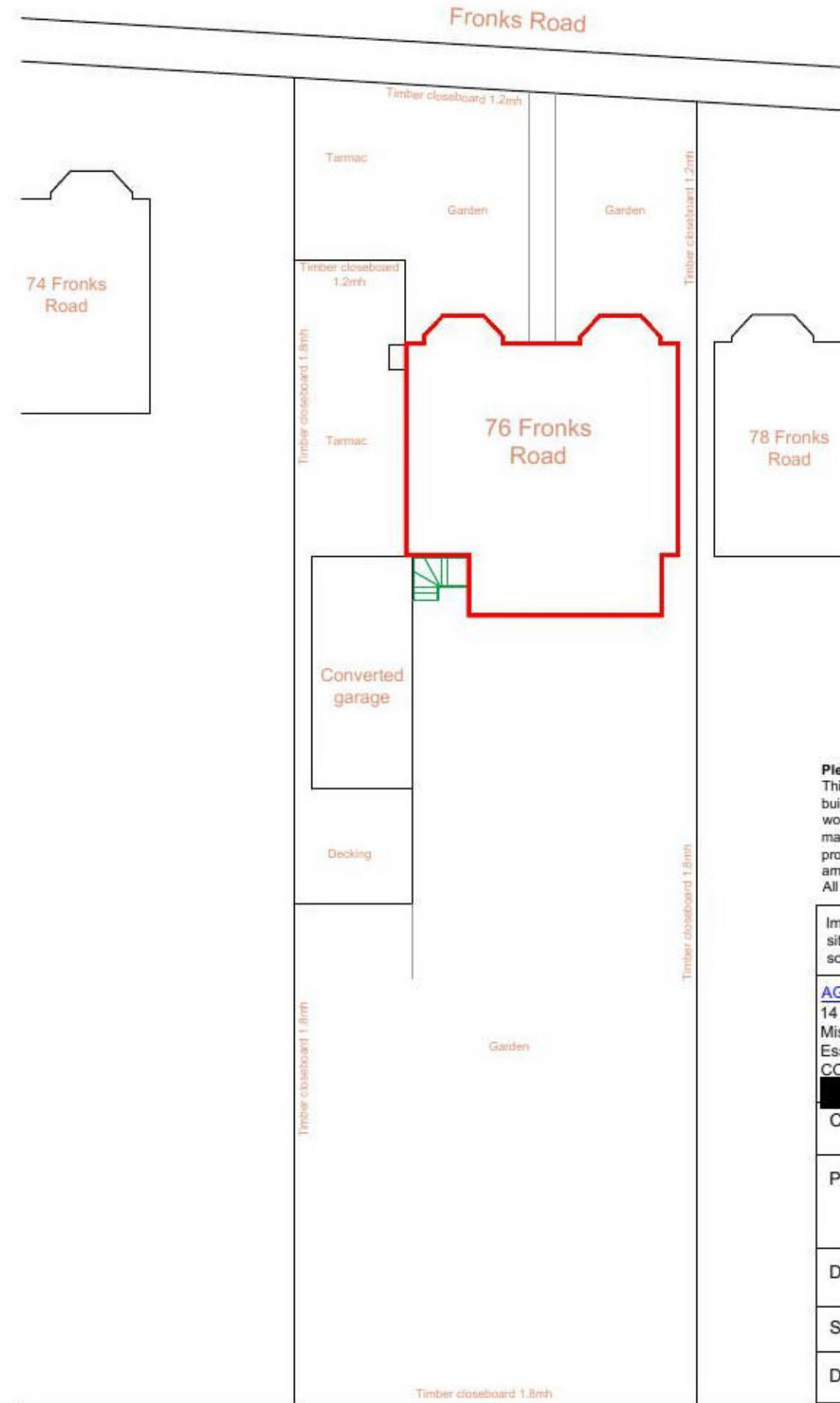

**Please note:**  
 This drawing is to be used as a aid to achieve planning / building regs approval and as a guide for the proposed works . Dimensions, levels and existing construction materials are to be checked on site prior to construction of proposed works. Therefore, design can be subject to amendment.  
 All structural work to be overseen by a structural engineer.

Important note: All measurements to be checked on site before any construction takes place. Do not scale from this drawing.

AGC Consultants 14 Seafield Ave. Mistley Essex CO11 1UE	
Client	Richard Bench & Joanne Hone
Project title	Rear extension at: 76 Fronks Road, Dovercourt CO12 3RS
Drawing title	Site plans
Scale	1:200@A3
Date	05/07/21
Dwg No	0343/PL/05
Rev No	