

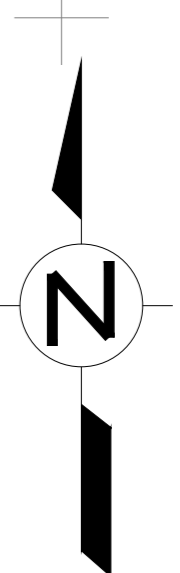

APPENDIX 2 ROOT PROTECTION AREA PLAN A3 SERVICES NORTH

Root protection area in meters radially from centre of stem.

As above but tree to be removed

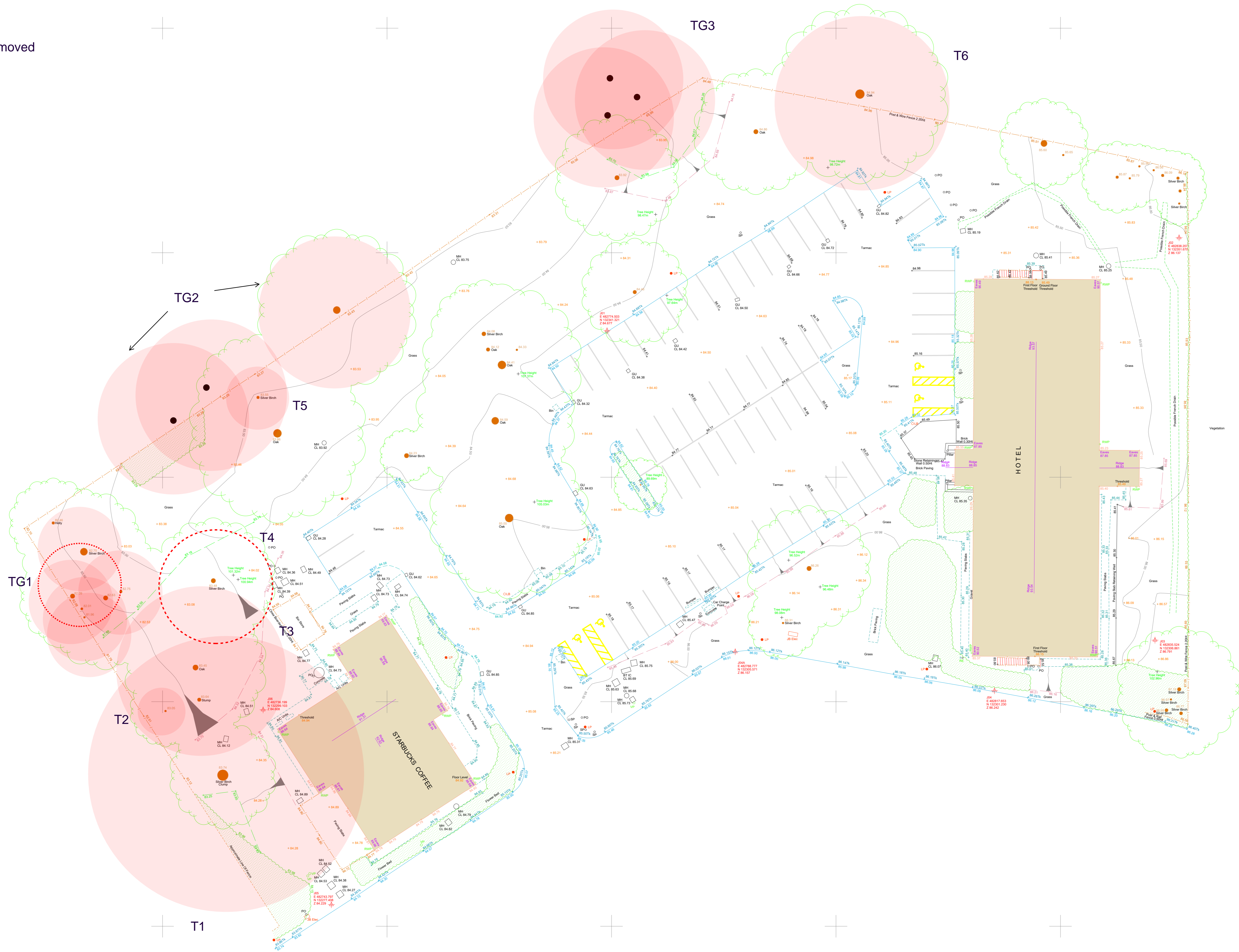

LEGEND

UTILITY LINES		TOPOGRAPHIC & UTILITY DETAILS	
Water	Water	Manhole	Manhole
Sewer	Sewer	Manhole Cover	Manhole Cover
Gas	Gas	Electric Pole	Electric Pole
Electric	Electric	Electric Cable	Electric Cable
Other	Other

GENERAL NOTES

1. This drawing is prepared for the purposes of the site and does not constitute an offer of any services.

2. All utility locations are based on the latest available data and should be confirmed before any work commences.

3. Root protection areas are shown in red and are based on the trunk diameter of the tree and its spread.

4. Trees marked as 'to be removed' are shown with a dashed red circle.

SHEET LAYOUT

Sheet 01

Rev	Notes	Drawn	Date

Notes:

Survey is referenced to OS Grid and Level Datum.

SUMOs SERVICES Ltd
 SUMOs SERVICES Ltd
 100 LANE
 HAZELWOOD
 HANTS RG26 4RQ
 TEL: 01494 654 116
 FAX: 01494 654 183
 www.sumoservices.com

Title: Topographical Details

Client: East Hampshire District Council

Project: Liphook Services A3 Northbound, Hampshire.

Date Completed: 14/09/2018 Post Code: GU30 7TT

Drawn	EGJ	Scale:	1/200 (A0 Sheet)
Checked	JHG		

Job No: SOR013495 Dwg No: 01 Rev: