

DWG INFO: \\CB-BRI-APP01\DATA-BRISTOL\BS1192\B05581 - CRIBBS TRIANGLE FOODSTORE\01_WIP\DR_DRAWING\B05581-C-250B-251B-252 - VEHICLE TRACKING - ARTICULATED

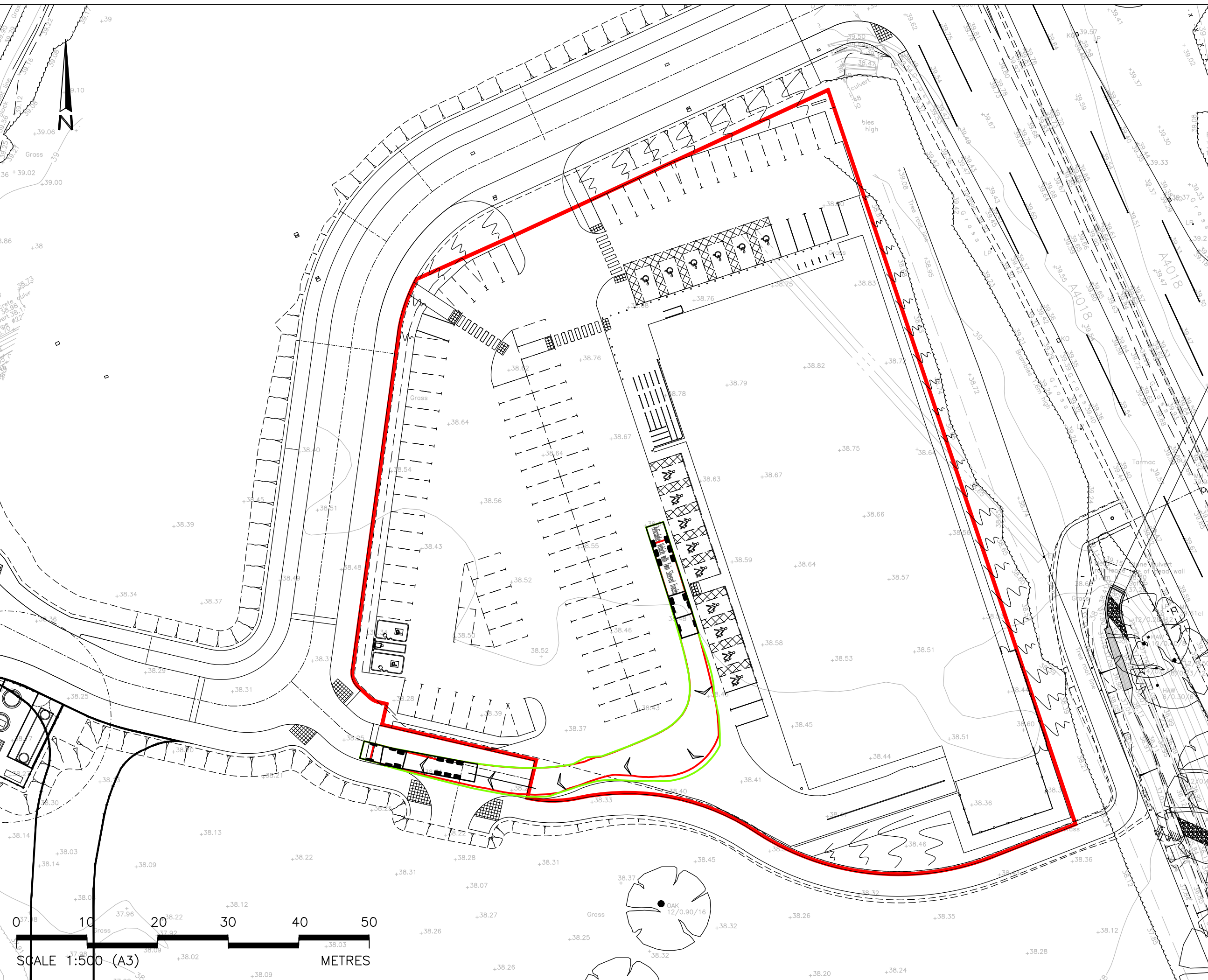

CDM RESIDUAL RISKS
 The work shown on this drawing is both familiar to the designers and routinely safely built in similar circumstances by competent contractors.
 Risks are not considered significant.
 Relevant data is included in the Pre-Construction Information Pack
 Signed: **D. HENSON** Date: **13.05.21**

DO NOT SCALE THIS DRAWING FOR CONSTRUCTION PURPOSES.

CONTRACTOR TO CHECK ALL DIMENSIONS AND REPORT ALL ERRORS AND OMISSIONS TO THE ENGINEER

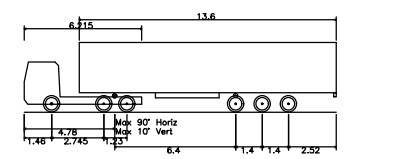

Articulated Vehicle with Twin Steered Tractor
 Overall Length 16.500m
 Overall Width 3.691m
 Overall Body Height 3.691m
 Min Body Ground Clearance 0.426m
 Max Track Width 2.500m
 Lock to lock time 6.00s
 Kerb to Kerb Turning Radius 6.987m

A	TRACKING AMENDED TO SUIT LAYOUT.	MY	DH	15.07.21
*	PRELIMINARY FIRST ISSUE.	MY	DH	18.06.21

Rev	Detail	By	Chk	Date

clarkebond
 MULTIDISCIPLINARY ENGINEERING CONSULTANTS
 The Cocoa House
 129 Cumberland Road
 Bristol BS1 6UY
 tel +44 (0) 117 929 2244
 fax +44 (0) 117 929 3095
 e-mail bristol@clarkebond.com
 web www.clarkebond.com
 Bristol Exeter London

Client
CRIBBS TRIANGLE LIMITED

Project
CRIBBS CAUSEWAY TRIANGLE

Drawing Title
VEHICLE TRACKING ARTICULATED VEHICLE

SHEET 3

Drawing Status
PLANNING

Project No.	Discipline	Drawing No.
B05581	C	252
Scale	Date	Revision
1:500	06.2021	A
Drawn	Checked	Sheet Size
MY	JP	A3

© This drawing may not be copied without prior written permission