

HELMINGHAM HALL
Suffolk

Proposed New Car Park Application

Appendix 3: Preliminary Drawings
and Computer Modelled Sketches,
April 2021

Hoare,
Ridge &
Morris

Architects





Block Plan as Existing with 19th Century Overlay of footpaths and tracks (Not to Scale - Refer to 182. SK05)



Preliminary Parking and Stables Area Proposals (Not to Scale - Refer to 182. SK06A)



Stable Yard Proposal

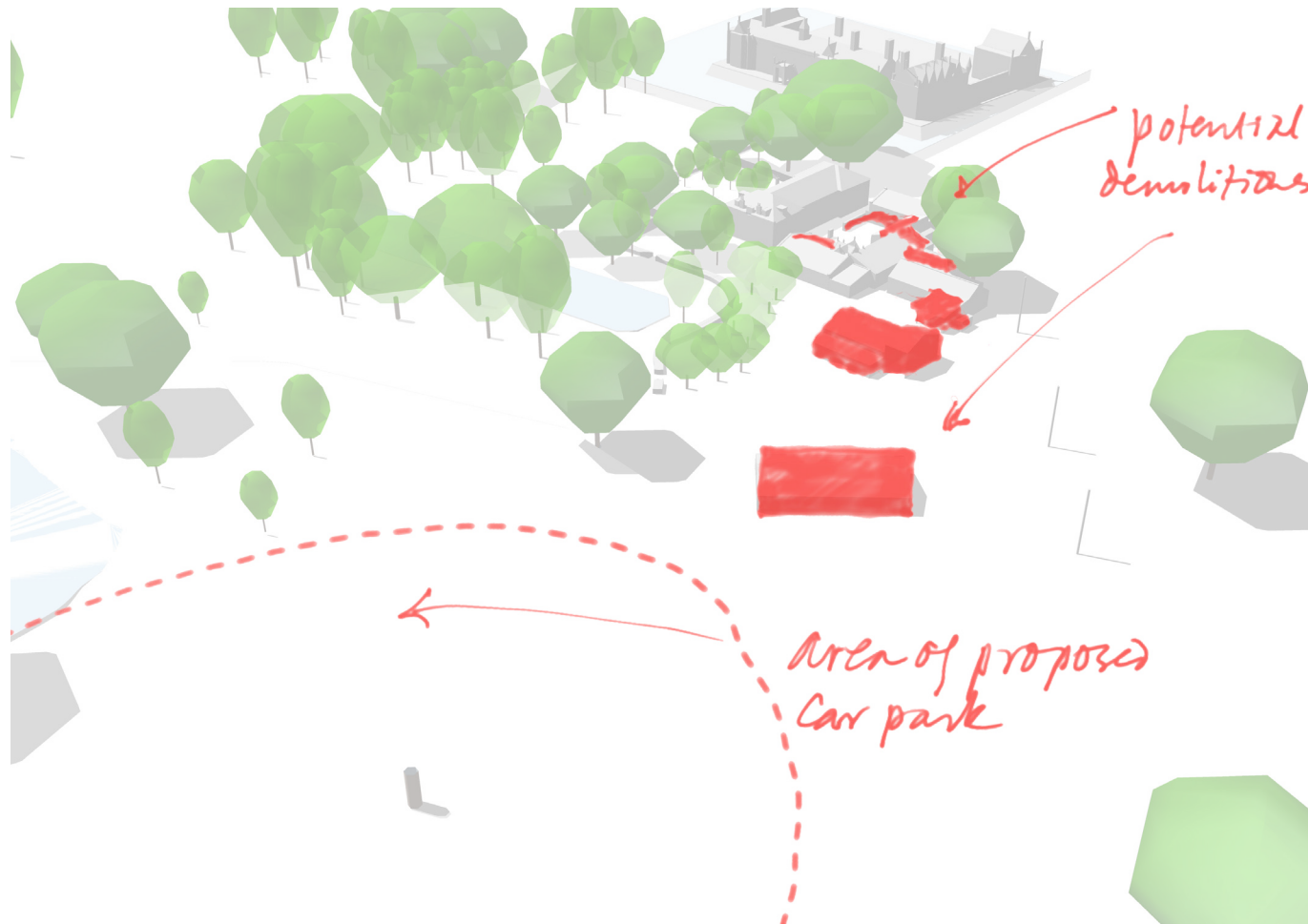

Aerial view from the North as existing indicating potential buildings for demolition

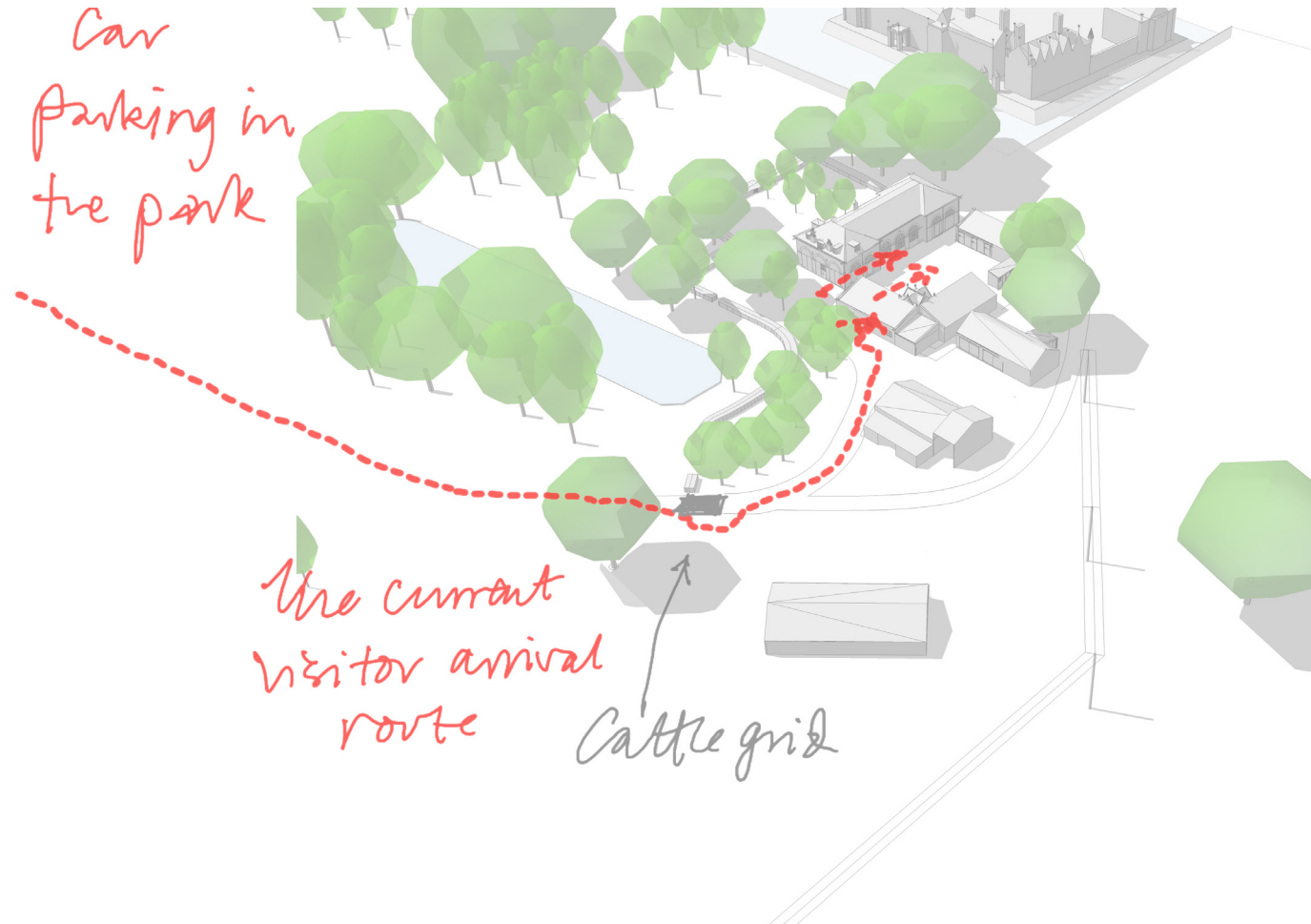

Aerial View from North-west as existing indicating the current visitor arrival route

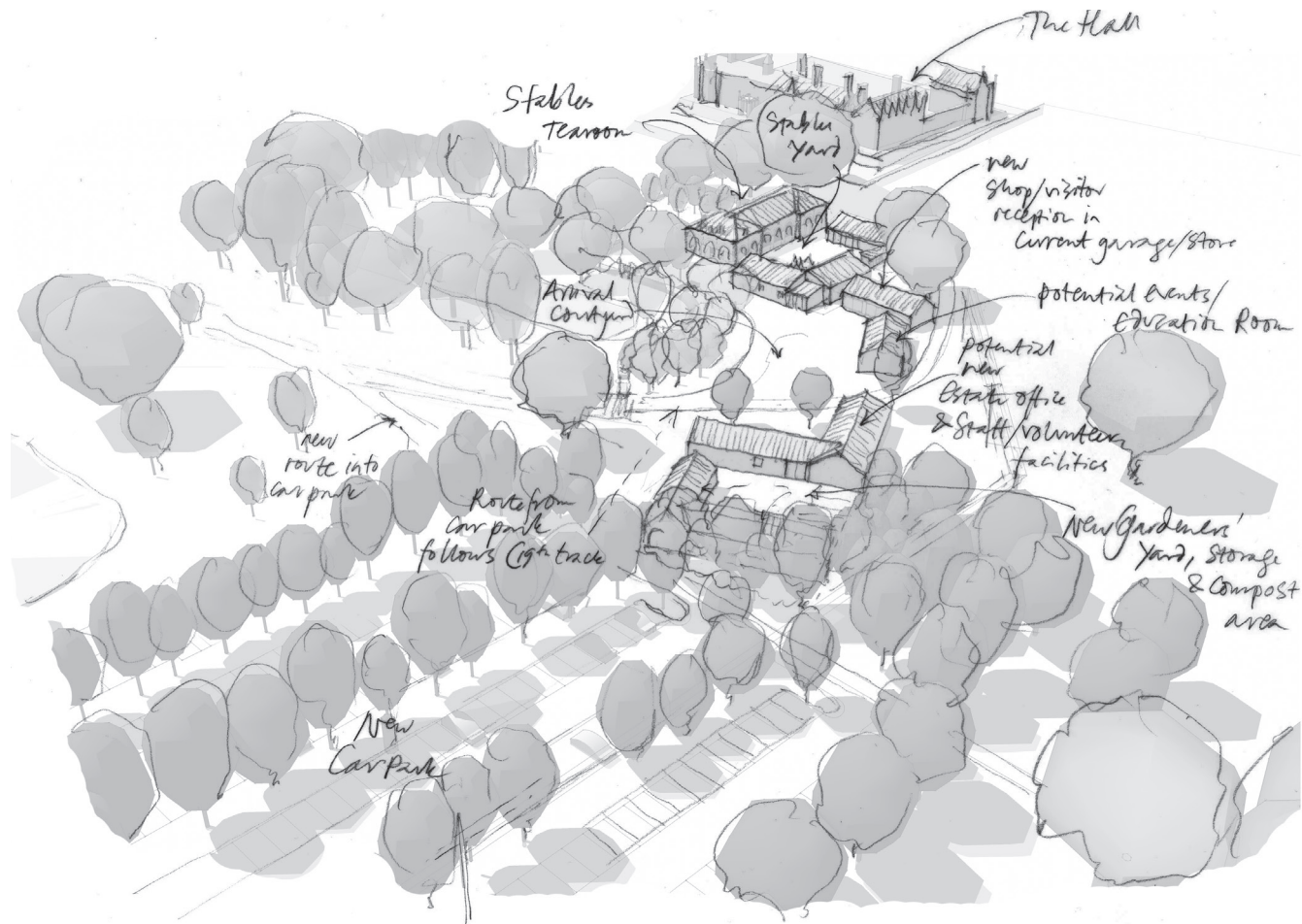

Aerial view from North as proposed indicating new planting, buildings and potential arrival route

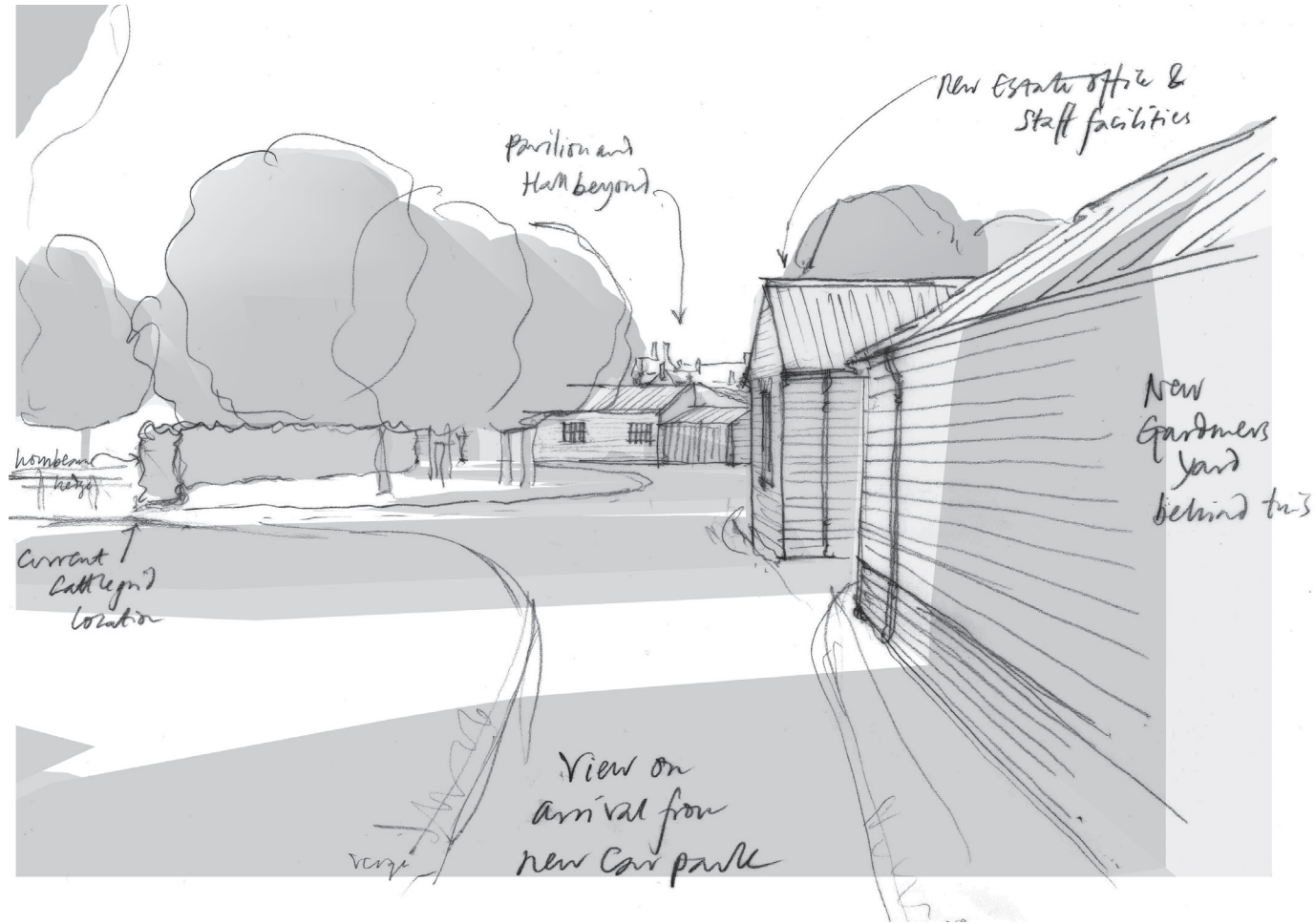

View of Building group on arrival from car park as proposed

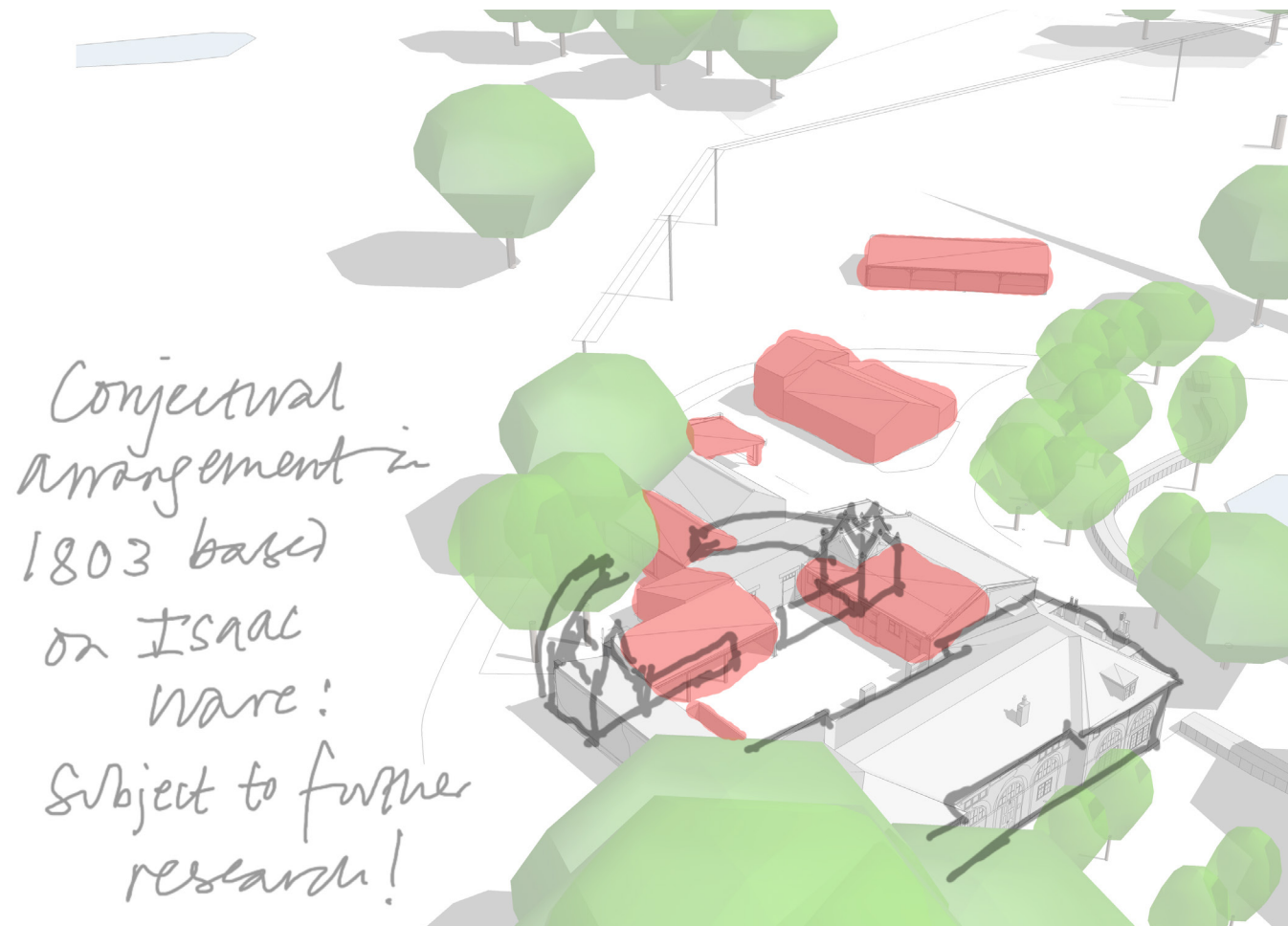

Aerial view from South as existing indicating potential demolitions, tree removals and with conjectural 1803 arrangement

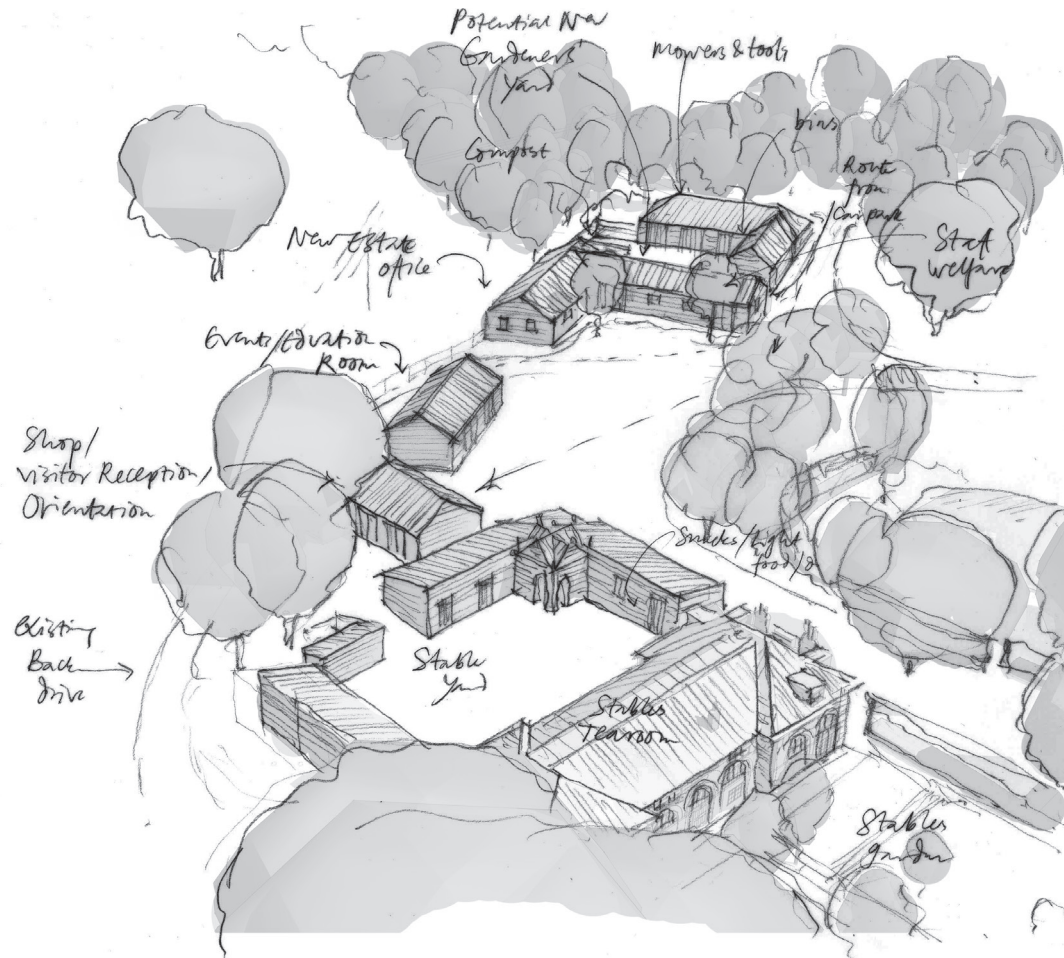

Aerial view from South-west as proposed indicating the new 'screened' car park with the potential new estate office and gardeners' yard

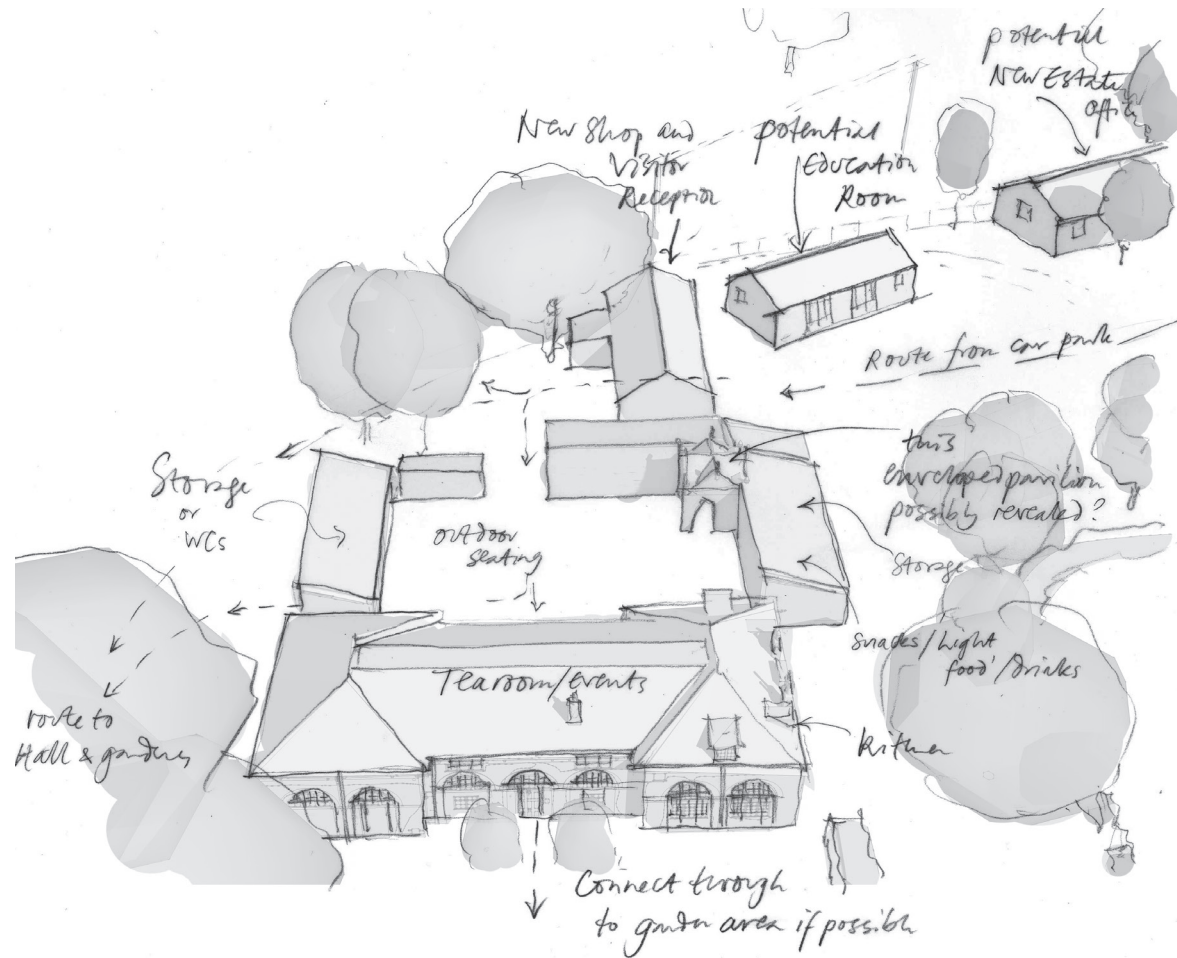

Aerial view from South as proposed indicating potential new buildings and usage