

# Dead and Dangerous Tree Notice Form



## Exception Works for Trees Subject to Tree Preservation Order or Within a Conservation Area

**Dead and Dangerous Tree Notice - If intending to carry out works that are an exception from the normal requirements to gain written consent the tree owner (or contractor on his/her behalf) are advised to provide at least 5 working days notice, in writing, to Cornwall Council's Planning Department before doing so.**

**Please read 'Dead and Dangerous Tree Notice' Advice Note**

### **Owners Contact Details:**

Name	MR. ROBERT MOODY
Address	3 COFFA BRIDGE CLOSE LOSTWITHIEL CORNWALL
Postcode	PL22 0EB.
Phone	[REDACTED]
email	[REDACTED]

**Details of Tree/s:**

Species	BLACK POPLAR [POPULUS NIGRA]
Age (eg young, middle aged, mature, veteran)	MATURE 20 YEARS +
Location	ON THE PROPERTY OF NO 3 COFFA BRIDGE CLOSE, LOSTWITHIEL OPPOSITE THE HOUSE.
Address or description	TREE PREVIOUSLY REFERED TO IN OUR APPLICATION NO PA16/ 01561 DATED 17TH FEB 2016.
Postcode	PL22 0EB
Grid ref	SX 10795 59660
Map	Please provide annotated plan if necessary

N.B. A Council officer must be able to find the tree(s) without difficulty in order to confirm that the works may proceed.

Please Sketch/Insert Plan Here:

(COPY)

COFFA BRIDGE CLOSE  
LOSTWITHIEL  
PL22 OEB

TREE "B" LIRIODENDRON

TREE "C"  
BLACK POPLAR.  
IN PROPERTY OF  
NO 3

TREE "A"  
COPPER BEECH

NORTH →

Under Construction  
For Sale

SITE PLAN

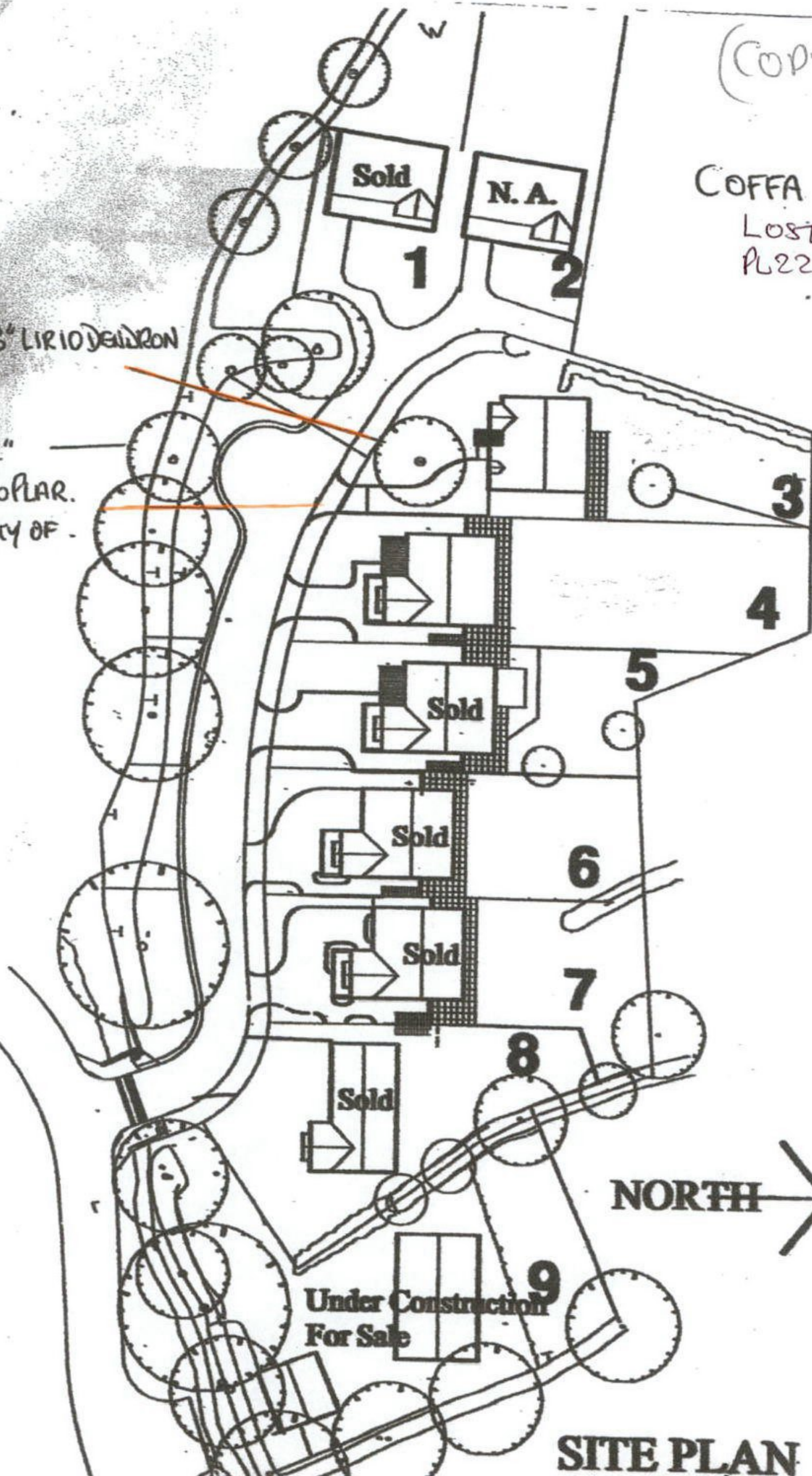

**Proposal:**

<p>Provide a detailed description of proposed works</p>	<p>TO COMPLETELY REMOVE THE DEAD TREE AND LEAVE ONLY A GROUND STUB.</p>
---	---

**Reason:**

<p>Describe why the works are an exception</p>	<p>DUE TO THE CONDITION OF THE TREE IT IS NOT KNOWN HOW STABLE THE TREE IS AT PRESENT. IN HIGH WINDS THE TREE COULD FALL BACKWARDS AWAY FROM THE PROPERTY [POSSIBLE DAMAGE TO OTHER PROPERTY] OR COULD FALL FORWARDS ONTO A PUBLIC RIGHT OF WAY.</p>
--	--

**Photographs:**

<p>Are you providing photos?</p> <p>Describe what photos show</p>	<p>✓ Y/N</p> <p>① TRUNK OF TREE</p> <p>② HIGHER PART OF TREE TRUNK SHOWING LOSS OF TREE BARK.</p> <p>③ BLACK FUNGAL GROWTH ON THE CIRCUMFERENCE OF THE TREE TRUNK AND AGAIN LOSS OF TREE BARK [WHICH IS COLLECTED AT THE BASE OF THE TREE]</p>
---	--

**Replacement Proposals:**

<p>Do you have a preference for replacement planting?</p> <p>Describe preferred replacement trees and reasoning</p>	<p>✓ Y/N</p> <p>COMMON HOLLY [ILEX AQUIFOLIUM]</p> <p>EVERGREEN PROVIDES GOOD ALL YEAR SCREENING.</p>
---	---

**Additional Comments:**

<p>Provide additional information here</p>	
--	--