

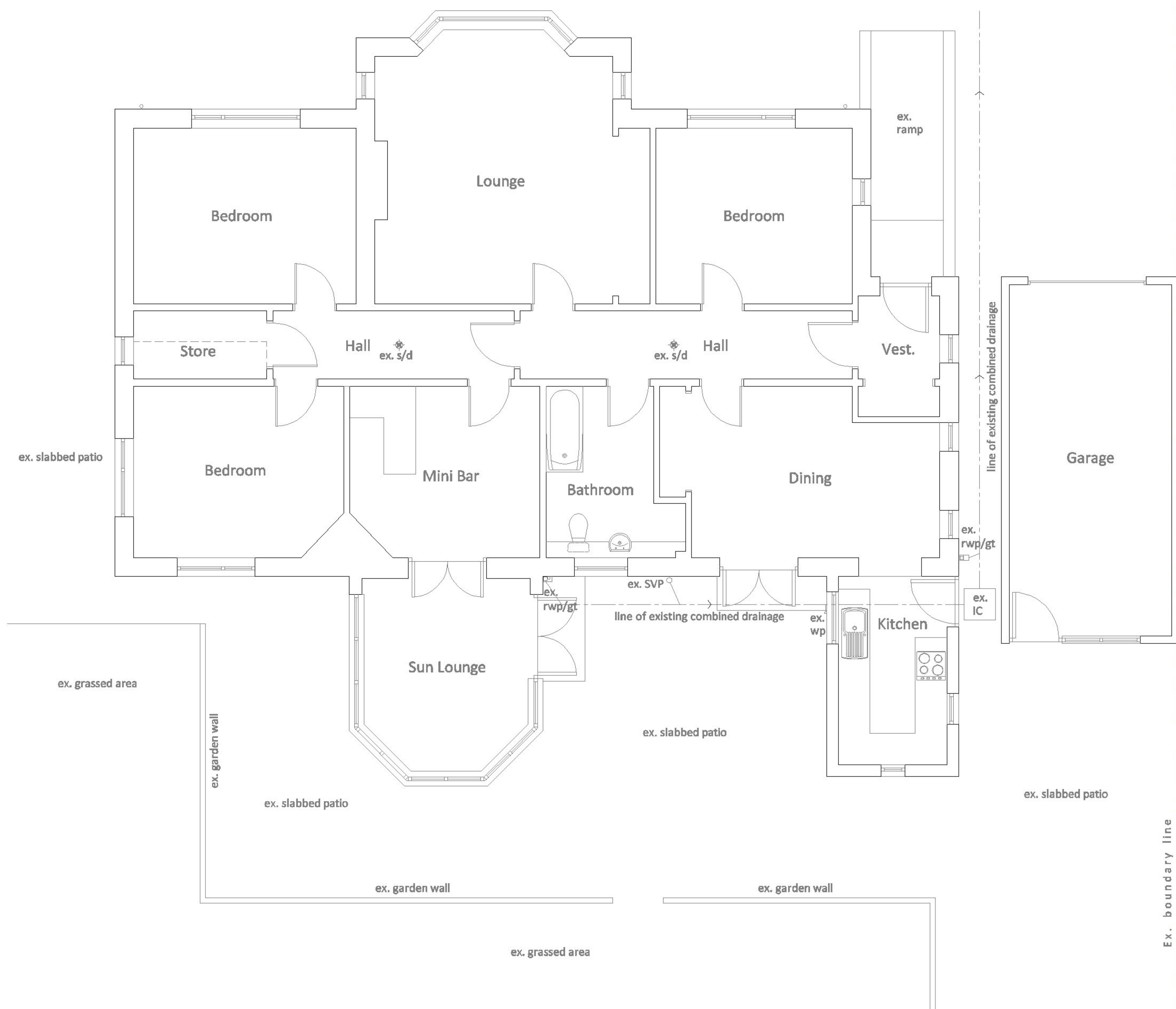

Existing North West Elevation (1:100)



Existing North East Elevation (1:100)



Existing South West Elevation (1:100)

GENERAL NOTES

ALL ELECTRICAL WORK TO BE CARRIED OUT IN STRICT ACCORDANCE WITH THE LATEST I.E.E REGULATIONS AND TO COMPLY WITH BS7671: 2008 'THE REQUIREMENTS FOR ELECTRICAL INSTALLATIONS'.

ANY DISCREPANCIES OR QUERIES REGARDING ANY PART OF THE WORKS TO BE DISCUSSED PRIOR TO ANY AFFECTED WORK BEING CARRIED OUT

WHILST THE HIGHLIGHTED AREAS ARE INDICATIONS OF SERVICES BELOW GROUND THERE MAY BE OTHERS OUT WITH, THEREFORE ALL EXCAVATIONS SHOULD INCORPORATE EXTREME CARE AND DILIGENCE

DRAWINGS TO BE READ AND UNDERSTOOD PRIOR TO WORK COMMENCING.FIGURED DIMENSIONS TO TAKE PREFERENCE OVER SCALED DIMENSIONS. ALL DIMENSIONS AND LEVELS TO BE CHECKED ON SITE. EXISTING DRAINAGE AND SERVICES POSITIONS TO BE CONFIRMED ON SITE.ANY DISCREPANCIES TO BE REPORTED BACK TO ARCHITECT.

CUSTOMER APPROVAL		
SURVEYOR		
SALES ADVISER		
SALES MANAGER		
APPROVAL	DATE	SIGNATURE

2	ISSUED FOR PLANNING & WARRANT APPROVAL	J.McRITCHIE		05/08/2021
1	ISSUED TO CUSTOMER FOR APPROVAL	J.McRITCHIE		28/07/2021
0	ISSUED TO SALES FOR APPROVAL	J.McRITCHIE		27/07/2021
No.	REVISION	DRAWN BY	CHECKED BY	DATE
CUSTOMER: MR & MRS STEPHEN 33 GORDON TERRACE DYCE ABERDEEN AB21 7BB				
PROJECT: PROPOSED REAR EXTENSION				
THISTLE CONTRACT NO:			37444	
 THISTLE HOUSE, WOODSIDE ROAD BRIDGE OF DON, ABERDEEN, AB23 8EF TEL: 01224 706555 WWW.THISTLEWINDOWS.COM				
DATE	JULY '21	DRAWING NO: 101		
SCALE	1:100			