

TIMBER AND SUBSTRATES TO BE CONSTRUCTED TO ACHIEVE SURFACE SPREAD OF FLAME PERFORMANCE COMPLIANT WITH:

- BS:476 PT 6&7 CLASS O
- EN 13501 EURO CLASS B

Substrates to comply with Euro Class B. Timber finish to be treated with Thermoguard base coat and varnish (or similar) to manufactures guidelines.

| SITE INFO | |
|-----------|-----|
| COVERS | N/A |
| FOH SQM | 20 |
| BOH SQM | 8 |

01. Existing WC sanitaryware to be fully retained.
02. Existing electrical cupboard to be retained.

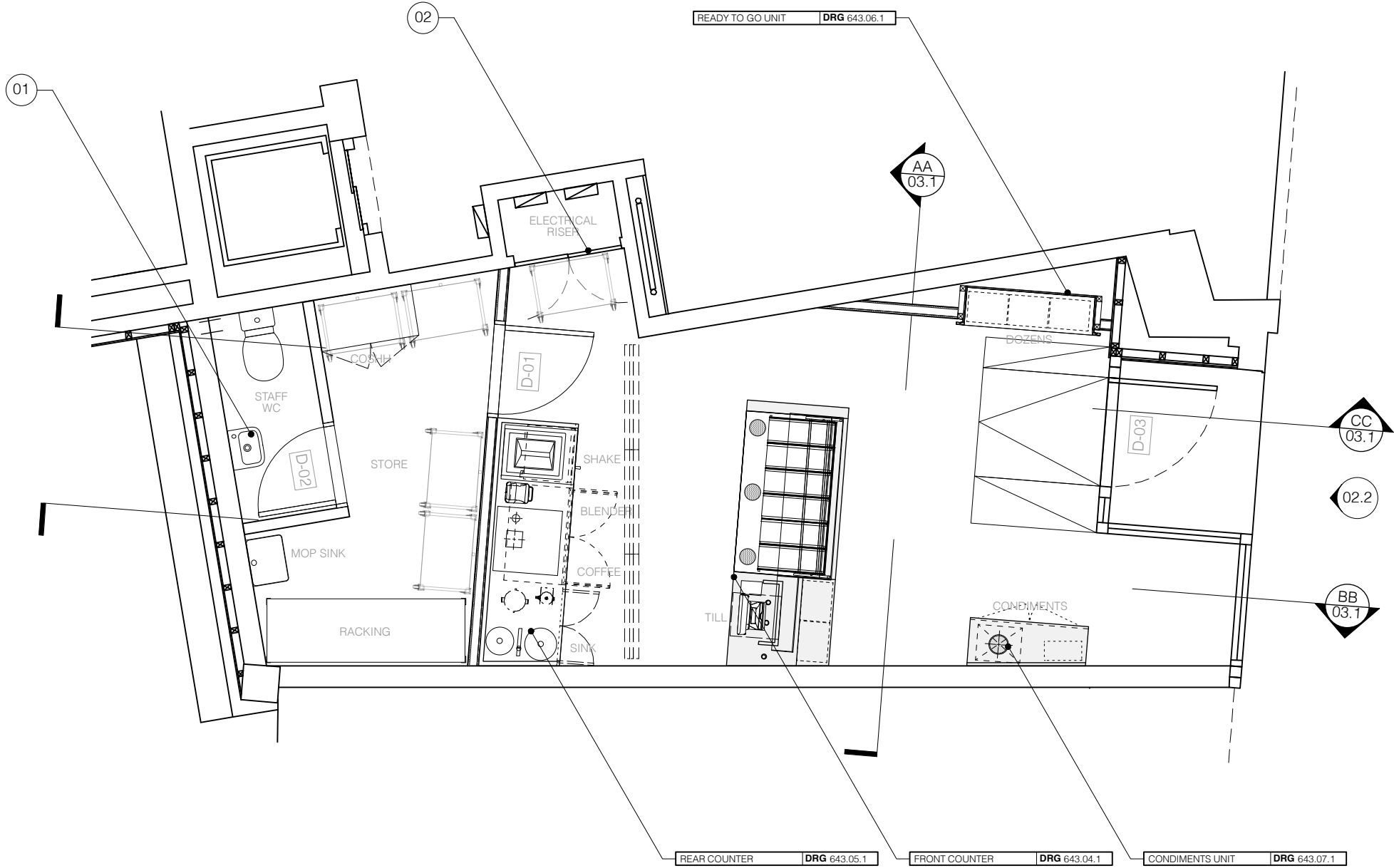

| Revision |
|----------|
| |
| |
| |
| |
| |
| |

DESCRIPTION
General Arrangement

CLIENT
Krispy Kreme

PROJECT
Borough High Street

ADDRESS
83 Borough High Street, London SE1 1NH

JOB No: DWG No: REV:

643.01.2 -

DATE: JUL 21 STATUS: INFORMATION

DRAWN BY: SJW

SCALE: 1:50 @ A3

Unit 5, 7 Wierlock Road, London N1 7SL
T +44 (0)20 7253 9005 F +44 (0)20 72539004
www.path-design.co.uk info@pathdesign.co.uk

THIS DRAWING IS FOR DESIGN INTENT PURPOSES ONLY. DO NOT SCALE THIS DRAWING.

• This drawing is based on information that it is not copied or disclosed to any other unauthorised person without the prior consent of PATH DESIGN.
• Dimensions should provide that they define the drawing for construction by PATH DESIGN.
• This drawing is the property of PATH DESIGN and copyright is reserved by them.
• All structural works are to be checked, confirmed and approved by structural engineer.
• All dimensions to be verified on site prior to work commencing.

Scale 1:50 @ A3

