

Station	Easting	Northing	Level
STN1	342435.568	439865.142	16.005
STN2	342383.687	439798.085	16.651
STN3	342467.951	439910.085	15.763
STN4	342340.710	439964.578	14.659
STN5	342486.261	439920.451	15.843

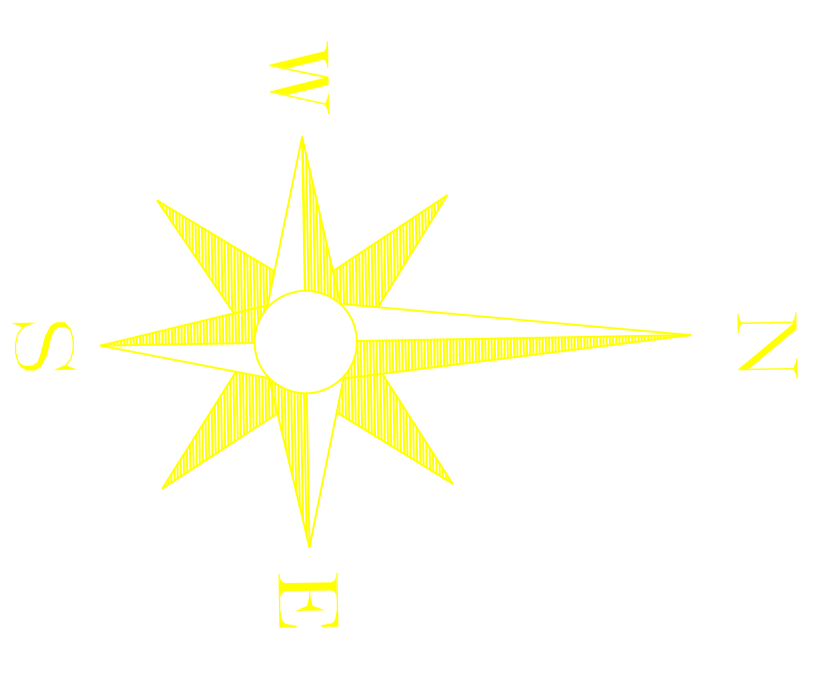
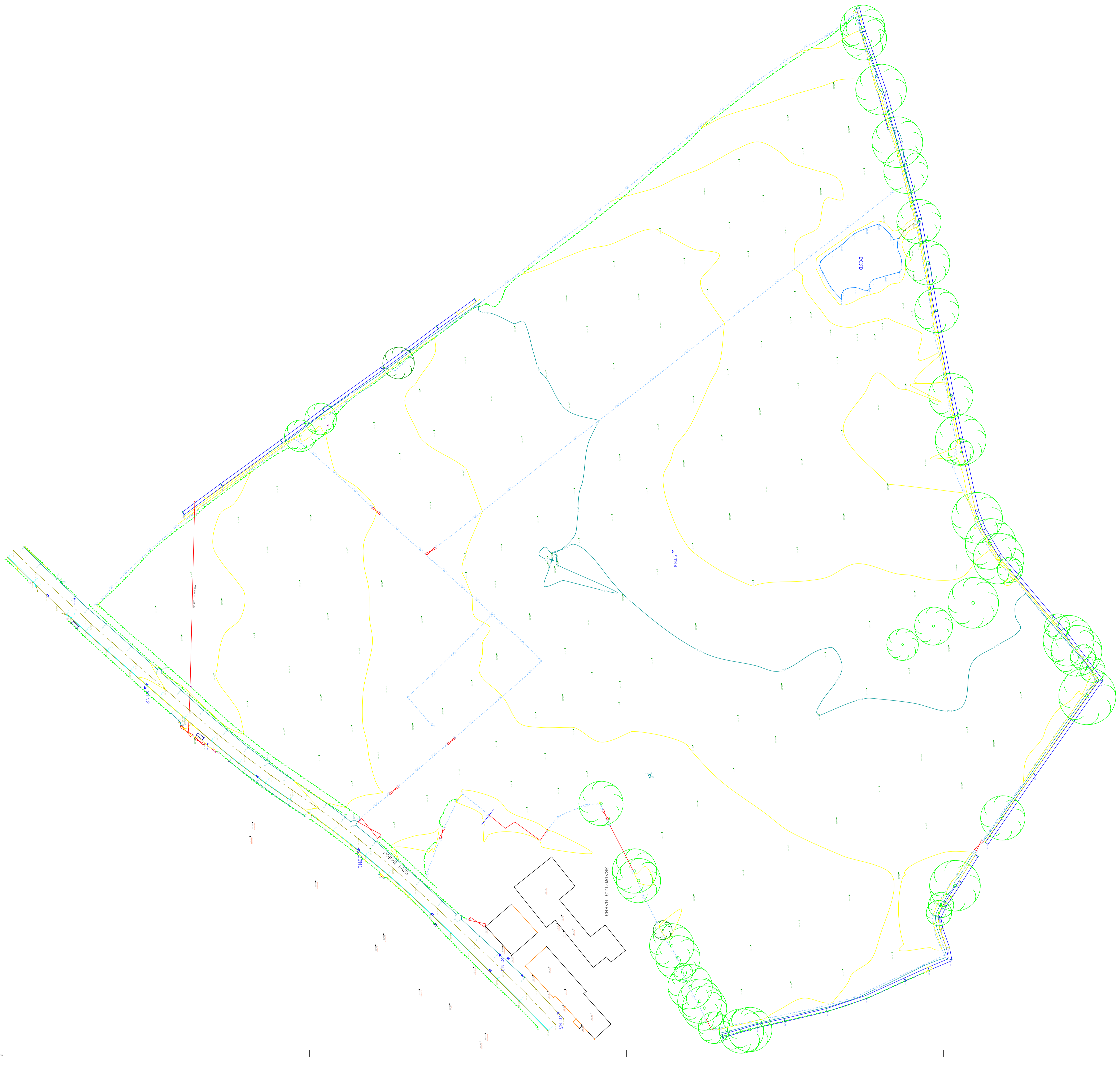

Symbol	Description	Scale
[Symbol]	Topography	1:500
[Symbol]	Proposed Road	1:500
[Symbol]	Proposed Lane	1:500
[Symbol]	Proposed Ridge	1:500
[Symbol]	Proposed Elevation	1:500
[Symbol]	Proposed Level	1:500
[Symbol]	Proposed Slope	1:500
[Symbol]	Proposed Gradient	1:500
[Symbol]	Proposed Angle	1:500
[Symbol]	Proposed Distance	1:500
[Symbol]	Proposed Area	1:500
[Symbol]	Proposed Volume	1:500
[Symbol]	Proposed Weight	1:500
[Symbol]	Proposed Length	1:500
[Symbol]	Proposed Width	1:500
[Symbol]	Proposed Height	1:500
[Symbol]	Proposed Depth	1:500
[Symbol]	Proposed Diameter	1:500
[Symbol]	Proposed Radius	1:500
[Symbol]	Proposed Circumference	1:500
[Symbol]	Proposed Area	1:500
[Symbol]	Proposed Volume	1:500
[Symbol]	Proposed Weight	1:500
[Symbol]	Proposed Length	1:500
[Symbol]	Proposed Width	1:500
[Symbol]	Proposed Height	1:500
[Symbol]	Proposed Depth	1:500
[Symbol]	Proposed Diameter	1:500
[Symbol]	Proposed Radius	1:500
[Symbol]	Proposed Circumference	1:500

NOTES
 THIS SURVEY HAS BEEN ORIENTATED TO THE ORDNANCE SURVEY (O.S.) NATIONAL GRID (OSGB36) VIA A GLOBAL POSITION SYSTEM (GPS) AND THE O.S ACTIVE NETWORK (SMARTNET).
 A TRUE OSGB36 ORDNATE HAS BEEN ESTABLISHED AROUND STN 1 AND STN 2 THE SURVEY HAS BEEN CORRELATED TO THESE 2 POINTS TO CREATE A TRUE O.S. BEARING FOR ANGLE ORIENTATION
 ONLY DRAINAGE VISIBLE AT TIME OF SURVEY HAS BEEN ADDED
 ALL DIMENSIONS SHOULD BE CHECKED ON SITE
 SURVEY UNITS ARE IN METERS
 SURVEY GRID = 50 METERS
 A EVES AND RIDGES HT ADDED 10/03/20

Rev	Description	Date
A	EVES AND RIDGES HT ADDED	10/03/20

PROPOSED DEVELOPMENT AT
 COPPS LANE GREAT ECCLESTON
 BAXTER HOMES

TOPOGRAPHICAL SURVEY

Drawn	G J Brookes
Date	FEB 2020
Scale	1:500@A1

EIA
 G. J. Brookes Limited
 LAND SURVEYORS & SITE ENGINEERS
 14, Lloyd Avenue
 Blonkwood
 Leicestershire
 LE14 4HL
 TEL: 01253 766135
 MOBILE: 079713 286006
 E-MAIL: gjb@brookesltd@hotmail.com

This drawing and all the information contained therein is subject to the written consent of G J Brookes Ltd. Any unauthorised reproduction infringes copyright and may lead to prosecution.

