

No.8

No.6

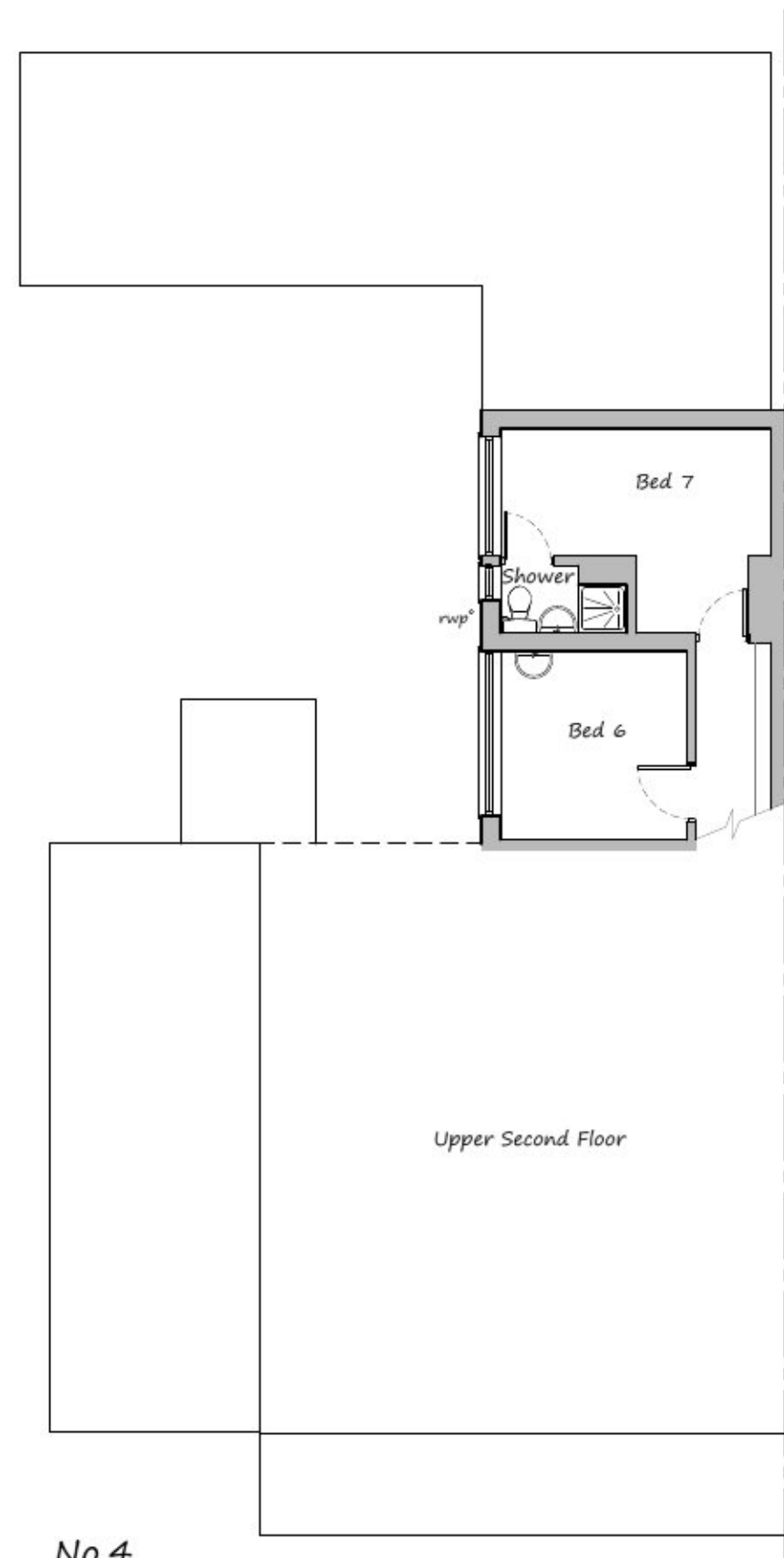

No.4

Upper Second Floor

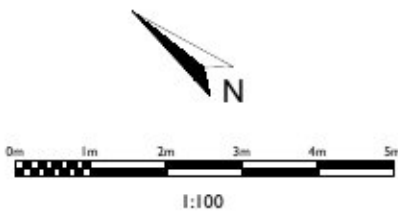

Ian Smillie Architectural Services
 75 Camden Road, Ipswich IP3 8JN
 telephone [REDACTED]
 Do not scale from this drawing
 - If in doubt ASK.

Lower Second Floor Plan As Existing
 Proposed conversion of buildings into self-contained studio
 apartments
 4, 6 & 8 Edith Road, Clacton-on-Sea, Essex
 for: ISSAM Limited
 scales 1:100 @ A3 drg. number 2020/21/17 rev. -