

TITLE:-

PROPOSED SINGLE STOREY REAR EXTENSION.

AT

12 PICKETLAW DRIVE
CARMUNNOCK
G76 9AA.

CLIENT:-

MR & MRS M. STEVEN,
ADDRESS AS ABOVE.

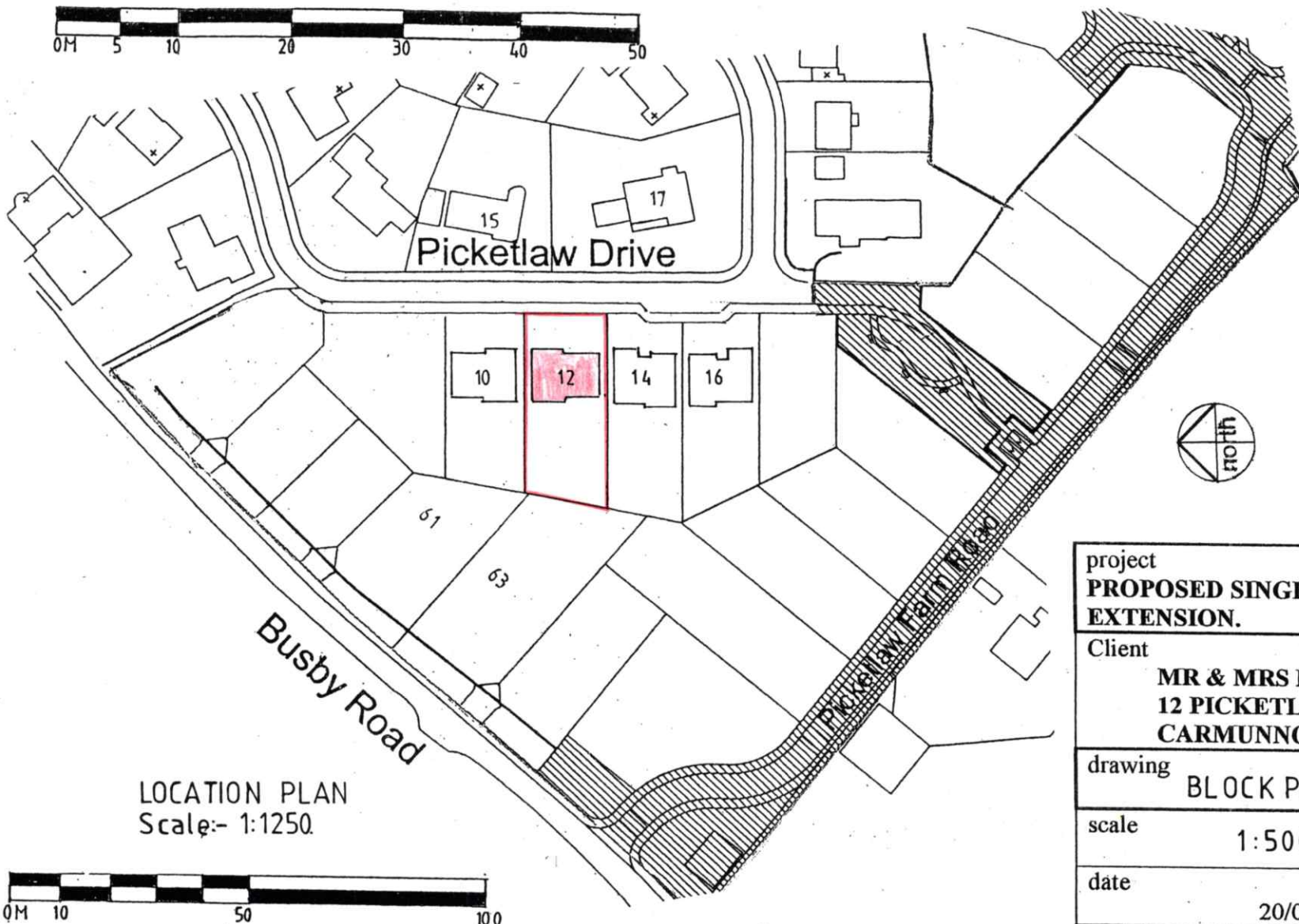
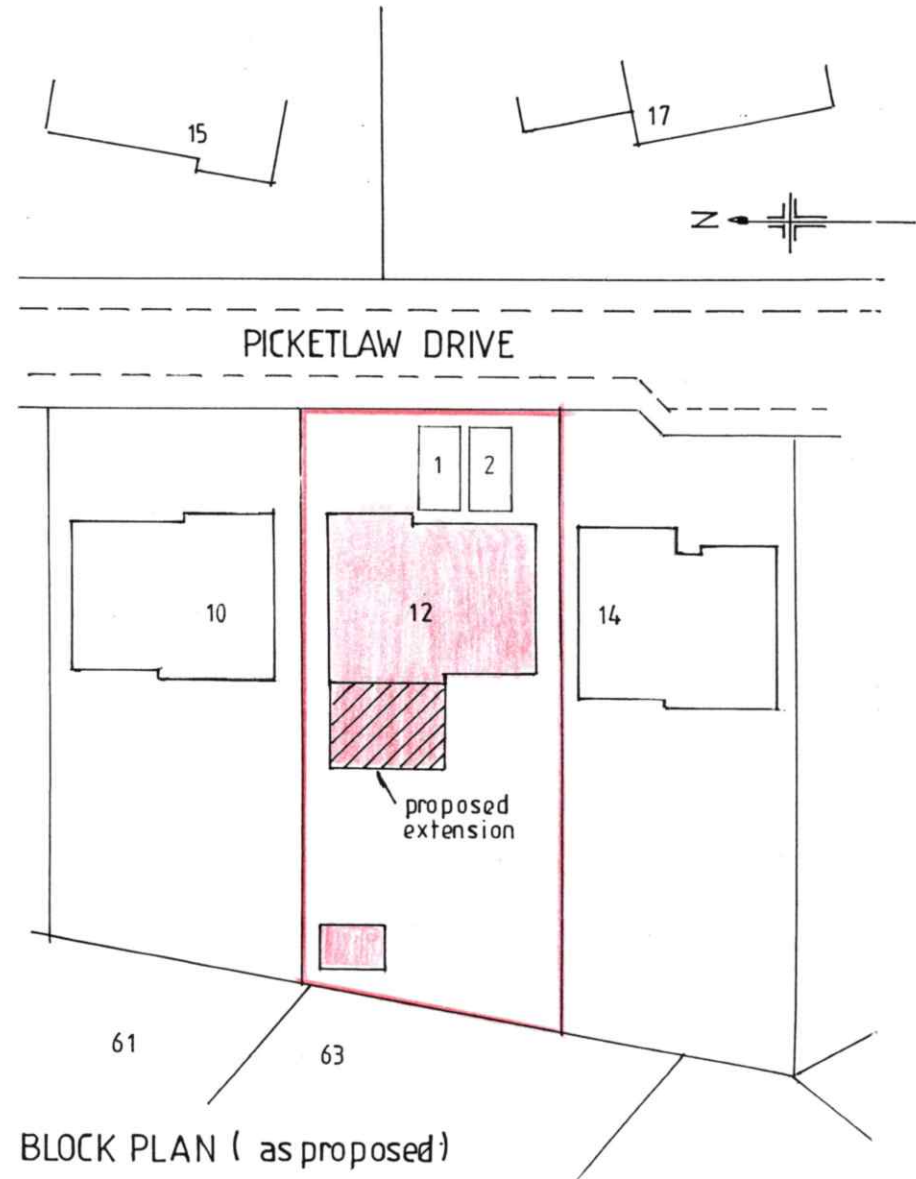
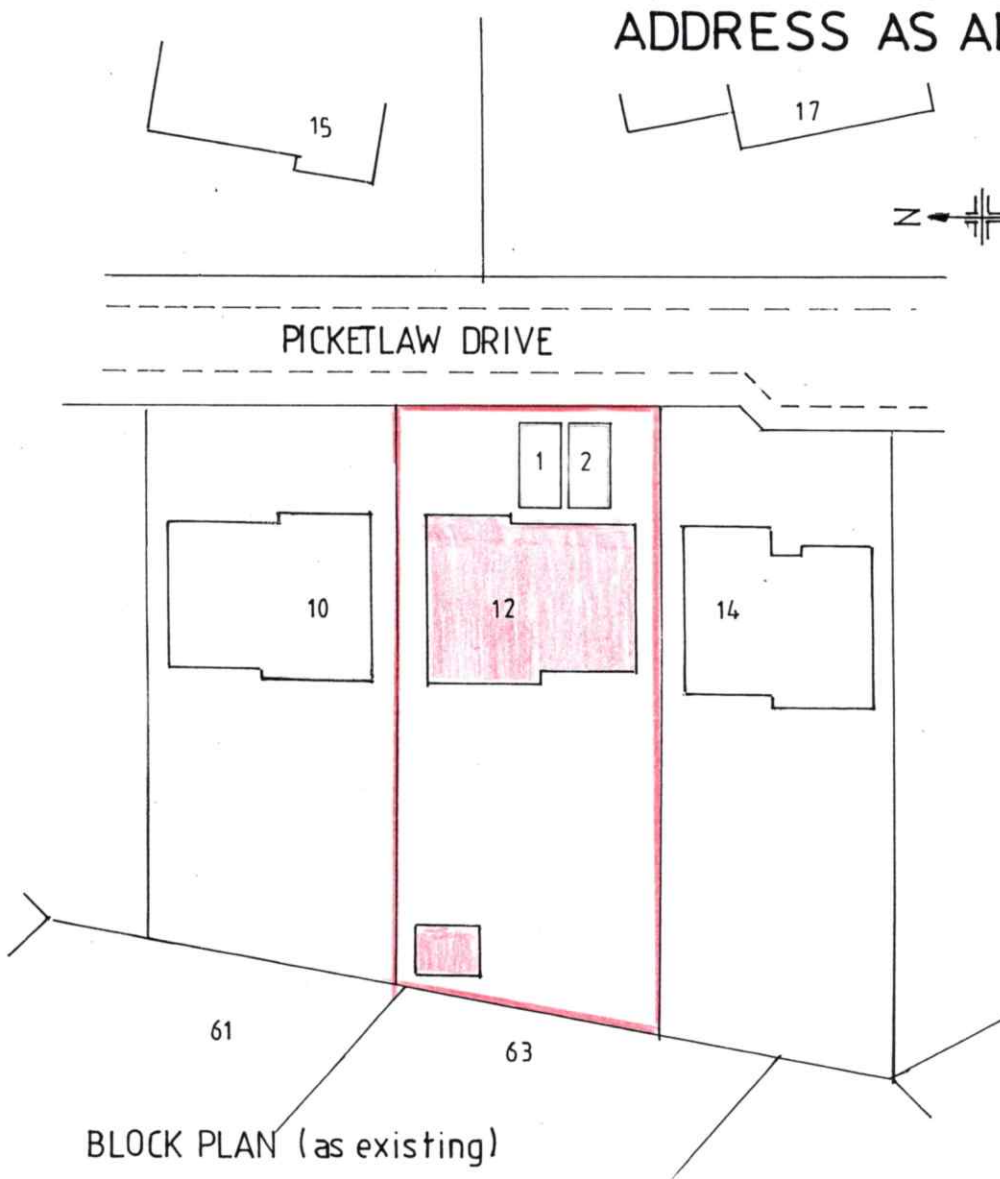

project	PROPOSED SINGLE STOREY REAR EXTENSION.
Client	MR & MRS M. STEVEN 12 PICKETLAW DRIVE CARMUNNOCK, G76 9AA
drawing	BLOCK PLAN / LOCATION PLAN
scale	1:500 , 1:1250
date	20/07/21
drg no.	3253/01