

WOODCOCK ROAD, FLAMBOROUGH

NOTES

THIS DRAWING IS BASED ON SURVEY DRAWING NO. 4652JA/1, PREPARED BY CT SURVEYS AND ORDNANCE SURVEY INFORMATION. IT IS SUBJECT TO CONFIRMATION OF BOUNDARIES / RIGHTS OF WAY / EASEMENTS AND CONSULTATION WITH THE LOCAL AUTHORITY, DESIGN TEAM AND PUBLIC UTILITIES, ETC.

- BOUNDARY
- PHASING BOUNDARIES- REFERENCE DRAWING NO. 1639-1010 - SITE PLAN - PHASING
- PUBLIC FOOTPATH TO BE MAINTAINED
- ROAD TO FORMED TO WEARING COURSE TO SERVICE THE SALES CENTRE / SHOWHOUSES
- TEMPORARY ROAD TO SITE COMPOUND, UNTIL PHASE 3 IS UNDERTAKEN
- SHOWHOUSES / SALES CENTRE
- WHEEL WASH STATION

DELIVERY HOURS

MON - FRI 7.30AM TO 5.00PM
SAT 8.00AM TO 2.00PM

NB COVID CONSTRUCTION WORKING HOURS TO APPLY AS DIRECTED BY THE GOVERNMENT.

PROPOSED NEW SOFT LANDSCAPING TO BE UNDERTAKEN WHEN THE HOUSES ARE COMPLETED AND THE SECURITY FENCING HAS BEEN REMOVED.

SECURITY FENCE TO THE SIDE OF THE RETAINED FOOTPATH, ALL AS SHOWN.

EXISTING HEDGES TO BE RETAINED AND PROTECTED DURING ALL CONSTRUCTION WORK.

EXISTING HEDGES TO BE RETAINED AND PROTECTED DURING ALL CONSTRUCTION WORK.

PROPOSED NEW SOFT LANDSCAPING TO BE UNDERTAKEN WHEN THE HOUSES ARE COMPLETED AND THE SECURITY FENCING HAS BEEN REMOVED.

WHEEL WASH STATION

NO PARKING NOTICES TO GRASS VERGE.

SITE ACCESS WITH WARNING SIGN ON FENCE.

EXISTING HEDGES TO BE RETAINED AND PROTECTED DURING ALL CONSTRUCTION WORK.

SECURITY FENCE TO THE FULL SITE BOUNDARY - SET BACK FROM THE RETAINED HEDGERS (IN LINE WITH THE LANDSCAPE ARCHITECTS ADVICE), EXISTING SITE BOUNDARIES THAT ARE TO BE RETAINED AND PROPOSED LANDSCAPED BUFFER, ALL AS SHOWN.

EXISTING HEDGES TO BE RETAINED AND PROTECTED DURING ALL CONSTRUCTION WORK.

EXISTING HEDGES TO BE RETAINED AND PROTECTED DURING ALL CONSTRUCTION WORK.

SECURITY FENCE TO THE FULL SITE BOUNDARY - SET BACK FROM THE RETAINED HEDGERS (IN LINE WITH THE LANDSCAPE ARCHITECTS ADVICE), EXISTING SITE BOUNDARIES THAT ARE TO BE RETAINED AND PROPOSED LANDSCAPED BUFFER, ALL AS SHOWN.

SECURITY FENCE TO THE FULL SITE BOUNDARY - SET BACK FROM THE RETAINED HEDGERS (IN LINE WITH THE LANDSCAPE ARCHITECTS ADVICE), EXISTING SITE BOUNDARIES THAT ARE TO BE RETAINED AND PROPOSED LANDSCAPED BUFFER, ALL AS SHOWN.

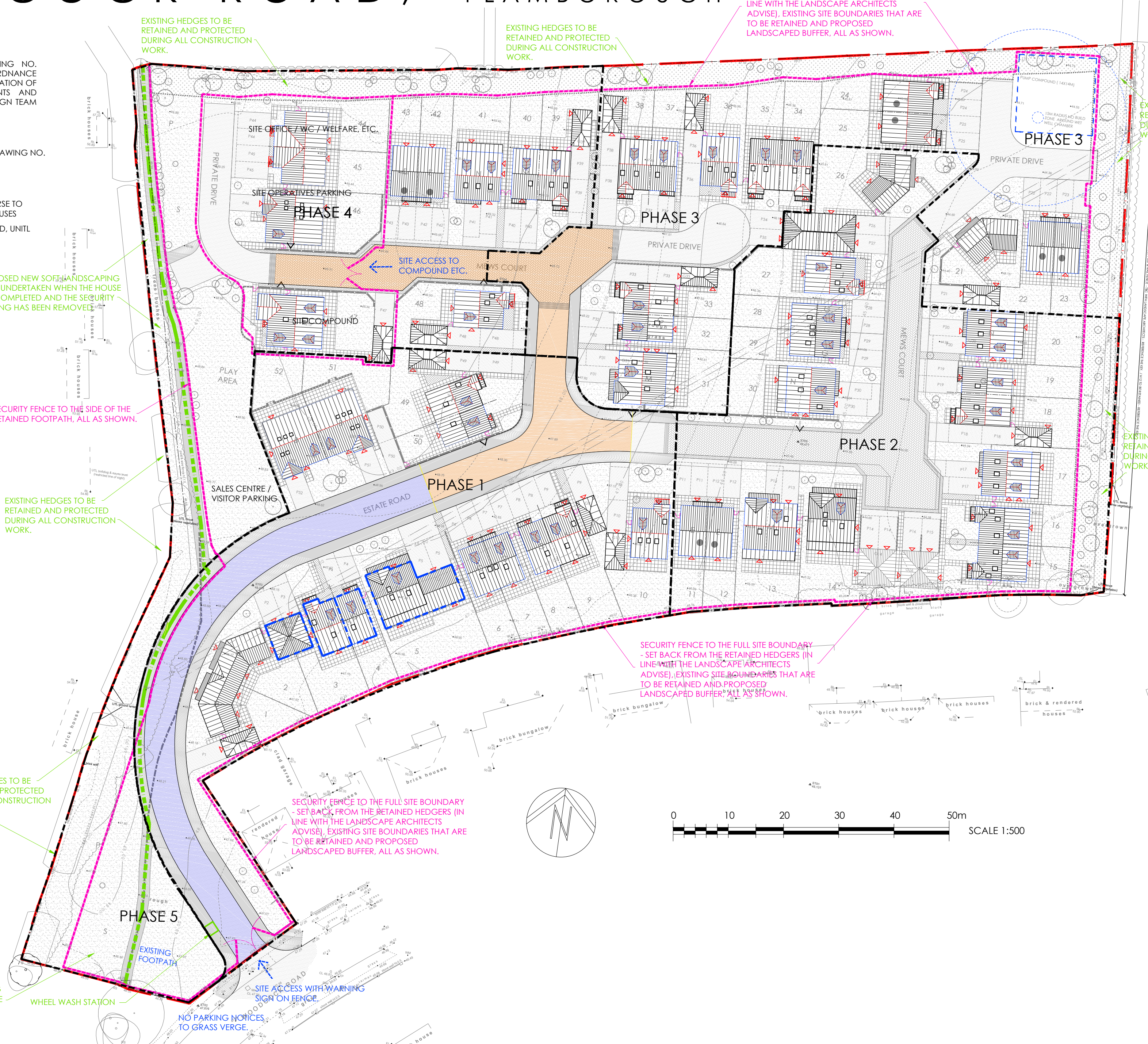

NOTES
ALL WORK TO BE CARRIED OUT IN ACCORDANCE WITH THE BUILDING REGULATIONS AND THE REQUIREMENTS OF THE LOCAL AUTHORITY.

D	UPDATES AS PER ERYC VALIDATION LATTER DATED THE 10TH AUGUSTS 2021.	BC	11.08.21
C	UPDATES AS PER ERYC VALIDATION LATTER DATED THE 4TH AUGUSTS 2021.	BC	09.08.21
B	UPDATED UNIT PLOT TO SUITE LATEST PLANNING DRAWINGS	BC	02.08.21
A	UPDATED SHOWING LATEST SITE LAYOUT	BC	03.06.21

LOROC ARCHITECTS
25A PARK SQUARE WEST, LEEDS, LS1 2PW
T: 0113 253 7755
W: www.loroc.co.uk

3RD FLOOR, 86-90 PAUL STREET, LONDON, EC2A 4NE
T: 0203 975 5333

CLIENT	VALANT HOMES		
PROJECT	WOODCOCK ROAD, FLAMBOROUGH		
TITLE	SITE PLAN - SITE SET UP		
DRAWING NO.	1639-103	REVISION	D
SCALE	1:500 @ A2	DATE	APR 2021
DRAWN BY	JC	CHECKED BY	-

- PURPOSE OF ISSUE
- PLANNING
 - BUILDING REGS
 - TENDER
 - COMMENT
 - INFORMATION
 - CONSTRUCTION

THIS DRAWING IS COPYRIGHT AND THE INTELLECTUAL PROPERTY OF LOROC ARCHITECTS LIMITED. THIS DRAWING MAY NOT BE REPRODUCED BY WHOLE OR IN PART WITHOUT WRITTEN AUTHORITY. NO DIMENSIONS TO BE SCALED FROM THIS DRAWING. ALL DIMENSIONS TO BE CHECKED ON SITE PRIOR TO COMMENCEMENT OF WORKS AND ANY DISCREPANCIES REPORTED TO THE ARCHITECT/ENGINEER/CONTRACTOR.